

LEFEET C1 遥控器

使用说明书

产品清单

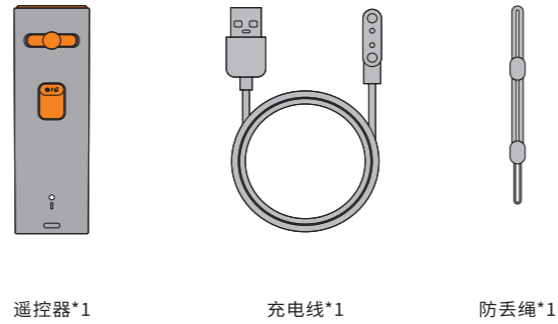

产品图示



1

充电

请用5V/1A电源适配器或标准USB口充电器进行充电（不提供）。
- 将提供的充电线磁吸口对准遥控器充电口，并确保吸附上后，另一端插入USB充电端口，充电时指示灯闪烁。
- 当充满电时，指示灯变绿色，这时应断开连接。

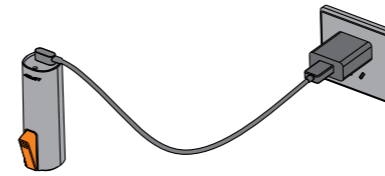

电量指示灯：
绿灯电量约为100%-60%，
黄灯电量约为60%-20%，
红灯电量约为20%，
红灯闪烁表示电量低请立刻充电。

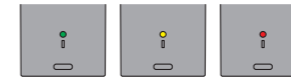

配对

遥控器使用前需先与主机配对。
将遥控器靠近主机20cm内。旋转主旋钮5"至白灯闪烁，松开。向下按压遥控器开关机键5"至白灯闪烁，松开。此时遥控器与主机开始自动配对。主机灯停止闪烁表示配对成功，向下按压遥控器开关机键，退出配对模式。

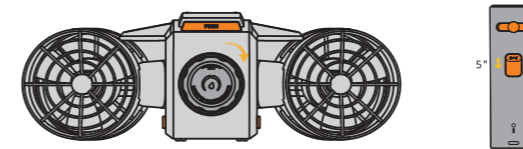

2

操作遥控器

开关机及切换档位
- 向下拨动开关机键并保持2"，开机及关机
- 向下拨动开关机键并迅速松手，切换档位

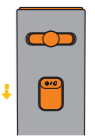

前进
- 捏住动力扳机，推进器启动，前进

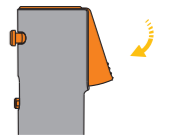

转向
- 捏住动力扳机，拨动转向拨钮时，主机在前进中向左或向右转向
- 松开扳机，拨动转向拨钮时，主机主机原地向左或向右旋转

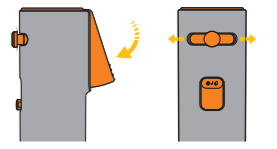

*遥控器15分钟没有任何操作时会自动关机。
*遥控器仅用于C1主机安装在充气浮力配件时控制C1主机，如C1主机与控制手柄或浮板安装时，遥控器无法控制C1主机。

3

遥控器规格

重量	~112g
尺寸	38*56*120mm
工作温度	0-40°C
防水等级	IP54
充电电压	5V
使用时长	6H

维护

- 不要将本产品长时间浸泡在水中。
- 使用后用清水冲洗并用柔软清洁的干布擦干。
- 充电时请保持充电口干燥。
- 将机身放在阴凉通风处完全晾干。

存放

- 不要将遥控器在高温低温、过于干燥潮湿、阳光直晒、尘土飞扬等环境中存放，恶劣的环境会对电子设备造成损坏。
- 在存放遥控器之前，请将电池充满电，防止电池因不使用而过度放电。
- 如果长期不使用，则每三个月对遥控器进行一次充电。
- 存放温度不得超过 0° C ~ 40° C 的范围。

设备处理

- 本产品不得焚烧、填埋或与家庭垃圾混合处理。不当处置本产品所含电池，可能导致电池发热、断裂或起火，造成严重伤害。电池内的物质对环境构成化学风险。建议在使用寿命结束时，对产品进行电子垃圾或有害垃圾回收。
- 有关锂离子电池 / 含有锂离子电池的产品的回收和处置的地方法规和法律将根据国家和地方政府的不同而有所不同。您必须检查您所居住地方相对应的法律法规，以便正确处理产品电池电芯。用户有责任按照当地法规和法律妥善处理其废弃物设备。
- 如发现电池正负极进水，请立刻将电池放于安全位置，不要充电并联系经销商。
- 如需更多有关电池、电器或电子废物应放在何处的资料，请联络本地或区域废物管理办事处、家居废物处理服务或销售点。

4

安全警示

LEFEET产品的设计考虑到了用户的安全最大化。然而与任何电子运动产品一样，LEFEET产品的使用也会有一定的风险(例如:失控)。因此，阅读和遵守《使用说明书》中的所有指示和警告，并在使用时做出良好的判断是非常重要的。我们将使用LEFEET产品的行为视为用户承认并接受使用时所产生的所有相关风险和责任，这些风险包括但不限于肌肉损伤、骨折、撕裂或其它严重伤害。使用LEFEET产品需自行承担风险。由于缺乏常识而发生的意外事故，一律概不负责。14岁以下儿童请在家长或有其他成年人监护的情况下才可以。为了更好地确保您的安全，请阅读并遵循《使用说明书》中的所有指示和警告。

干扰声明

该设备已被测试并发现符合B类数字设备的限制。这些限制旨在提供对住宅设施中的有害干扰的合理保护。该设备可以产生、使用和可以辐射射频能量，如果不按照说明安装和使用，可能会对无线电通信造成有害的干扰。但是，并不能保证在特定的安装中不会发生干扰。如果该设备确实对无线电或电视接收造成有害干扰，可通过关闭设备确定，鼓励用户采取以下措施之一纠正干扰：重新定位或重新定位接收天线。增加设备与接收器之间的距离。将设备连接到与接收器连接电路不同的电路上的出口。请咨询经销商或有经验的无线电/电视技术人员以寻求帮助。

责任限制

LEFEET朗非创新仅在下列情况下对产品的丢失或损坏负责：产品已为LEFEET朗非创新所拥有；或产品在LEFEET朗非创新运输的途中。对于以下情况，无论本文规定的任何救济是否达到其根本目的，也不论索赔是基于合同、担保、疏忽，严格责任或其它责任理论，LEFEET朗非创新及其关联企业、供应商、经销商或服务供应商概不负责：
1) 第三方向您提出损害赔偿；
2) 特别的、附带的、间接的或继发的损害，包括但不限于利润、业务收入、商誉或预期可节省金额等方面的损失。无论损害基于任何原因，LEFEET朗非创新及其关联企业、供应商、经销商或服务供应商的全部责任仅限于您实际遭受的直接损失，并且不高于您购买产品付出的金额。

5

维修服务:

尊敬的客户，LEFEET朗非创新保证，您购买的LEFEET产品均按照合格的标准进行设计和制造，在正常使用情况下，在保修期内没有功能缺陷。如果您在使用过程中遇到任何困难，建议您先查阅产品的用户手册，您也可以在我们的网站上下载到用户手册、常见问题解答、教学视频或支持论坛。

服务范围

您的LEFEET产品包含为期一年的硬件维修服务。本产品的保修期从销售发票开具当日算起，主机保修期限为12个月，主机电池保修期限为6个月。若您无法提供购买发票等有效证据，则保修起始日期以机器所示的生产日期向后顺延90个自然日或由LEFEET朗非创新另行规定。如果维修不可行或者商业上不可行。我们可能会使用具有类似功能的新产品或者翻新产品来替换此产品。在维修固件升级或者更换后，更换的产品或配件在原产品剩余的保修期内享有同等的维修服务。

如何获得售后服务

在保修期间，若产品不能实现所保证的功能，请联系客服邮箱：service@lefeet.com以获取相应的售后服务。LEFEET朗非创新可能在某些地区不提供售后服务，售后服务政策的内容也可能因地而异。常规服务范围外的服务可能需要另行收费。如欲了解本地信息，请联系LEFEET朗非创新客服。

获得售后服务的准备工作

联系LEFEET朗非创新后，请详细说明产品存在的问题。LEFEET朗非创新技术支持人员将尝试通过电话、电子邮件或远程协助来诊断和解决您的问题。如果通过电话无法解决您的问题，您需将产品寄回LEFEET朗非创新进行进一步检测。LEFEET朗非创新会按产品享有的保修服务安排维修。

更换产品和部件

如果维修服务涉及更换产品或部件，那么被更换的产品或部件将成为LEFEET朗非创新的财产，而换的产品或部件将成为您的财产。只有未经改动的产品和部件方可进行更换。LEFEET朗非创新提供的更换产品或部件可能不是全新的，但它们肯定处于良好的工作状态，至少在性能上与被更换件等同。更换的产品或配件在原产品剩余的保修期内享有同等的维修服务。

6

个人联系信息的使用

如果您根据本保修条款获取服务，即表示您授权LEFEET朗非创新存储、使用和处理您的联系信息，包括姓名、电话号码、地址和电子邮件地址等。LEFEET朗非创新可利用这些信息开展本政策项下的服务。我们可能会联系您，询问您对我们的保修服务是否满意，或就任何产品召回或安全问题向您发出通知。为实现上述目标，您授权LEFEET朗非创新将您的信息转移到我们开展业务的任何国家或地区，并可以将其提供给我们代表机构。如果法律要求，我们也可以披露这些信息。

非售后政策保障范围

本政策不包括或者不适用以下情况：
发生人为的非产品本身质量问题导致的碰撞、烧毁事故；
发生非官方说明书指导的私自改装、拆解、开壳等行为而造成的损坏；
未按说明书指导的不正确安装、使用及操作所造成的损坏；
在无官方说明指导下，客户自行维修或者请未经官方授权的服务机构维修/修改部件导致的损坏；
因非官方说明书指导的电路改造或电池组、充电器的匹配使用不当导致的损坏；
滥用产品或者在不符合产品用户手册中环境条件下操控导致的损坏；
由于连接用户手册推荐产品之外的外设、附加设备或者附件造成的损坏；
在电量不足时或使用存在质量问题的电池导致放电不足而产生的损坏；
装置已经损坏，包括但不限于由于动物、雷电、异常电压、火灾、自然灾害、运输造成的损坏；
改动或撕下识别标签的产品或部件导致产品上的型号、序列号、或者生产日期已涂改、去除或者无法被辨认；
产品因未在最初设计、制造或者批准使用的国家/地区使用而无法正常工作。

可以通过www.lefeet.com获得您购买的LEFEET产品的更多使用方式。

7

LEFEET C1 REMOTE CONTROLLER

User manual

WHAT'S IN THE BOX

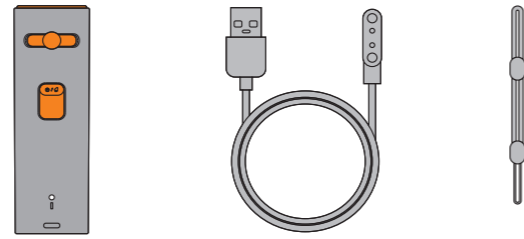

Remote Controller*1 Charging Cable*1 Anti-loss Strap*1

PRODUCT DIAGRAM

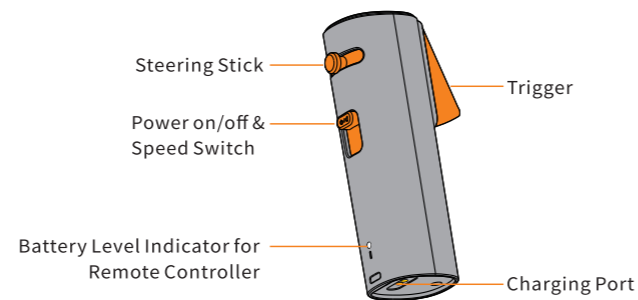

1

CHARGING

Please use a 5V/1A power adapter or a standard USB port charger (not provided) to charge the remote controller.

- Align the magnetic suction port of the provided charging cable with the charging port of the remote controller, and ensure that it is attached. Insert the other end into a USB charging port, and the indicator light will flash during charging.
- When the remote controller is fully charged, the indicator light will turn green. At this point, disconnect the charger.

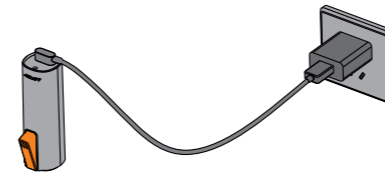

Battery level indicator:

- Green light indicates battery level is approximately 100%-60%,
- Yellow light indicates battery level is approximately 60%-20%,
- Red light indicates battery level is approximately 20% or lower, Flashing red light indicates low battery level and immediate charging is required.



* The remote controller will automatically power off after 15 minutes of inactivity.
* The remote controller is only used to control the C1 main unit when it is installed on an inflatable buoyancy aid. When the C1 main unit is installed with a control handle or a floating board, the remote controller cannot control the C1 main unit.

2

PAIRING

Before using the remote controller, it needs to be paired with the main unit. Place the remote controller within 10cm of the main unit. Rotate the main knob on C1 clockwise to the end and hold for 5 seconds until the white light flashes, then release. Slide down and hold the power button on the remote controller for 5 seconds until the white light flashes, then release. At this point, the remote controller and the main unit will start pairing automatically. When the main unit's light stops flashing, it means that the pairing is successful. Press the power button on the remote controller to exit the pairing mode.

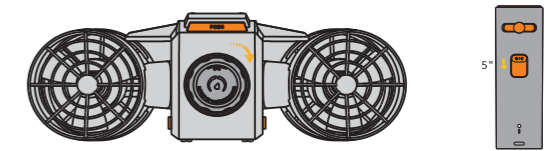

OPERATING THE REMOTE CONTROL

Power on/off and Gear Shift

- To turn on or off the device, slide down the power button and hold for 2 seconds.
- To switch gear, slide down the power key and quickly release it.

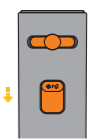

Move Forward

- Press the trigger to start the thrusters and move forward.

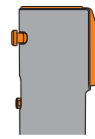

Steering

- Press the power trigger and turn the steering stick to make the device turn left or right while moving forward.
- Release the trigger and turn the steering stick to make the device rotate in place to the left or right.

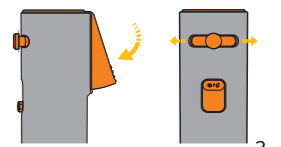

3

SPECIFICATIONS

Net Weight	~112g
Dimensions	38*56*120mm
Working Temperature	0-40°C
Waterproof Level	IP54
Charging Voltage	5V
Battery Runtime	6H

MAINTENANCE

- Do not immerse the product in water for a long time.
- Rinse with clean water and dry with a clean cloth after use.
- Keep the charging port dry while charging.
- Place the device in a cool, ventilated place to dry completely.

STORAGE

- Do not store the remote control in environments with high or low temperatures, excessive dryness or humidity, direct sunlight, or dust. Harsh environments can damage electronic devices.
- Before storing the remote control, fully charge the batteries to prevent excessive discharge due to non-use.
- If the remote control is not used for a long time, charge it once every three months.
- The storage temperature should not exceed the range of 0°C - 40°C.

DISPOSAL AT END-OF-LIFE

This product must not be disposed of by incineration, land filling, or chemical risks to the environment. The recommended disposal for any product at its end-of-life is to dispose of the entire unit at or through an e-waste recycling center, program, or facility. Local regulations and laws pertaining to the recycling and disposal of lithium-ion batteries and/or products containing them will vary according to country, state, and local governments. You must check laws and regulations corresponding to where you live in order to properly dispose of the battery and/or unit. It is the user's responsibility to dispose of their waste equipment properly with accordance with local regulations and laws. For additional information about where you should drop off your batteries and electrical or electronic waste, please contact your local or regional waste-management office, your household waste disposal service, or your point-of sale.

SAFETY WARNINGS

LEFEET product is designed with user safety as the top priority. However, like any electronic sports product, using LEFEET product also carries certain risks (such as losing control). Therefore, it is very important to read and follow all instructions and warnings in the user manual and make good judgments when using it. We consider the use of LEFEET products as the user's acknowledgment and acceptance of all related risks and responsibilities that may arise during use, including but not limited to muscle injuries, fractures, tears, or other serious injuries. The use of LEFEET product is at your own risk. We are not responsible for accidents caused by a lack of common sense.

Children under 14 years old can only use it under the supervision of parents or other adults. For better safety, please read and follow all instructions and warnings in the user manual.

Federal Communications Commission (FCC) Interference Statement

This equipment has been tested and found to comply with the limits for a Class B digital device, pursuant to Part 15 of the FCC Rules.

These limits are designed to provide reasonable protection against harmful interference in a residential installation. This equipment generate, uses and can radiate radio frequency energy and, if not installed and used in accordance with the instructions, may cause harmful interference to radio communications.

However, there is no guarantee that interference will not occur in a particular installation. If this equipment does cause harmful interference to radio or television reception, which can be determined by turning the equipment off and on, the user is encouraged to try to correct the interference by one of the following measures:

- Reorient or relocate the receiving antenna.
- Increase the separation between the equipment and receiver.
- Connect the equipment into an outlet on a circuit different from that to which the receiver is connected.
- Consult the dealer or an experienced radio/TV technician for help.

This device complies with Part 15 of the FCC Rules. Operation is subject to the following two conditions:

(1) This device may not cause harmful interference, and (2) this device must accept any interference received, including interference that may cause undesired operation.

FCC Caution: Any changes or modifications not expressly approved by the party responsible for compliance could void the user's authority to operate this equipment.

RF exposure compliance

This equipment complies with FCC radiation exposure limits set forth for an uncontrolled environment.

5

WARRANTY SERVICE

Main Unit LEFEET guarantees that the LEFEET products you purchase are designed and manufactured according to the qualified standards. Under normal use, there is no functional defect during the warranty period. If you have any problem in the process of using, we recommend that you first check the user manual, furthermore, you can also download the user manual, FAQ, instructional video or support forum on our website.

Scope of Services Your LEFEET product includes a one-year limited hardware warranty which starts from the date of the sales invoice, the warranty period of the main body is 12 months while the warranty period of the battery is 6 months. If you cannot provide invoice or other valid proof of purchase, then the warranty period will start from 90 days after the production date that shows on the product, or otherwise specified by LEFEET. If repairs are not feasible or commercially unfeasible, we may replace this product with new or refurbished products with similar features. After repair, firmware upgrade and replacement, the replaced product or accessory will be covered by the same warranty during the remaining warranty period of the original product.

How to Obtain After-Sales Services If a product does not function as warranted during the warranty period, please contact us through service@lefeet.com to obtain after-sales service. LEFEET may not offer after-sales service in certain area, the policy of after-sales service varies from different places. Additional charges may be required for services outside the regular service scope. Please contact us for information specific to your location.

What to do Before Obtaining After-Sales Services Please specify the problems with the product after contacting LEFEET. LEFEET technicians will attempt to diagnose and resolve your problem by phone, email, or remote assistance. If your problem cannot be resolved over the telephone, you may be required to deliver the product to LEFEET for further examination. LEFEET will arrange for repair or replacement service under this Limited Warranty Service.

Product and Part Replacement When after-sales service involves the replacement of a product or part, the replaced product or part becomes LEFEET's property and the replacement product or part becomes your property. Only unaltered LEFEET products and parts are eligible for replacement. Replacement products or parts provided by LEFEET may not be new, but it will be under good working order and at least functionally equivalent to the original product or part's capabilities. A replacement product or part shall be covered for the time remaining in the original product's warranty.

Use of Personal Contact Information If you obtain service under this policy, you authorize LEFEET to store, use, and process your contact information, including name, phone numbers, address, and e-mail address. You agree and understand that it is necessary for LEFEET to collect, process and use your information to perform service under this policy. We may contact you to inquire about your satisfaction with our service or to notify you about any product recalls or safety issues. In order to achieve these aims, you authorize LEFEET to transfer your information to any country where we do business and to provide it to entities acting on our behalf. We may also disclose your information where required by law.

6

What this After-Sales Policy does not cover

- Collision or burning down accidents caused by man-made and non-product quality problems.
- Damage caused by unauthorized modification and dismantling of the shell under the guidance of the unofficial instruction manual.
- Damage caused by improper installation, use and operation not according to the user manual.
- The customer repairs the parts by himself or asks an unauthorized service organization to repair/modify the parts without official instructions.
- Damage caused by improper circuit modification guided by unofficial user manual and mismatch or misuse of the battery and charger.
- Damage caused by misuse of the product or handling of the product under environmental conditions not in accordance with the user manual.
- Damage due to peripherals, add-on devices, or accessories other than those recommended in the user manual.
- Damage caused by insufficient discharge when the battery is low or when using a battery with quality problems.
- The device has been damaged, including but not limited to damage caused by animals, lightning, abnormal voltage, fire, natural disasters and transportation.
- Products or parts with an altered identification label or from which the type number, serial number, production date has been removed or unrecognizable.
- The product cannot work properly because it is not used in the country/ area where it was originally designed and manufactured or approved for use.
- For third-party applications that you use on the product.

Limitation of Liability LEFEET only take charge of the loss or damage under following circumstances: Your product is owned by LEFEET or it is in LEFEET's transportation. Under no circumstance, and notwithstanding the failure of essential purpose of any remedy set forth herein, shall LEFEET, its affiliates, suppliers, dealers, or service providers be liable for any of the following even if informed of their possibility and regardless of whether the claim is based in contract, warranty, negligence, strict liability or other theory of liability:

- 1) Third party claims against you for damages;
- 2) Special, incidental, punitive, indirect or consequential damages, including but not limited to lost profits, business revenue, goodwill or anticipated savings. In no case shall the total liability of LEFEET, its affiliates, suppliers, dealers, or service providers for damages from any cause exceed the amount of actual direct damages, not to exceed the amount paid for the product.

More ways to use your LEFEET Products can be found at www.lefeet.com

7