

M  
MAGNUS®



VC-400-SC  
Owner's Manual

# MAGNUS®

## Wireless LANC Controller

### Thank you for choosing Magnus.

The Magnus Wireless LANC Controller offers direct access to your Canon or Sony camcorder's recording functions. Control zoom, focus, and iris speeds with variable speed settings. The pressure-sensitive rocker allows you to easily record smooth video while zooming in and out for telephoto and wide-angle shots. Wirelessly start and stop video recording and review your last recorded clip. Clamp the remote onto your tripod's pan handle so you can zoom and pan at the same time.

### Overview

#### Remote and Receiver

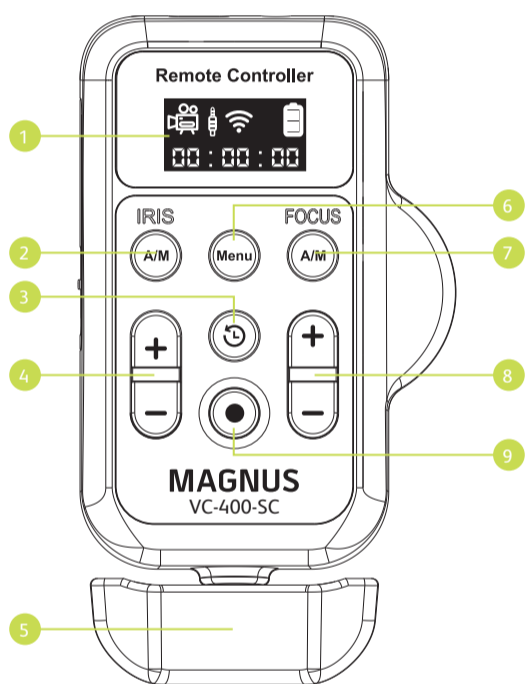

- 1 **Display**
- 2 **IRIS A/M:** Press to toggle auto IRIS adjustment. When you enter the remote's setup menu, press this key to exit the menu.
- 3 **Record review:** While in standby mode, press the button to review the last recorded clip. When the video ends, the camcorder will return to standby mode.  
**Note:** Depending on the camcorder's record review settings, it is possible that the last several seconds of the previously recorded video will also play.
- 4 **IRIS +/-:** + Opens the iris (decreases the iris value)  
- Closes the iris (increases the iris value)
- 5 **Zoom lever:** Turn right to zoom in on a subject. Turn left to zoom out from a subject.  
**Note:** If the camcorder has a ZOOM mode, switch it to the SERVO or REMOTE mode.
- 6 **Menu:** Press to enter and exit the setup menu.
- 7 **FOCUS A/M:** Press to toggle auto FOCUS adjustment. When you enter the remote's setup menu, press this key to confirm the selected menu setting.
- 8 **FOCUS +/-:** + Focuses on distant subjects  
- Focuses on close subjects
- 9 **Record:** Press to start and stop recording.

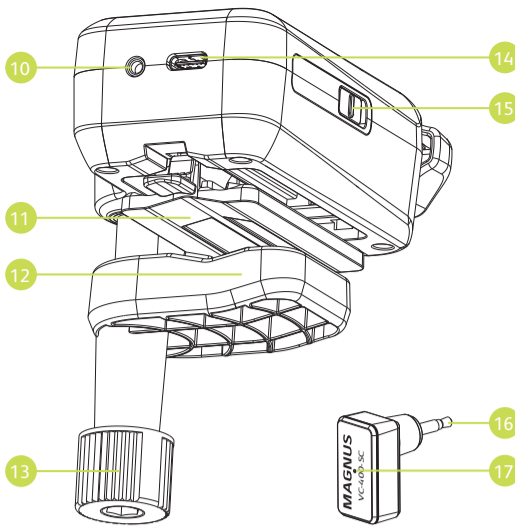

- 10 **Remote port:** Use the supplied 2.5 mm cable to connect the remote to the camcorder.
- 11 **Battery compartment cover**
- 12 **Clamp**
- 13 **Clamp knob**
- 14 **USB Type-C port:** Used for firmware updates. Visit [www.magnustripods.com](http://www.magnustripods.com) to download the latest firmware.
- 15 **On/Off switch**
- 16 **Plug:** 2.5 mm jack for connection to a camcorder's REMOTE or LANC port.
- 17 **LED:** Indicates the wireless receiver's activity status.

**Also Included:** 2.5 mm coiled cable

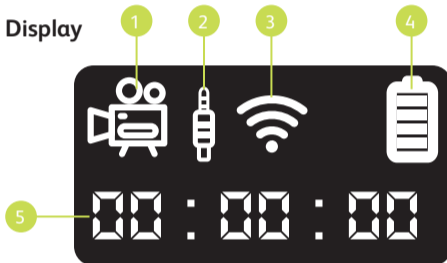

- 1 **Record indicator:** Displays the icon when recording starts. No icon appears when recording stops.
- 2 **Wired Connection indicator:** Displays when a wired connection is created.
- 3 **Wireless Connection indicator:** Displays when a wireless connection is created.
- 4 **Battery indicator:** Displays the remaining battery level.
- 5 **Timer:** The timer starts when the camcorder starts recording. When recording stops, the timer displays 00:00:00 to indicate hours : minutes : seconds.

### Installing the Batteries

1. Loosen the clamp knob and swivel the clamp so it doesn't block the battery compartment door.

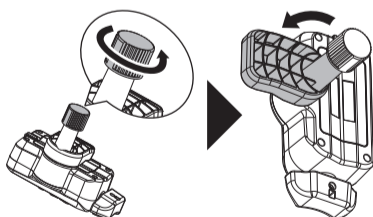

2. Press the battery door's latch inward until you can pull up on the door and remove it.

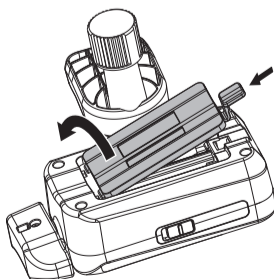

3. Install two AAA 1.5 V batteries as shown.

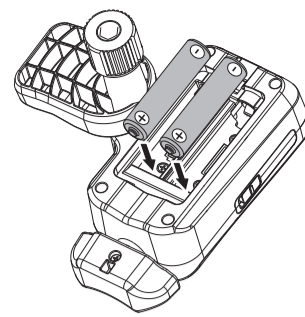

4. Replace the battery door until it snaps shut.

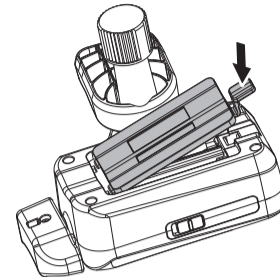

### Mounting the Remote

You can easily mount the remote to a tripod's pan handle for easy access and control.

1. Loosen the clamp knob so you can insert the pan handle.

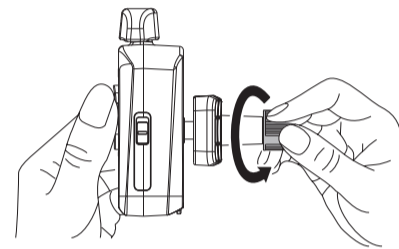

2. Align the pan handle with the groove on the clamp, and rotate the clamp knob to tighten and secure the clamp onto the pan handle.  
**Note:** Depending on the pan handle attached, the remote may make contact with the grip of the pan handle when it's in use. Attach the remote so there's a small amount of space between the remote and the grip.

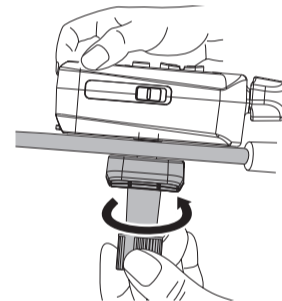

### Connecting the Remote to a Camera

#### Wireless Connection

1. Make sure the camcorder is turned off, and insert the wireless receiver into the camcorder's Remote or LANC port.  
**Note:** Refer to the camcorder's user manual for the location of the REMOTE or LANC port.

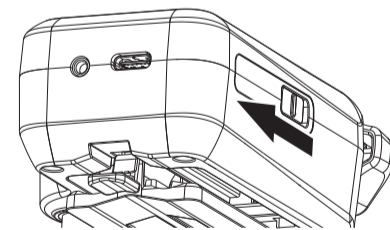

2. Turn on the camcorder, and slide the remote's power switch to the ON position. The receiver's LED will blink red while trying to connect to the remote, and blink green when connected. The Wireless Connection indicator will appear onscreen to confirm the connection.  
**Note:** If there is no connection to a camcorder, or the camcorder's power is off, the LED will be off.

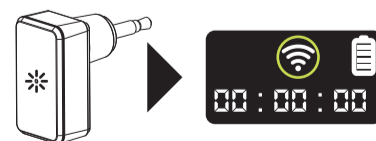

3. Toggle the zoom lever to test that the remote is working with the camcorder and adjusting the zoom.

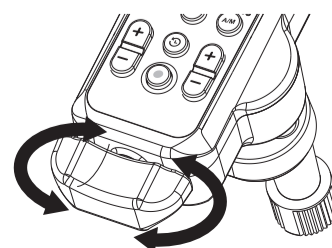

## Wired Connection

1. Make sure the camcorder is turned off, and insert one end of the 2.5 mm coiled cable into the remote's REMOTE port, and the other end into the camcorder's REMOTE or LANC port.  
**Note:** Refer to the camcorder's user manual for the location of the REMOTE or LANC port.

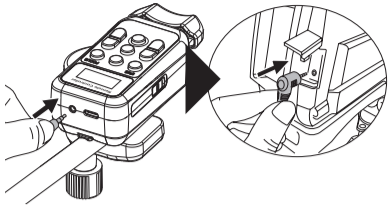

2. Turn on the camcorder, and slide the power switch on the side of the remote to the ON position. The Wired Connection indicator will appear onscreen to confirm the connection.



## Setting the Shooting State of the Camcorder

- Depending on the camcorder you're using, you may need to activate the remote function using the camcorder's menu.
- You may need to cancel the automatic adjustment of the camcorder's shooting state.
- If you're using an interchangeable-lens-type camcorder with the supplied lens, set the focus ring to electronic control. If you're using a lens other than the supplied lens, focusing may not be supported from this remote.
- If the camcorder is an interchangeable lens type, set the IRIS switch on the lens to auto adjustment (AUTO).

## Menu Setup

### Navigating the Menu

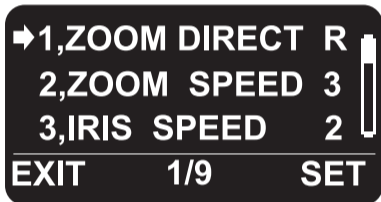

Enter the menu by pressing the menu button on the remote.

Select a setting by pressing the +/- adjustment buttons until the **▶** is at the desired setting.

Press the FOCUS A/M button, which corresponds to SET on the remote display, to enter the selected menu.

- Use the +/- buttons to scroll through the setting's selectable parameters.
- Press the FOCUS A/M button to confirm and return to the settings menu.

Exit the menu by pressing the IRIS A/M button, which corresponds to Menu on the remote display.

### Menu Settings

**ZOOM DIRECT – N, R:** Sets the direction of the ZOOM lever.

- N (Normal): Turn the ZOOM lever to the right to zoom in (telephoto), and to the left to zoom out (wide angle).
- R (Reverse): Turn the ZOOM lever to the left to zoom in (telephoto), and to the right to zoom out (wide angle).

**ZOOM SPEED – 1, 2, 3:** Sets the zoom speed.

- 1 (Slow) – In slow mode, the camcorder zooms at the slowest speed, regardless of how much the zoom lever is rotated.
- 2 (Mid) – In mid mode, the camcorder zooms at a medium speed, depending on how much the zoom lever is rotated.
- 3 (Fast) – In fast mode, the camcorder zooms at the fastest speed, depending on how much the zoom lever is rotated.

**IRIS SPEED – 1, 2:** Sets the IRIS adjustment increment level.

- 1 (Slow): In this mode, pressing the + or – buttons will adjust the camcorder's iris setting by 1 stop.
- 2 (Fast): In this mode, pressing the + or – buttons will adjust the camcorder's iris setting by 4 stops.

**FOCUS SPEED – 1, 2, 3:** Sets the focus's manual adjustment speed from 1 to 3 (slow to fast).

**Note:** The focus speed may vary depending on the camcorder you are using.

**SLEEP – OFF, 10M, 1H, 4H:** Sets the remote's idle time before entering sleep mode to save battery power.

- OFF: Turns off sleep mode. If the remote's On/Off switch is not set to Off, the remote will stay on until the battery runs empty.
- 10M: The remote will enter sleep mode after 10 minutes of inactivity.
- 1H: The remote will enter sleep mode after 1 hour of inactivity.
- 4H: The remote will enter sleep mode after 4 hours of inactivity.

Press any button to wake the remote.

**KEY B.L. – AUTO, ON, OFF:** This controls the display's backlight when using the remote.

- Auto: The backlight turns on for about 10 seconds when any operation is performed on the remote.
- ON: The backlight is always on.
- OFF: The backlight is always off.

**PAIR MODE – Y:** Pairing mode setup between the remote and receiver. Make sure the receiver is plugged into the camcorder and is receiving power.

- Y: Press the (FOCUS/SET) button to confirm and start the pairing operation. The remote will automatically look for the receiver.

After successfully pairing, the receiver's status LED will flash green.

**RESET ALL – Y:** Restore the remote's factory settings.

- Y: Press the (FOCUS/SET) button to confirm and restore the remote to its factory settings.

**VERSION Vx.X:** This shows the current firmware version installed on the remote.

## Specifications

**Wireless Frequency:** 2.4 GHz

**Wireless Range:** 164 ft. (50 m)

**Power Source:** Remote: 2×AAA 1.5 V batteries (not included)  
Receiver: the camcorder's power

**Cable Length:** 3.3 ft. (1 m)

**Remote/LANC Cable:** 2.5 to 2.5 mm (coiled)

**Remote Screen:** OLED

**Clamp Size:** 1.3 in. (33 mm)

**Remote Dimensions (H × W × D):**  
4.1 × 2.3 × 3.2 in.  
(104 × 58 × 81 mm)

**Receiver Dimensions (H × W × D):**  
0.9 × 0.5 × 1.1 in.  
(22 × 12.5 × 29 mm)

**Remote Weight:** 4.8 oz. (136 g) without batteries

**Receiver Weight:** 0.05 oz. (3 g)

## FCC Compliance

This device complies with part 15 of the FCC Rules. Operation is subject to the following two conditions:

1. This device may not cause harmful interference.
2. This device must accept any interference received, including interference that may cause undesired operation.

**FCC ID:** 2AEJW-ZC3

**IC:** 25192-ZC3

CE, UKCA

## Warnings

- Please read and follow all the instructions in this manual.
- Make sure the item is intact and that there are no missing parts.
- Turn off the camera's power before inserting or removing the remote cord.
- Keep this device away from water and extreme humidity, and store it in a cool and dry place.
- Do not operate in conditions with extreme heat or cold.
- Do not operate in the presence of flammable gases or vapors.
- Avoid operating this device in the presence of magnetic fields. A strong static charge or electromagnetic field generated by devices such as a radio transmitter can interfere with this device.
- Do not disassemble or perform any unauthorized modifications. Use only with the compatible devices specified in this manual.
- Use only the batteries listed in this manual, and make certain to align the batteries with the correct polarity.
- Batteries are prone to leakage when fully discharged. Remove the batteries when leaving the product unattended for prolonged periods or when no charge remains.
- Keep out of reach of children. This device contains small parts which may pose a choking hazard.
- Dispose of used batteries, packaging, and old devices in accordance with the appropriate local environmental regulations.
- All images are for illustrative purposes only.

## One-Year Limited Warranty

This Magnus product is warranted to the original purchaser to be free from defects in materials and workmanship under normal consumer use for a period of one (1) year from the original purchase date or thirty (30) days after replacement, whichever occurs later. The warranty provider's responsibility with respect to this limited warranty shall be limited solely to repair or replacement, at the provider's discretion, of any product that fails during normal use of this product in its intended manner and in its intended environment. Inoperability of the product or part(s) shall be determined by the warranty provider. If the product has been discontinued, the warranty provider reserves the right to replace it with a model of equivalent quality and function.

This warranty does not cover damage or defect caused by misuse, neglect, accident, alteration, abuse, improper installation or maintenance. EXCEPT AS PROVIDED HEREIN, THE WARRANTY PROVIDER MAKES NEITHER ANY EXPRESS WARRANTIES NOR ANY IMPLIED WARRANTIES, INCLUDING BUT NOT LIMITED TO ANY IMPLIED WARRANTY OF MERCHANTABILITY OR FITNESS FOR A PARTICULAR PURPOSE. This warranty provides you with specific legal rights, and you may also have additional rights that vary from state to state.

To obtain warranty coverage, contact the Magnus Customer Service Department to obtain a return merchandise authorization ("RMA") number, and return the defective product to Magnus along with the RMA number and proof of purchase. Shipment of the defective product is at the purchaser's own risk and expense.

For more information or to arrange service, visit [www.magnustripods.com](http://www.magnustripods.com) or call Customer Service at 212-594-2353.

Product warranty provided by the Gradus Group. [www.gradusgroup.com](http://www.gradusgroup.com)  
Magnus is a registered trademark of the Gradus Group. © 2024 Gradus Group LLC. All Rights Reserved.

