

impact[®]



LS-CTB Series

20-Inch Turtle Base
C-Stand Kit

40-Inch Turtle Base
C-Stand Kit

INSTRUCTIONS

Introduction

Thank you for choosing Impact.

Impact's 20 and 40-inch C-Stands are standard go-to studio and location accessories for the photo, video, and TV industries. The stands are made to industry-standard size, so they'll perfectly fit on grip trucks or C-stand racks and carts. When combined with Impact's grip head and grip arm, there's no better tool for supporting light fixtures, a wide variety of grip gear, and light-modifying gobos like flags, silks, and scrims. Sturdy steel and aluminum construction make the stands strong, durable, and built to last.

The removeable turtle base makes transportation easy. The base features a junior 1 1/8-inch receiver that allows you to remove the riser and exchange it for a different-size riser or a stand adapter for low-angle shooting. Impact's unique quick-release leg lock simplifies opening and closing the legs for rapid deployment and breakdown. Other unique features like hexagonal brake castings, welded legs, and custom locking knobs give the C-stands a classic, sleek, and streamlined look.

Precautions

- Please read and follow these instructions, and keep this manual in a safe place.
- Make sure that this product is intact and that there are no missing parts.
- Do not exceed the maximum load capacity.
- Use caution when operating this product with the maximum load capacity.
- Make sure all connections and locking knobs are secure before proceeding.
- Always use sandbags.
- Be careful not to catch or pinch your fingers when opening and closing the legs or when adjusting the riser sections.
- Always make sure the load is supported when loosening any of the riser knobs to adjust the height of the stand.
- Make sure the load is balanced.
- When carrying a C-Stand kit (grip head and grip arm mounted on top pin), always grab the riser and grip arm together to prevent your hand from catching between the arm and the main riser.
- When opening and closing the legs, make sure the area around you is clear. Be especially aware of the perimeter where the legs swing open and closed, as well as the other end of the center column.
- All images are for illustrative purposes only.

Overview and Setup

Turtle Base C-Stand Overview

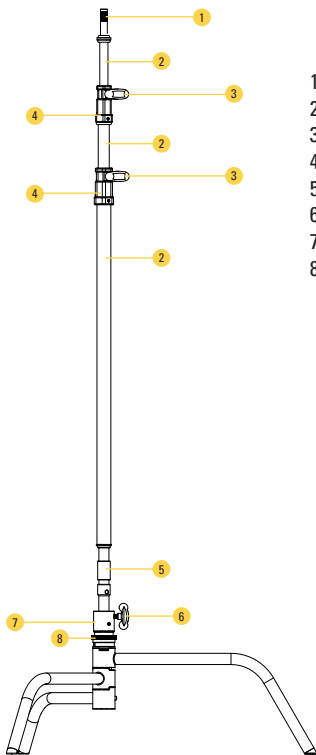

1. Baby pin
2. Riser sections
3. Riser locks
4. Brake castings
5. Junior pin
6. Junior receiver lock
7. Junior receiver
8. Leg release locking collar

Turtle Base C-Stand Setup

Setting Up the Legs

1. Hold the stand so that the riser sections are parallel to the floor with the legs facing up.
2. Pull the locking collar away from the legs.
3. Rotate the main riser so that the legs fall away from you.
4. Release the locking collar as soon as the legs start to fall, and they will lock into the open position automatically.

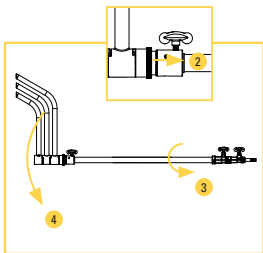

Closing the Legs

1. Hold the stand so that the riser sections are parallel to the floor with the largest leg pointing up.
2. Pull the locking collar away from the legs.
3. Rotate the main riser so that the legs fall towards you.
4. Release the locking collar as soon as the largest starts to fall, and the legs will lock into the closed position automatically.

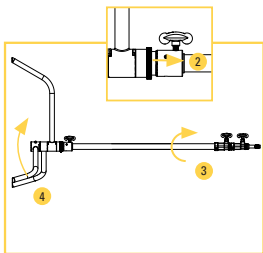

Removing and Replacing the Riser

1. Remove all fixtures and accessories, and remove the grip arm and grip head.
2. Loosen the base locking knob and lift the riser out of the junior receiver.
3. Replace it with a replacement riser, a junior-to-baby-pin adapter, or any other 1 1/8 in. adapter.
4. Tighten the locking knob until secure.

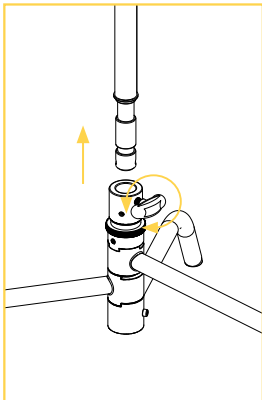

Grip Head Overview

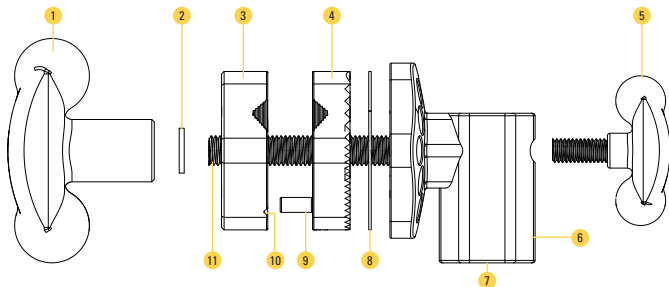

- | | |
|-----------------------|-----------------------|
| 1. T-knob | 7. Baby receiver |
| 2. Washer | 8. Friction disc |
| 3. Front disc | 9. Registration pin |
| 4. Rear disc | 10. Registration hole |
| 5. Baby receiver lock | 11. Central bolt |
| 6. Main grip body | |

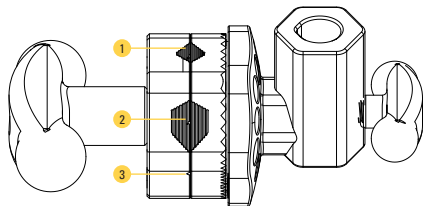

1. 3/8 in.
2. 5/8 in.
3. 1/8 in.

Grip Head Setup

1. Loosen the locking knob and place the grip head's baby receiver over the baby pin. Tighten the locking knob until secure.
2. For short pins, the head can be inverted on the baby pin, so the set screw engages with the pin.
3. The grip head provides 5/8 and 3/8-inch mounting holes for attaching grip arms and other lighting fixtures or grip equipment. There's also a 1/8-inch hole for grabbing the wires that rig fingers and dots.

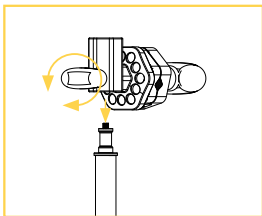
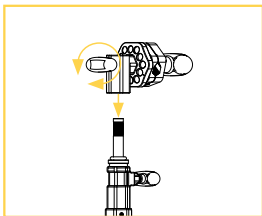

Grip Arm Overview

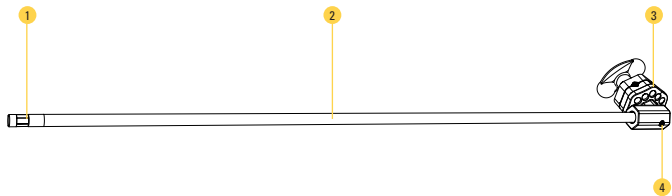

1. Hex pin
2. Grip arm
3. Grip head
4. Set-screw

Grip Arm Setup

The Impact GA-20 and GA-40 grip arms give you two options for attaching lights and accessories.

Use the grip head to attach accessories like gobos, flags, scrims, cutters, and backdrops.

Use the grip arm's hexagonal pin to attach small lights and accessories. The hex pin will ensure small lights and accessories don't slip or twist when they're mounted to the end of the arm.

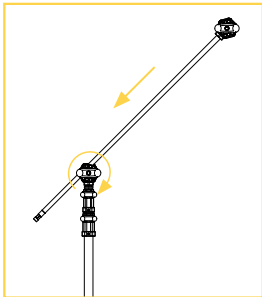

Attaching the Grip Arm

Important! Make sure the big knob is facing you and that the load is on the right side of the grip head. This will prevent the knob from accidentally loosening.

Loosen the knob, and insert the grip arm into the 5/8 in. hole. Make sure the end that holds the weight is to your right. Tighten the knob until secure.

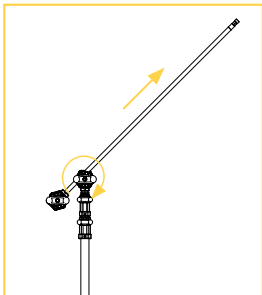

Specifications

C-stand

	20 in.	40 in.
Load Capacity	22 lb. (10 kg)	22 lb. (10 kg)
Top Mount	5/8 in. (16 mm)	5/8 in. (16 mm)
Maximum Working Height	59.06 in. (1,500 mm)	119.88 in. (3,045 mm)
Minimum Working Height	33.46 in. (850 mm)	53.54 in. (1,360 mm)
Footprint Diameter	34.54 in. (877.26 mm)	34.54 in. (877.26 mm)
Detachable Base	Yes	Yes
Finish	Silver: chrome Black: powder coat	Silver: chrome Black: powder coat
Construction Material	Silver: Steel, Aluminum Black: Steel, Aluminum	Silver: Steel, Aluminum Black: Steel, Aluminum
Weight	Kit: 16.74 lb. / 7.61 kg (Silver & Black) Stand: 12.56 lb. / 5.71 kg (Silver & Black)	Kit: 20.82 lb. / 9.46 kg (Silver) 21.04 lb. / 9.56 kg (Black) Stand: 15.98 lb. / 7.26 kg (Silver & Black)

Grip Head

Mounting Size	5/8 in. (16 mm)
Construction Material	Steel, Aluminum
Finish	Chrome / Matte black
Head Diameter	2.5 in. (6.3 cm)
Compatible Diameters	5/8 in., 3/8 in., 1/8 in. (16, 10, 3 mm)
Dimensions (H x W x D)	3.15 x 3.54 x 6.98 in. (80.12 x 90 x 177.35 mm)
Weight	1.76 lb (0.80 kg) (Silver & Black)

Grip Arm

	20 in.	40 in.
Load Capacity	22 lb. (10 kg)	22 lb. (10kg)
Construction Material	Silver: Stainless Steel, Aluminum Black: Iron, Aluminum	Silver: Stainless Steel, Aluminum Black: Iron, Aluminum
Finish	Silver: chrome Black: powder coat	Silver: chrome Black: powder coat
Length	20.95 in. (532.21 mm)	40.95 in. (1,040.09 mm)
Width	3.54 in. (90 mm)	3.54 in. (90 mm)
Weight	2.42 lb. (1.1 kg) (Silver and Black)	Silver: 3.08 lb. (1.4 kg) Black: 3.3 lb. (1.5 kg)

One-Year Limited Warranty

This Impact product is warranted to the original purchaser to be free from defects in materials and workmanship under normal consumer use for a period of one (1) year from the original purchase date or thirty (30) days after replacement, whichever occurs later. The warranty provider's responsibility with respect to this limited warranty shall be limited solely to repair or replacement, at the provider's discretion, of any product that fails during normal use of this product in its intended manner and in its intended environment. Inoperability of the product or part(s) shall be determined by the warranty provider. If the product has been discontinued, the warranty provider reserves the right to replace it with a model of equivalent quality and function.

This warranty does not cover damage or defect caused by misuse, neglect, accident, alteration, abuse, improper installation or maintenance. EXCEPT AS PROVIDED HEREIN, THE WARRANTY PROVIDER MAKES NEITHER ANY EXPRESS WARRANTIES NOR ANY IMPLIED WARRANTIES, INCLUDING BUT NOT LIMITED TO ANY IMPLIED WARRANTY OF MERCHANTABILITY OR FITNESS FOR A PARTICULAR PURPOSE. This warranty provides you with specific legal rights, and you may also have additional rights that vary from state to state.

To obtain warranty coverage, contact the Impact Customer Service Department to obtain a return merchandise authorization ("RMA") number, and return the defective product to Impact along with the RMA number and proof of purchase. Shipment of the defective product is at the purchaser's own risk and expense.

For more information or to arrange service, visit www.impactstudiolighting.com or call Customer Service at 212-594-2353.



Product warranty provided by the Gradus Group.

www.gradusgroup.com

Impact is a registered trademark of the Gradus Group. © 2024 Gradus Group LLC.

All Rights Reserved.