

Product Overview

This product is a continuous RGB light. It allows single/double light head control, supports APP wireless control, and features an output for charging. The soft tube enables any angle adjustment, and the included tripod stand and phone mount make it ideal for live streaming and makeup.

Product Contents

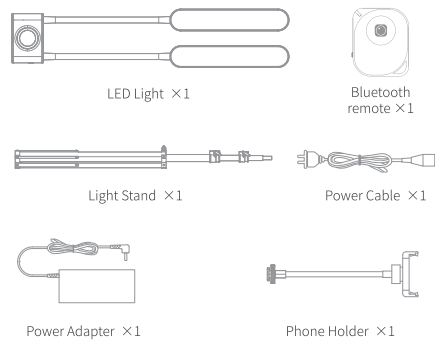

Product Illustration

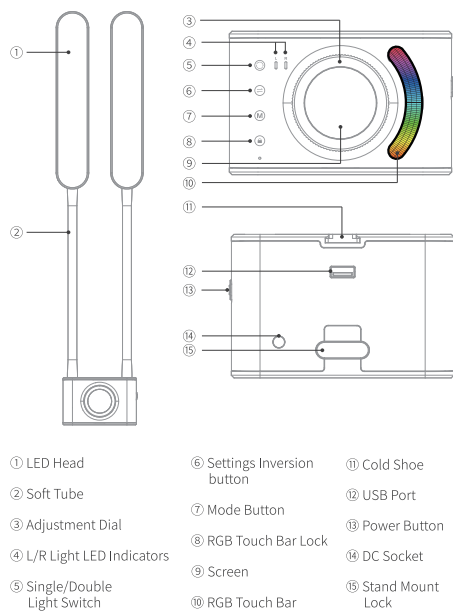

01

Installation Instructions

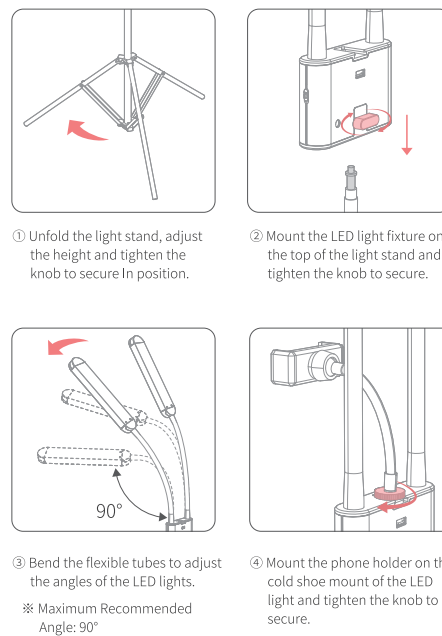

Installation Instructions

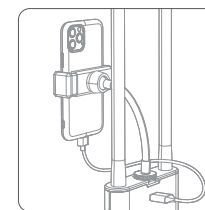

⑤ Insert your phone into the holder. A USB cable can be used to charge the phone.

Operating Guide

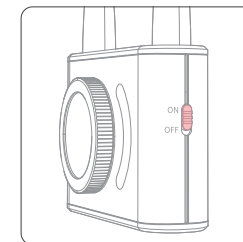

• Power ON/OFF

Power the light with the included power adapter.

Move the "ON/OFF" switch into either position to power the light on or off.

02

Operating Guide

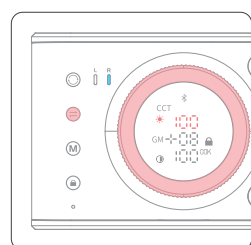

• Brightness Adjustment

In any mode, short press "≡" and select "☀️". Turn the adjustment dial to adjust brightness.

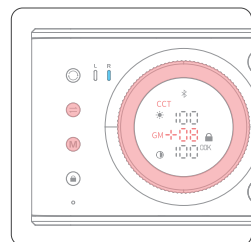

• GM Correction Value Adjustment

Short press the "M" button to switch to CCT mode, and press the "≡" button to select "GM". Turn the adjustment dial to adjust GM correction value.

Operating Guide

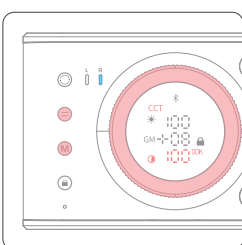

• Color Temperature Adjustment

Short press the "M" button to switch to CCT mode, and press the "≡" button to select "CCT". Turn the adjustment dial to adjust color temperature.

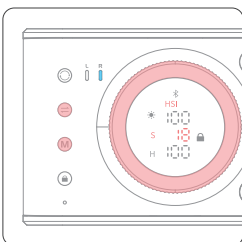

• Saturation Adjustment

Short press the "M" button to switch to HSI mode, and press the "≡" button to select "S". Turn the adjustment dial to adjust saturation.

03

Operating Guide

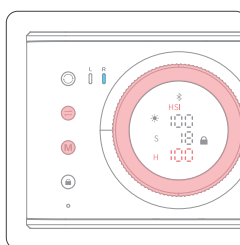

• Hue Adjustment (Buttons)

Short press the "M" button to switch to HSI mode, and press the "≡" button to select "H". Turn the adjustment dial to adjust hues.

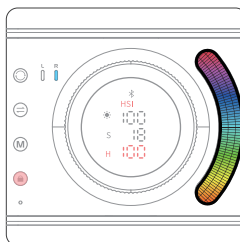

• Hue Adjustment (Touch Bar)

Short press the "M" button, and the "🔒" icon will disappear from the screen. Glide your finger on the touch bar to adjust hues.

Short press the "🔒" button again, the "🔒" icon will show up on the screen. The touch bar is now locked.

Operating Guide

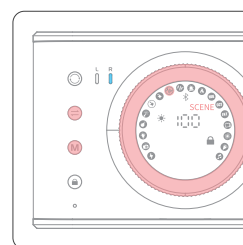

• Scenes

Short press the "M" button to switch to SCENE mode, and press the "≡" button to select SCENE. Turn the adjustment dial to choose from different scenes.

Scene modes

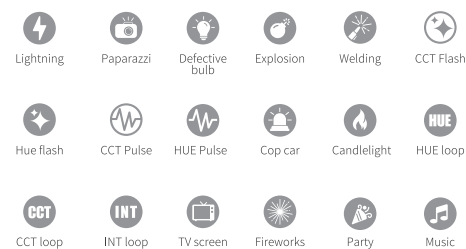

04

Operating Guide

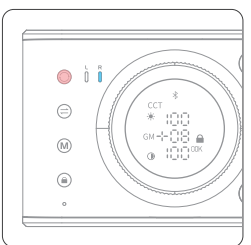

• Toggling between Single/Double Light

Short press "⊕" button to control the left light, right light, or double lights.

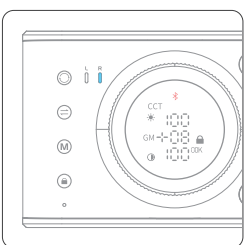

• APP Control

Use NEEWER APP to control lighting after pairing your smartphone with the light via Bluetooth connection. For detailed operation, please scan the QR code on the APP Instruction Page from the APP Prompt Card.

A successful connection has been made once "📶" has stopped flashing.

Safety Notes

1. Please do not drop the product to prevent damage to the light or its components which could result from a strong impact.
2. Please refrain from looking directly into the light which may result in eyesight damage.
3. Please do not place the product in an environment containing flammable or volatile substances.
4. Please do not use the product in the rain or a humid environment.
5. Turn off at the power source when not in use.
6. When not in use, please keep the product in a well-ventilated, dry place away from heat sources and magnetic fields.
7. Wait for the product to cool down before putting it in a carry case to prevent any residual heat from causing damage to the LEDs.

Specifications

Model	BH40C
Number of LEDs	528PCS
Input Voltage	DC 15V
Output	5V 2A
Maximum Power	36W
Maximum Illuminance	4600lux@0.5m
CRI	CRI 98+
Dimming Range	0 ~ 100
Color Temperature	2500 ~ 10000K
GM Correction Values	-50~+50
Saturation	0~100
Hue	0~360

05

EN

EN

EN