

hovercam ORBIT

QUICK START GUIDE

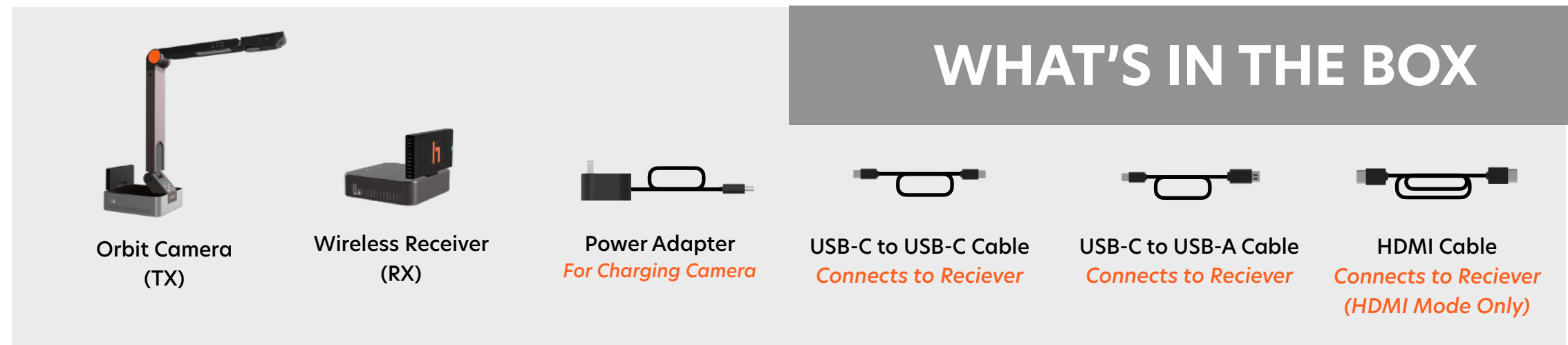

A Wireless USB Setup

- 1 Connect Wireless Receiver dongle to computer** with either the **USB-C to A** or **USB-C to C** cable. **DO NOT** use cable marked "power only". Receiver will power-on automatically and search for camera.
- 2 Aim Wireless Receiver antenna towards Camera's antenna**
IMPORTANT: Line-of-sight required. Rotate both antennas 90° upwards. See the backside for more details.
- 3 Power-On Orbit Camera** by pressing & holding power button on the side of the camera.
- 4 Open any camera software on computer** and select "HoverCam Orbit" as camera input. We recommend using the free **HoverCam Flex** software downloadable from hovercam.com/software
- 5 Wait for Orbit to Connect.** Loading screen will display until camera connects. When wireless status indicators on Camera (TX) and Receiver (RX) are solid blue, connection is complete. Connection takes ~ 30 sec.

CHARGING

BATTERY LIFE: ~6-8 Hrs
CHARGING TIME: ~3 Hrs

Battery Indicator:

- Lights Flashing 1, 2, 3: Charging
- 3 Lights: 75% - 100% Remaining
- 2 Lights: 50-75% Remaining
- 1 Light: 25-50% Remaining
- 1 Light (Flashing): Less than 25% Remaining

IMPORTANT: CAMERA AND RECEIVER MUST HAVE "LINE-OF-SIGHT" SEE BACKSIDE FOR MORE INFO

B Wireless HDMI Setup

- 1 Mount Wireless Receiver dongle on display**
- 2 Connect Wireless Receiver to display** using the included HDMI cable.
- 3 Connect Wireless Receiver to power source** Use either **USB-C to A** or **USB-C to C** cable to connect to USB port on display (or to wall using power brick)
- 4 Aim Wireless Receiver's antenna towards Camera's antenna**
IMPORTANT: Line-of-sight is required. Rotate both antennas 90° upwards.
- 5 Power-On Orbit Camera** by pressing & holding power button on side.
- 6 Power-On Display** and switch input to correct HDMI port.
- 7 Wait for Orbit to Connect.** Loading screen will display until camera connects. When wireless status indicators on Camera and Receiver are solid blue, connection is complete. Connection takes ~ 30 seconds.

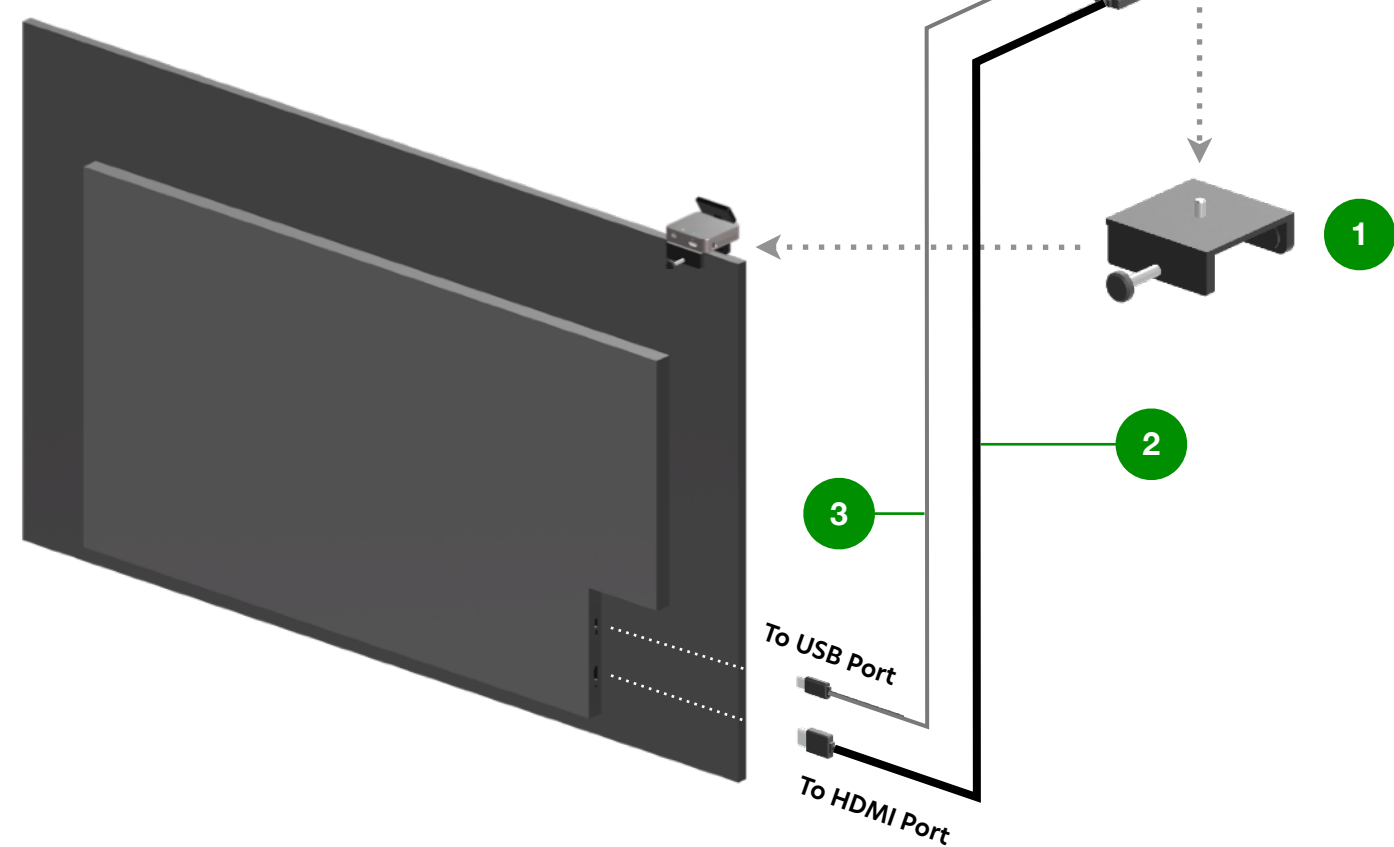
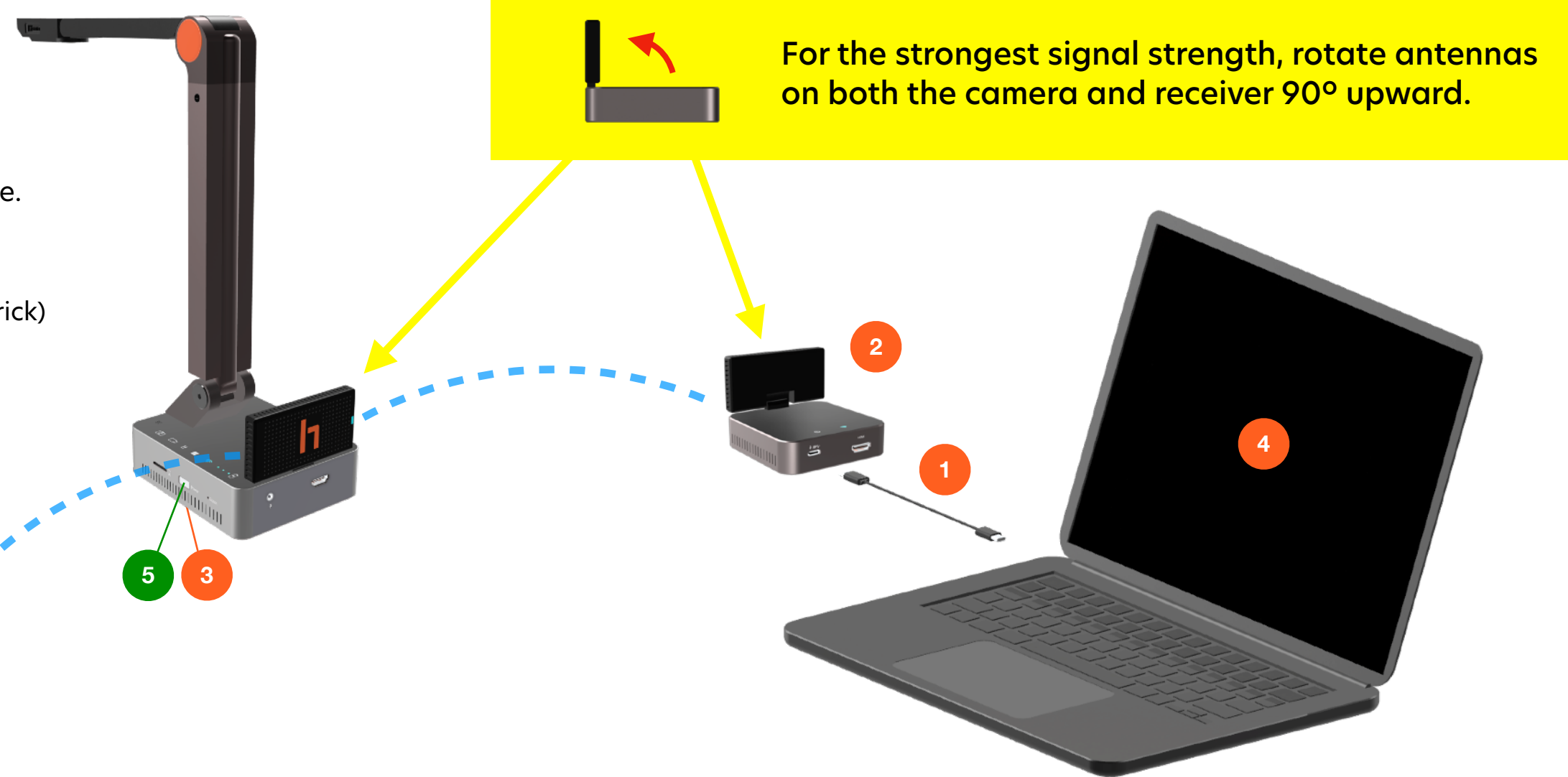

CAMERA CONTROLS

- Enable Autofocus:** Camera will constantly adjust focus
- Autofocus Lock:** Focus will be locked until AF is pressed again.
- Zoom-In**
- Flip 180°**
- Zoom-Out**
- Battery Status**
- Wireless Status Indicator**
- Stop Recording**
- Freeze Image**
- Record Video**
- Take Snapshot**

Note: These buttons for local recording with Micro-SD card only, but you can download HoverCam software to take snapshots / record videos onto computer.

Wireless Status Indicator:

- Flashing: Searching for Camera
- Solid: Connected
- Off: Camera/Receiver Off

ORBIT Line-of-Sight Required

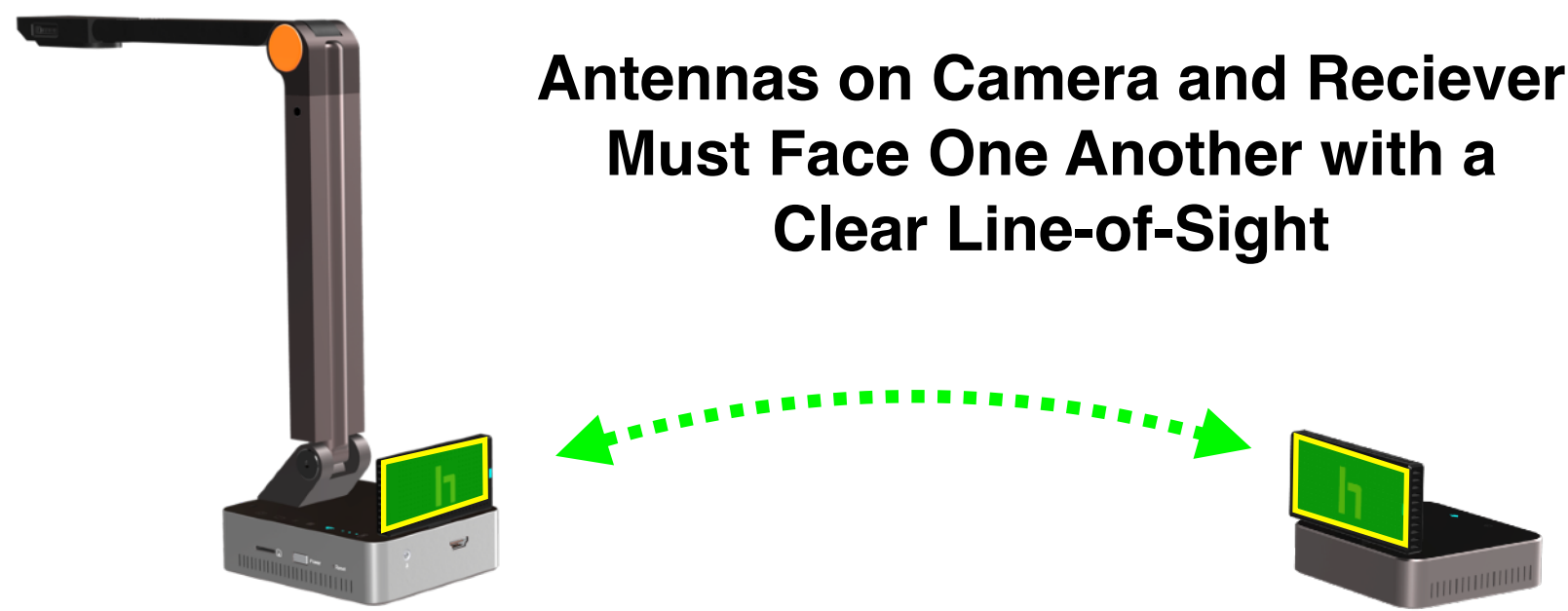

Antennas on Camera and Receiver Must Face One Another with a Clear Line-of-Sight

Important Disclosure (Please Read)

Orbit Pro uses mmWave (60GHz Radio Frequency) technology instead of Wi-Fi for wireless transmission. Users should understand that mmWave does not pass through objects, and requires a clear line of sight between the camera and receiver dongle. While mmWave offers significant advantages, it requires proper installation and awareness to maintain a clear line of sight. Temporary signal loss may occur if the line of sight is obstructed—this is normal and can often be minimized or eliminated with proper setup and optimization. We strongly recommend testing Orbit Pro in a real classroom environment with students and teachers present before making a final purchase. HoverCam's warranty covers material defects but does not cover brief signal loss due to line-of-sight issues, which can typically be resolved through technical assistance and adjustments in usage practices.

Read the full disclosure at <https://www.hovercam.com/s/REV-250219-ORBIT-PRO-mmWave-Disclaimer.pdf>

<p>✓ Camera and Receiver must be in the same room, within line-of-sight of each other.</p>	<p>✗ Signal can be blocked by large objects. Ensure Camera has clear line-of-sight to Receiver.</p>
<p>✓ In enclosed rooms, signal can bounce off walls, so Camera's antenna doesn't always have to directly face Receiver.</p>	<p>✗ The signal can pass through windows. Avoid facing antenna towards windows, and opt for line of sight positioning.</p>
<p>✓ Mount Wireless Receiver high-up on display for best signal reception.</p>	<p>✗ DO NOT hide Receiver behind display. Receiver must have open line of sight with Camera.</p>

<p>✓ Keeping Camera's antenna unobstructed and facing Receiver provides the strongest signal.</p>	<p>✗ Sitting or standing in front of Camera's antenna can cause signal drop. Do not stand between Camera and Receiver.</p>
<p>✓ Position Receiver as high as possible to maximize line-of-sight and minimize chances of signal interruption.</p>	<p>✗ Do not position Receiver in places where chances of signal interruption are greater.</p>
<p>✓ Rotate antennas 90° upwards for strongest connection and heat management.</p>	<p>✗ DO NOT operate while antennas are folded down flush to the body. DO NOT point antennas directly into solid surfaces.</p>

SUPPORT

[hovercam.com/orbit-academy](https://www.hovercam.com/orbit-academy)

✉ support@hovercam.com

☎ +1 (858)-750-3499

Pathway

© Copyright 2023 Hovercam®. All rights reserved. Hovercam® is a registered trademark of Pathway Innovations, Inc. The following granted or pending patents have been filed by Pathway Innovations, Inc. (D.B.A. Hovercam) with the United States Patent and Trademark Office (USPTO): <https://www.hovercam.com/patents>. 250305