

# WATSON<sup>®</sup> PRO

*VM-140-FP*  
*VM-210-FP*

*FastPower*

V-Mount Li-ion Battery with  
USB Ports (145/217 Wh)

**Thank you for choosing Watson Pro**

Please read this user manual carefully, and keep it  
for reference before using the battery.

# SAFETY INSTRUCTIONS

- Make sure the battery is fully charged before use.
- When the battery is not in use, remove it from its device. Some electronic equipment will draw current even when the switch is off.
- Do not short-circuit the terminals. This battery is protected with an internal self-resetting fuse, but short circuits may still cause severe damage to the battery.
- Do not attempt to open the battery case under any circumstances.
- Do not remove the battery from any equipment that is powered on. Always power off your equipment before removing the battery.
- Use the battery only under proper environmental conditions: -4°F to 113°F (-20°C to 45°C) and with a relative humidity (RH) less than 85%.
- The battery should be fully charged for long-term storage. After 4 months of storage, the battery will require a full recharge.
- Storage environment: short term (one month) -4°F to 104°F (-20°C to 40°C) and RH 45% to 85%; medium term (three months) -4°F to 86°F (-20°C to 30°C) and RH 45% to 85%; long term (one year) -4°F to 77°F (-20°C to 25°C) and RH 45% to 85%.
- The battery may be warm during use or recharging. This is normal.

- Keep the battery out of fire, heat, and high pressure.
- Do not expose the battery to rain or moisture.
- Do not drop the battery or expose it to strong shocks.
- Keep this unit away from water and any flammable gases or liquids.
- Clean the battery and terminals with a clean, soft, and dry cloth.
- When operation time has noticeably decreased, the battery may need to be replaced.
- Keep this product away from children.
- Store the battery in a cool, dry place.
- All images are for illustrative purposes only.

## OVERVIEW

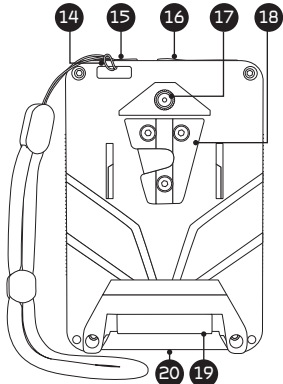
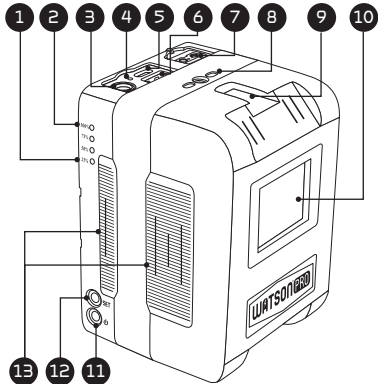

- |  |   |
|--|---|
| 1. <i>Low voltage indicator</i>          | 11. <i>Power on/off button</i>          |
| 2. <i>Battery indicators</i>             | 12. <i>SET button</i>                   |
| 3. <i>DC barrel port (output)</i>        | 13. <i>Side hand grip</i>               |
| 4. <i>12V indicator</i>                  | 14. <i>Lanyard slot</i>                 |
| 5. <i>USB-C port (input/output)</i>      | 15. <i>D-tap cover</i>                  |
| 6. <i>USB-A port (output)</i>            | 16. <i>USB/DC barrel cover</i>          |
| 7. <i>D-tap port (output)</i>            | 17. <i>1/4-20 socket</i>                |
| 8. <i>1/4-20 socket (VM-210-FP only)</i> | 18. <i>V-mount</i>                      |
| 9. <i>Cold shoe mount</i>                | 19. <i>Battery terminals</i>            |
| 10. <i>LCD screen</i>                    | 20. <i>1/4-20 socket (VM-210-FP ×2)</i> |

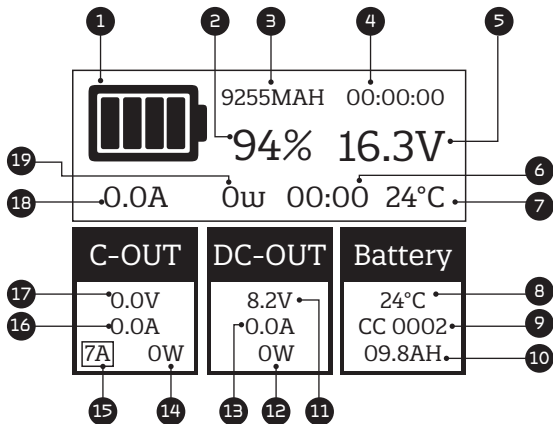

- |  |  |
|--|--|
| 1. <i>Battery indicator</i>            | 11. <i>DC port voltage</i>             |
| 2. <i>Battery percentage remaining</i> | 12. <i>DC port power</i>               |
| 3. <i>Real time battery capacity</i>   | 13. <i>DC port current</i>             |
| 4. <i>Timer</i>                        | 14. <i>USB-C port power</i>            |
| 5. <i>Battery voltage</i>              | 15. <i>Charge current (adjustable)</i> |
| 6. <i>Battery timer</i>                | 16. <i>USB-C port current</i>          |
| 7. <i>Battery temperature</i>          | 17. <i>USB-C port voltage</i>          |
| 8. <i>Battery temperature</i>          | 18. <i>Real time current</i>           |
| 9. <i>Cycle count</i>                  | 19. <i>Real time power</i>             |
| 10. <i>Battery capacity</i>            |  |

## CHARGING THE BATTERY

Use a USB-C cable to connect the battery's USB-C port to a power source.

When the battery is charging, the C-OUT banner will change to C-IN and the battery indicator will flash until the battery is fully charged.

## POWER BUTTON

**Press:** Power on.

**Rapid double press:** Cycles between C-Out (default), Charge Storage, and Calibration modes. See Operating Modes below.

**Note:** The first double-press will activate the ability to change modes. Additional double-presses will cycle through the modes.

**Long press:** Power off. When the battery does not output current, it will automatically shut off after 60 minutes.

## SET BUTTON

**Press and hold for 5 seconds:** Changes DC port voltage output from 8V (default) to 12V.

- When 12V output is activated, the DC OUT banner on the screen turns yellow and the LED indicator next to the DC port turns on.

**Press and hold for 5 seconds again** to return 8V output voltage.

**Rapid double press:** Sets the USB-C port charging current from 1 (1A) up to 7 (6.5A) and One-Way mode.

- The first rapid double-press activate the Change Current mode.
- Continue to double-press to adjust the current.
- After 7A output level, double-press to activate One-Way mode.
- The  icon will appear on the screen.
- Double-press again to cycle back to current level 1.

## BATTERY INDICATOR

The four-segment onscreen indicator displays the current charge: 100%, 75%, 50%, and 25%.

- The low voltage alarm will flash when the current drops below 8%.
- An indicator lights up when the current drops below 5% and flashes when the current is below 3%.

## CHANGE CHARGING CURRENT

Select the output current from 1A to 6.5A.

1. Quickly double-press the Set button to activate charging current change.
2. Continue to quickly double-press to select the output current from 1 (1A) to 7 (6.5A).

## CHARGE STORAGE MODE

**Important!** Charge Storage Mode is not available if the battery level is over 75%

In Charge Storage mode the battery automatically stops charging when the battery level reaches 75%, which is the recommended level for long-term battery storage.

1. Quickly double-press the power button to activate mode selection.
2. Continue to quickly double-press the power button to switch to Charge Storage (CHG STO) mode.

## ONE-WAY MODE

In One-Way mode the battery only outputs current from the USB-C port and prevents reverse charging. Select One-Way mode to charge another power source, like a battery, via the USB-C port.

1. Double-press the SET button to activate output level selection.
2. Double-press the SET button repeatedly to cycle through the output levels (1 through 7). After output level 7, an arrow appears onscreen to designate One-Way mode.

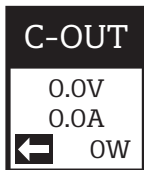

## CALIBRATION MODE

Use Calibration mode to recalibrate the battery's capacity readout and accurate battery percentage and battery time remaining readouts.

1. Quickly double-press the power button to activate mode selection. Continue to quickly double-press to switch to Calibration (CAL) mode.
2. Once in Calibration mode, discharge the battery at a current below 2A or less. See *Change Charging Voltage*. The battery will discharge until it automatically shuts down.
3. Turn on the battery. A yellow V will appear onscreen to indicate Calibration mode is activated.
4. Plug a cable into the USB-C port and connect it to a power source to begin charging. Charging current should not exceed 5A or the calibration will fail.
5. When the battery is fully charged, the calibration is done and CAL OK will appear onscreen.

**Note:** Do not plug gear into the battery during the charging process. Draining the battery will cancel Calibration mode.

## CHARGER MODE

In Charger mode, the battery can charge another V-mount battery. Maximum charging power is 90W.

1. Connect the battery's USB-C port to a power source.
2. Quickly double-press the power button to activate mode selection.
3. Quickly double-press again to switch to Charger mode.
4. Connect the charger mode battery's D-tap port and the target battery's D-tap port.
5. Quickly double-press the SET button to adjust the output current from 1 (1A) to 7 (6.5A).

## SPECIFICATIONS

	VM-140-FP	VM-210-FP
Mount Type	V-mount	V-mount
Chemistry	Li-ion	Li-ion
Output Voltage	14.8 V	14.8 V
Maximum Output	15 A	15 A
Capacity (Ah)	9.8 Ah	14.7 Ah
Capacity (Wh)	145 Wh	217 Wh
Accessory Port	USB Standard-A, USB Type-C, DC barrel, D-Tap	USB Standard-A, USB Type-C, DC barrel, D-Tap
Mounting	1/4-20 (×2)	1/4-20 (×4), Cold shoe
USB Output	15 A (continuous)	15 A (continuous)
DC Output	8 V / 12 V	8 V / 12 V
Power Delivery Charge	90 W	90 W
D-Tap Output	14.8 V	14.8 V
Power Delivery	3.0 (100 W)	3.0 (100 W)
PE+ (USB-A only)	1.1, 2.0	1.1, 2.0
Screen Type	LCD	LCD

**VM-140-FP****VM-210-FP**

USB Type-C Protocol	Apple: 5V/2.4A QC 2.0 / Huawei FCP: 5V, 9V, 12V QC 3.0: 12V Samsung AFC: 9V, 12V	Apple: 5V/2.4A QC 2.0 / Huawei FCP: 5V, 9V, 12V QC 3.0: 12V Samsung AFC: 9V, 12V
USB Standard-A Protocol	Apple: 5V/2.4A QC 2.0: 5V, 9V, 12V QC 3.0: 12V Samsung AFC: 9V, 12V Huawei FCP: 5V, 9V	Apple: 5V/2.4A QC 2.0: 5V, 9V, 12V QC 3.0: 12V Samsung AFC: 9V, 12V Huawei FCP: 5V, 9V
Built-in Protection	Discharge protection: short-circuit, cell, low- voltage, over-current, over-temperature  Charge protection: cell, over-voltage, over-current, over- temperature	Discharge protection: short-circuit, cell, low- voltage, over-current, over-temperature  Charge protection: cell, over-voltage, over-current, over- temperature
Operating Temperature	14°F to 104°F (-10°C to 40°C)	14°F to 104°F (-10°C to 40°C)
Operating Humidity	85%	85%
Weight	1.7 lb. (792 g)	2.5 (1146 g)
Dimensions	4.6 × 3.1 × 2.5 in. (11.7 × 7.9 × 6.3 cm)	4.6 × 3.1 × 3.2 in. (11.7 × 7.9 × 8.1 cm)

# ONE-YEAR LIMITED WARRANTY

This Watson product is warranted to the original purchaser to be free from defects in materials and workmanship under normal consumer use for a period of one (1) year from the original purchase date or thirty (30) days after replacement, whichever occurs later. The warranty provider's responsibility with respect to this limited warranty shall be limited solely to repair or replacement, at the provider's discretion, of any product that fails during normal use of this product in its intended manner and in its intended environment. Inoperability of the product or part(s) shall be determined by the warranty provider. If the product has been discontinued, the warranty provider reserves the right to replace it with a model of equivalent quality and function.

This warranty does not cover damage or defect caused by misuse, neglect, accident, alteration, abuse, improper installation or maintenance. EXCEPT AS PROVIDED HEREIN, THE WARRANTY PROVIDER MAKES NEITHER ANY EXPRESS WARRANTIES NOR ANY IMPLIED WARRANTIES, INCLUDING BUT NOT LIMITED TO ANY IMPLIED WARRANTY OF MERCHANTABILITY OR FITNESS FOR A PARTICULAR PURPOSE.

This warranty provides you with specific legal rights, and you may also have additional rights that vary from state to state.

To obtain warranty coverage, contact the Watson Customer Service Department to obtain a return merchandise authorization ("RMA") number, and return the defective product to Watson along with the RMA number and proof of purchase. Shipment of the defective product is at the purchaser's own risk and expense. For more information or to arrange service, visit [www.poweredbywatson.com](http://www.poweredbywatson.com) or call Customer Service at 212-594-2353.



Product warranty provided by the Gradus Group.

[www.gradusgroup.com](http://www.gradusgroup.com)

Watson is a registered trademark of the Gradus Group.

© 2025 Gradus Group LLC. All Rights Reserved.

GG4