



**We love that you are rocking JLab!**  
**We take pride in our products and fully stand behind them.**

JLAB  
 EPIC TALK USB  
 MICROPHONE



**YOUR WARRANTY**

All warranty claims are subject to JLab authorization and at our sole discretion. Retain your proof of purchase to ensure warranty coverage.



**CONTACT US**

Reach out to us at [support@jlab.com](mailto:support@jlab.com) or visit [jlab.com/contact](http://jlab.com/contact)

**REGISTER TODAY**

[jlab.com/register](http://jlab.com/register)

[Product updates](#) | [How-to tips](#)

**ASSEMBLY**

BASE ASSEMBLY

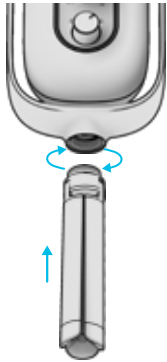

5/8" & 1/4" ASSEMBLY

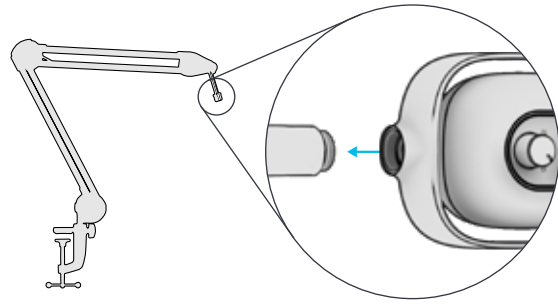
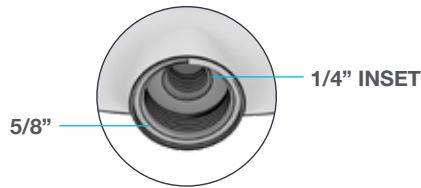

**SETUP**

**1** Connect to your PC or Mac USB INPUT.

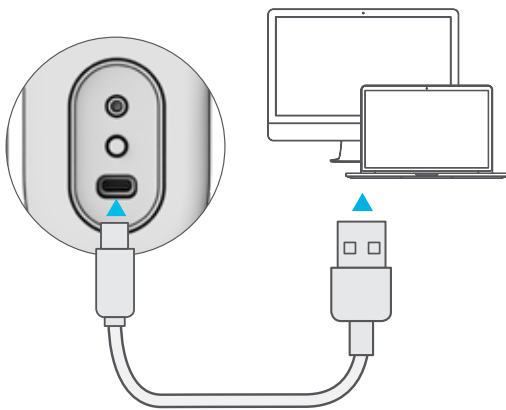

**2** Enter your PC or Mac settings to make sure connection is established.

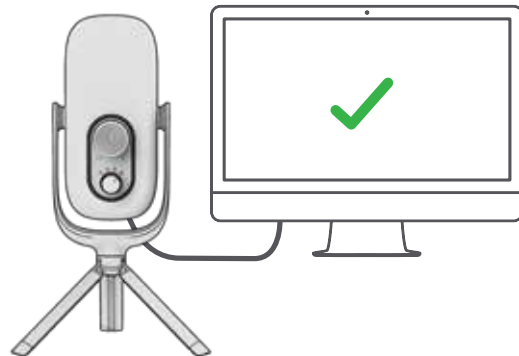

**SETUP EPIC TALK WITH PC (WINDOWS 7, 8, or 10)**

1. From the Start menu, select the Control Panel.
2. From the Control Panel, select the Sound icon.
3. Select the Recording tab and select "JLab Epic Talk".
4. Select the Playback tab and select "JLab Epic Talk".

**SETUP EPIC TALK WITH MAC (macOS 10.10 or HIGHER)**

1. Open System Preferences and select the Sound icon.
2. Select the Input tab and select "JLab Epic Talk".
3. Select Output tab and select "JLab Epic Talk".
4. From this screen, set the Output volume to desired level.

## CONTROLS

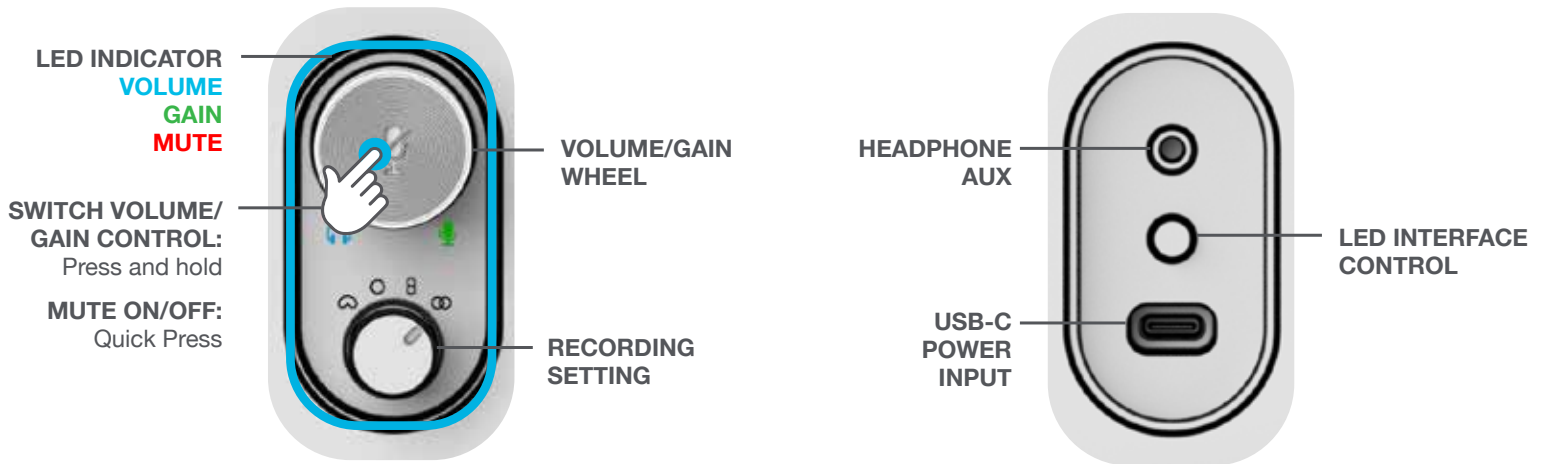

**CARDIOID**  
 Record front

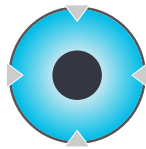

**OMNI**  
 Record all surroundings



**BIDIRECTIONAL**  
 Record front and back

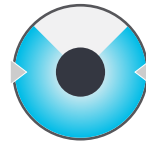

**STEREO**  
 Record front, left, and right

## LED INTERFACE

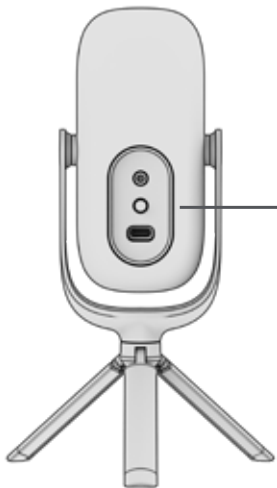

**TURN ON/OFF LED INTERFACE:**  
 Press and hold

**SWITCH LED INTERFACE:**  
 Quick Press



### INTERFACE LIST

- 1 COLOR FADE
- 2 COLOR WIPE
- 3 RAINBOW
- 4 BLUE
- 5 PURPLE
- 6 GREEN
- 7 CYAN
- 8 YELLOW
- 9 ORANGE
- 10 PINK
- 11 WHITE

## IN USE



Correct position



Incorrect position



## TIPS / TROUBLESHOOTING

- The Epic Talk works with almost any recording software installed on macOS, Windows, or Linux. Review in your software's setting and adjust accordingly.
  - No additional drivers/software are needed for the Epic Talk. Simply plug in and setup in device settings.
  - Epic Talk will not work through most tablets or mobile phones due to their power limitations. The output power source needs to produce 5v or greater to operate.
  - Epic Talk will not work through a power bank/battery pack. It will only work with USB-A input with an operating system.
  - If you are connecting through a USB hub or 3rd party adapter, make sure the product has the correct power output support and connection support.
  - Using external speakers for playback can cause microphone reverberation and echo. It is recommended to use headphones/earbuds for recording playback if this occurs.
- 



[Shop products](#) | [Product alerts](#) | [Burn-in your headphones](#)

JLab Store + Burn-in Tool

