

## Pole Mount RKM-130 with WM-1 Camera Mount

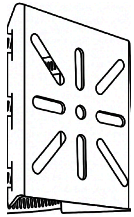

1 x Bracket Panel

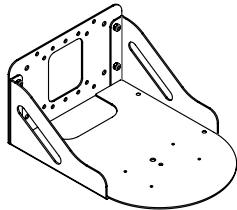

1 x Camera Mount

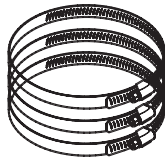

3 x Loop

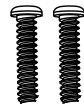

2 x M6-16  
Screws



2 x M6-1.0  
Nut

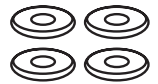

4 x 18-8  
Washer

### Tools Required

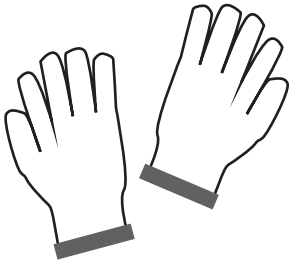

Protective gloves (recommended to avoid injury from sharp metal edges)

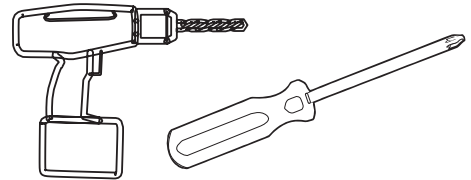

Phillips screwdriver or power drill

### Assembly Instructions

#### Step 1: Prepare for Installation

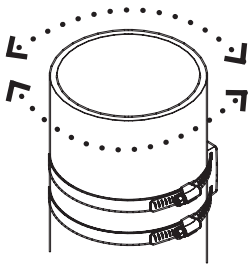

**A)** Choose a suitable pole within the bracket's compatible diameter range.



**B)** Ensure the surface is clean and free from debris for stable installation.

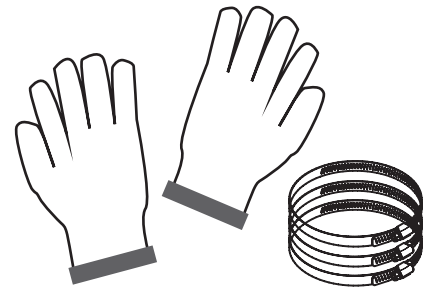

**C)** Wear protective gloves before handling the stainless-steel loops.

## Step 2: Attach the WM-1 to Bracket

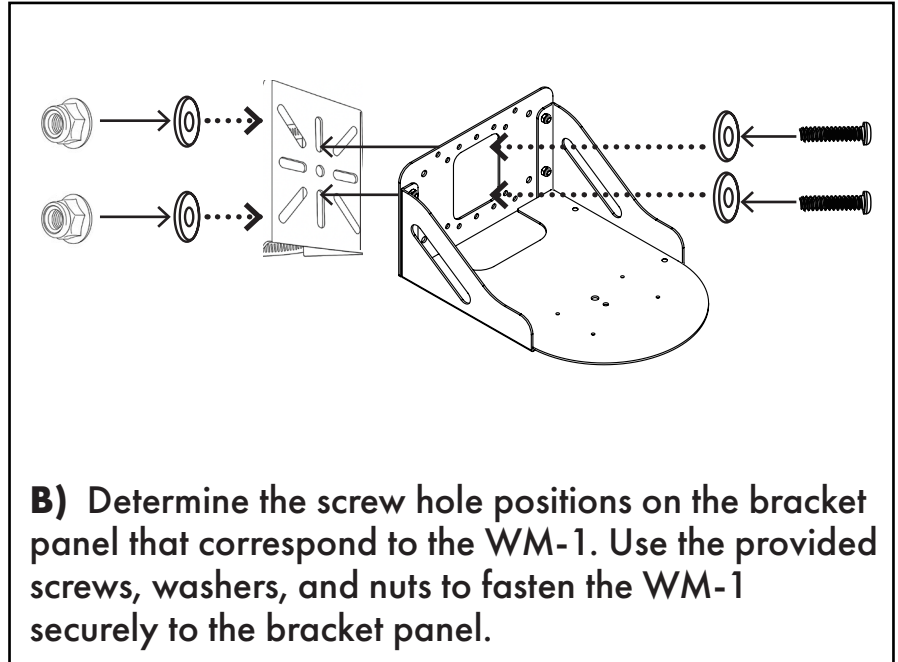
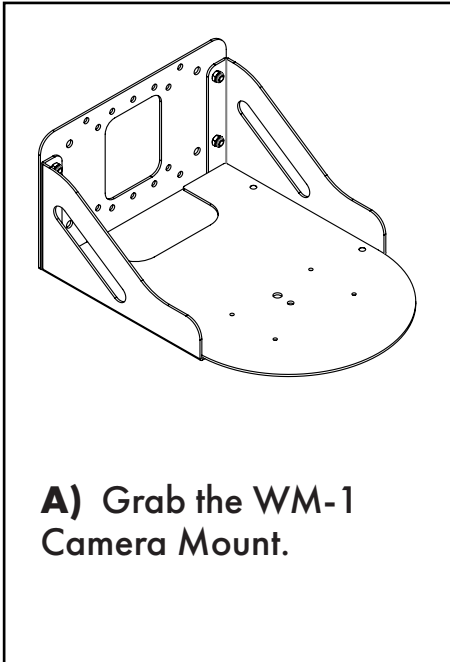

**Mounting should look like this.**

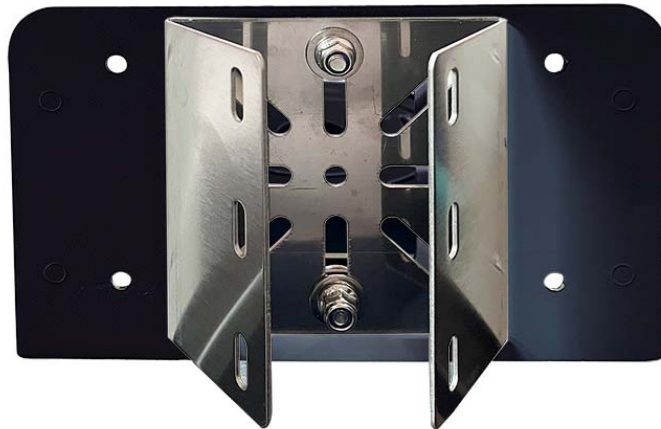

**C)** If needed, use cable ties to neatly manage and secure power or network cables. Once you are done, you can follow the WM-1 instructions to complete the mounting of the PTC series camera.

### Safety Notice

- The stainless-steel hoop edges are sharp—always wear gloves during installation.
- Ensure all screws and loops are tightened firmly to prevent movement or slippage.
- Verify that the pole is strong enough to support the total load of the bracket, WM-1 mount, and the PTZ camera.

### Step 3: Attach the Bracket to the Pole

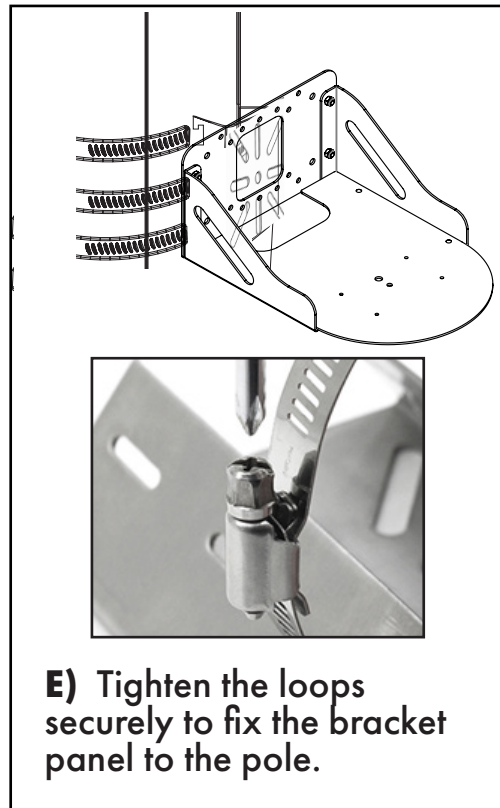
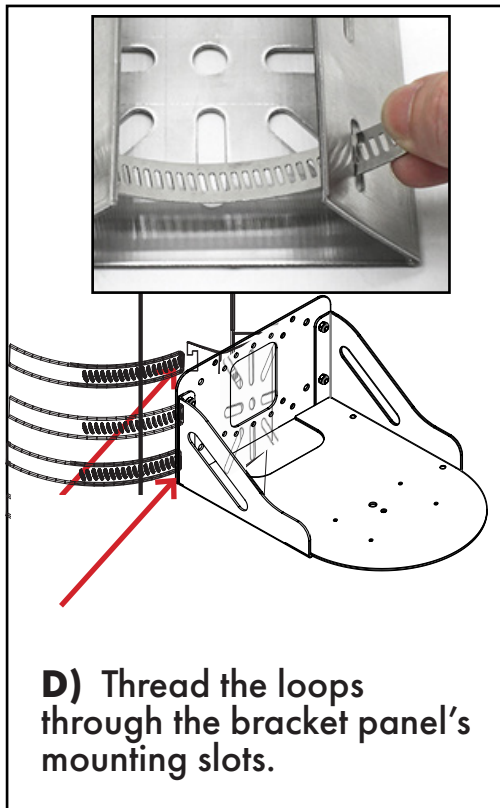
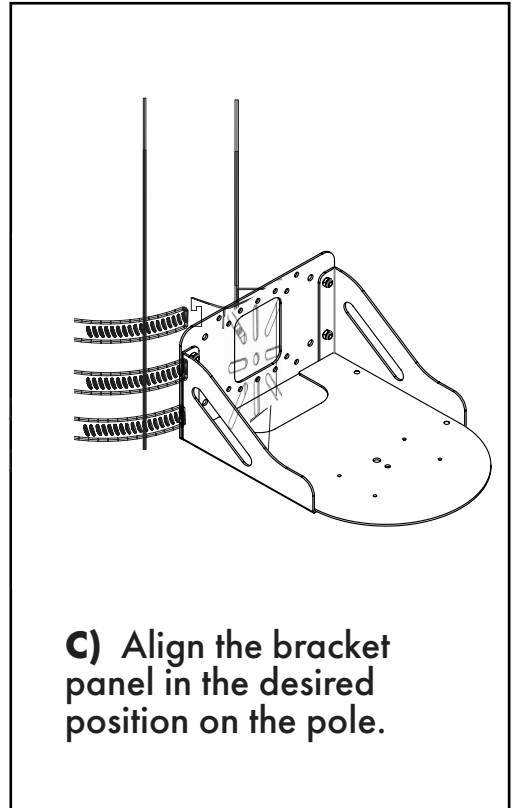
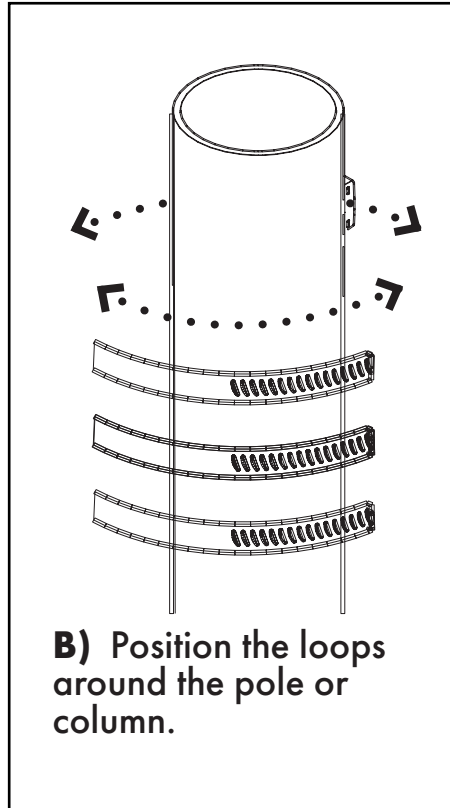
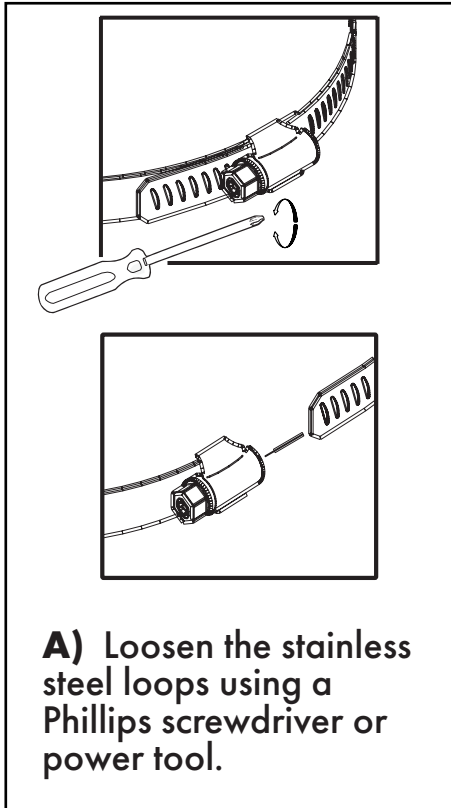

# Dimensions

# Measurements in millimeters (mm)

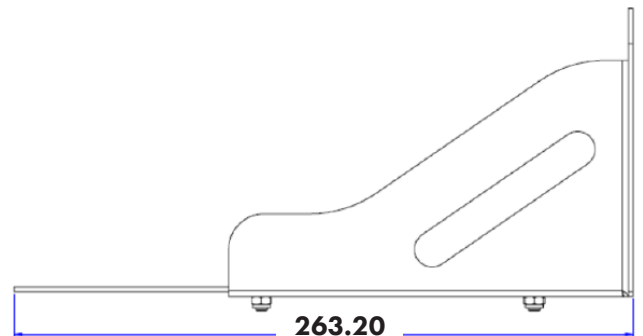
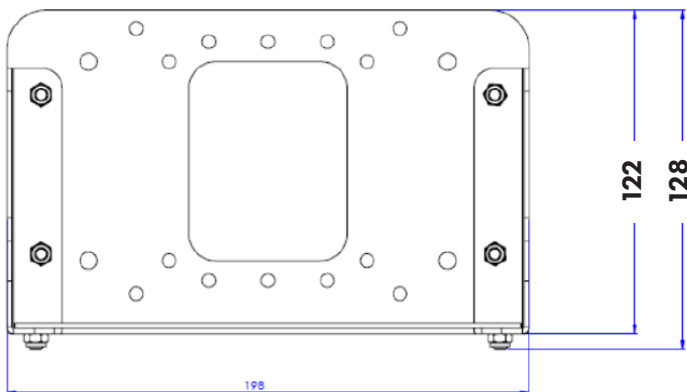
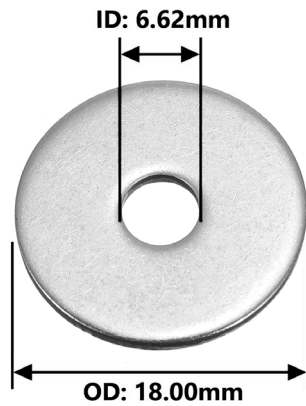
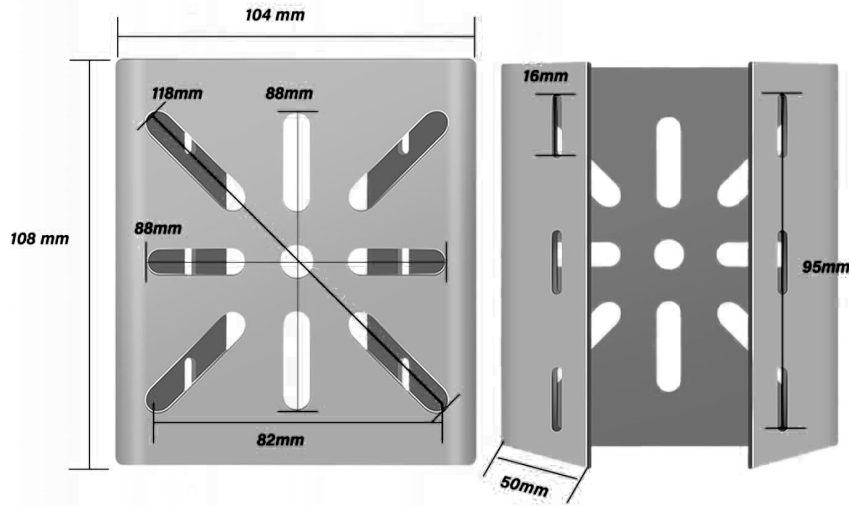

# WM-1 Quick Installation

## How to install Datavideo PTC-150\* to WM-1

**Step 1.** Mount assembled WM-1 to the wall.

**Step 2.** Secure the PTC-150\* to the Ceiling Bracket A plate (**Figure 1**) by screwing 3 screws as shown.

**Step 3.** Mount the Ceiling Bracket B plate to the WM-1 base as shown in **Figure 2**.

**Step 4.** Once the PTC-150\* is mounted to Bracket A plate, Slide it to Bracket B attached to the WM-1 base (**Figure 3**)

**Step 5.** Secure the camera to the A & B plates with 3 panhead screws as shown below. Then connect the cables through the rectangular hole on the WM-1 as shown below.

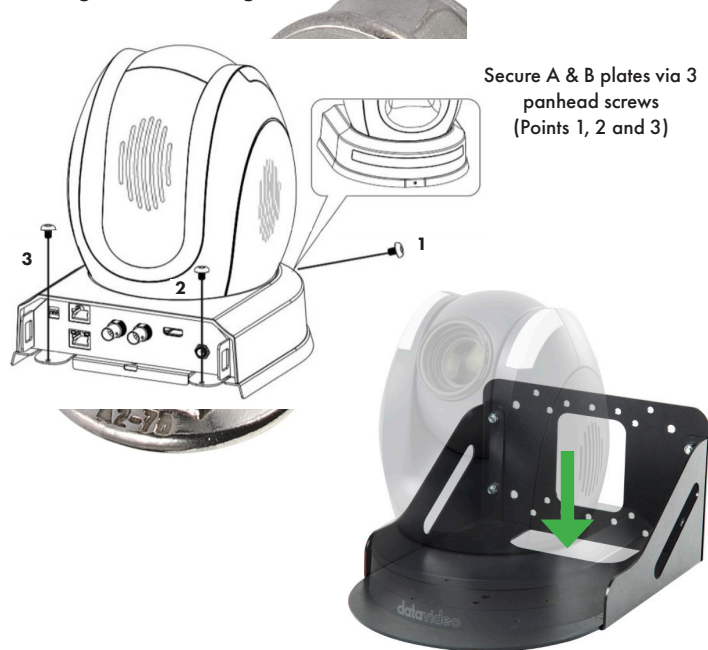

datavideo

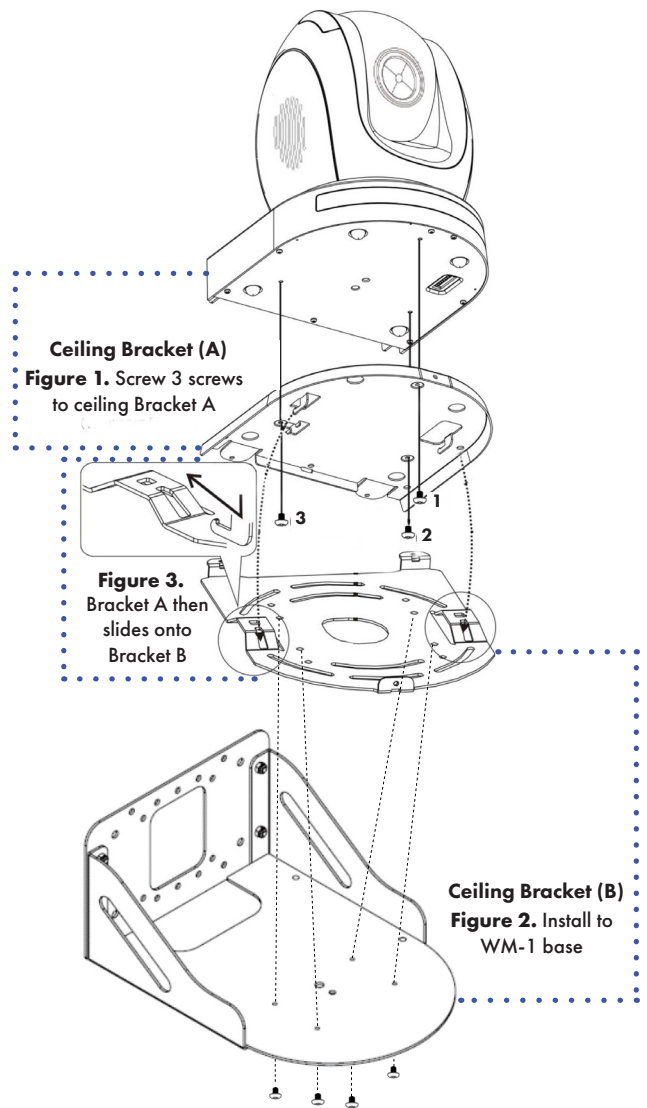

## Dimensions

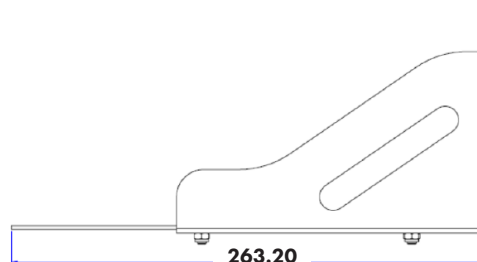
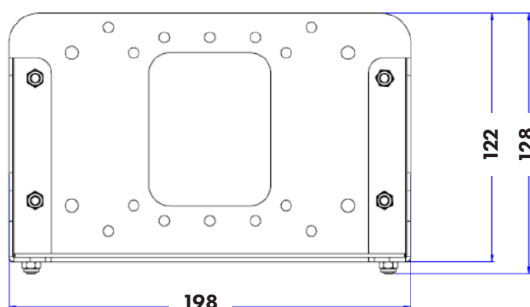

Measurements in millimeters (mm)