

Insta360 Luna Ultra

CO-ENGINEERED WITH 

User Manual



Contents

1. Product Overview.....	1
Luna Ultra Introduction.....	1
Standard Accessories.....	2
2. First-Time Use.....	4
Storage Space.....	4
Powering On/Off and Activating Your Camera.....	4
Charging.....	5
Storage.....	6
3. Basic Use.....	8
Buttons.....	8
Indicator Light.....	9
Touchscreen Operation.....	11
4. Using Luna Ultra.....	16
Selecting a Shooting Mode.....	16
Gimbal Modes.....	17
Auto Tracking and Smart Framing.....	18
QR Color Share.....	19
Shot Lab.....	20
Using the Touchscreen Remote.....	21
Connecting an External Microphone.....	22
Transferring Media Files.....	23
5. Accessory Ecosystem.....	26
Standard Accessories.....	26
Optional Accessories.....	28
6. Using the Insta360 App.....	30
Download.....	30

Connecting the Device.....	30
Auto Edit.....	31
7. Maintenance.....	32
Finding Your Serial Number.....	32
Firmware Update.....	33
Storage and Maintenance.....	34
8. Safety Information.....	35
Disclaimer.....	35
Battery Safety.....	35
Operational Safety.....	36

1. Product Overview

Luna Ultra Introduction

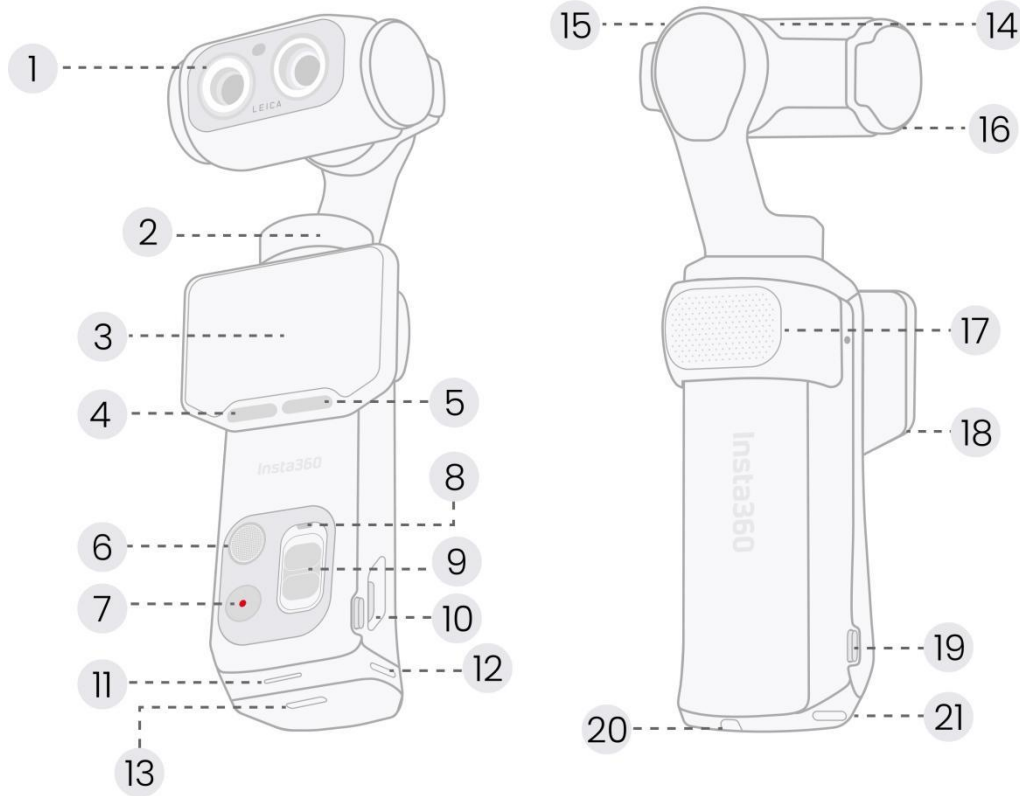

- | | |
|--------------------------|-----------------------------------|
| 1. Lenses and Sensor | 12. Mounting Latch |
| 2. Pan Axis Motor | 13. USB-C Port |
| 3. Touchscreen | 14. Ventilation Area |
| 4. Custom Button (Left) | 15. Roll Axis Motor |
| 5. Custom Button (Right) | 16. Tilt Axis Motor |
| 6. Joystick | 17. Wind Guard |
| 7. Shutter Button | 18. Detachable Touchscreen Remote |
| 8. Indicator Light | 19. Release Button |
| 9. Zoom Slider | 20. Lanyard Hole |
| 10. microSD Card Slot | 21. Mounting Latch |
| 11. Speaker | |



Do not manually adjust the gimbal axis motors while the device is powered off. If an axis lock accidentally disengages and the gimbal rotates out of position, turn the device on, then turn it off again. The system will automatically return the gimbal to its default position.

Standard Accessories

Please check the items inside the box based on the specific model and bundle version you purchased:

Items	Standard Bundle	Creator Bundle
Insta360 Luna Ultra	●	●
Protective Cover	●	●
Wind Guard	●	●
Wrist Strap	●	●
1/4" Thread Handle	●	●
Carry Bag		●
Battery Handle		●
Insta360 Mic Pro (TX)		●
Wide-Angle Lens		●

Symbol Descriptions:

● Indicates that the accessory is included in this bundle. A blank space indicates that it is not included.

Note: Only standard bundles are listed here. Available bundles may vary by channel. Please refer to the relevant sales channel for the latest bundle details.

2. First-Time Use

Storage Space

The device features **47GB** of built-in storage, allowing you to shoot directly out of the box. Users can also choose to insert a microSD card to expand the storage.

Installing an SD Card

1. Lift open the protective soft cover of the card slot.
2. Insert the microSD card into the slot in the direction shown.

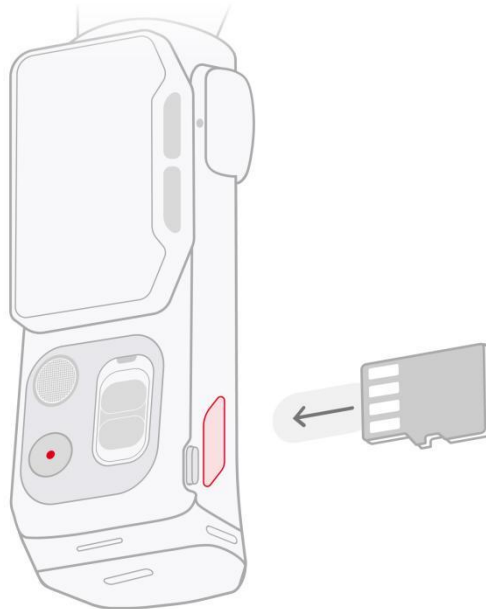

Powering On/Off and Activating Your Camera

You must activate the product via the Insta360 app before using it for the first time.

1. When the camera is powered off, you can turn on the device in two ways: 1) Rotate the screen to a horizontal position; 2) Press and hold the Shutter Button for 1s, which does not require rotating the screen.

2. Enable Bluetooth and Wi-Fi on your phone, then open the Insta360 app.
3. Follow the on-screen prompts in the app to search for and connect to your device. Once connected, follow the guide on the interface to complete the activation steps.
4. When the touchscreen displays the shooting page (Home Page), rotating the screen to a vertical position will trigger power-off. When other pages are displayed, it will only change the orientation of the interface.

Note: If the camera does not power on the first time, charge it continuously for at least 10 minutes before trying again.

Charging

- **Charging Method:** Use the included USB-C cable for charging. The device supports PD, QC, and DCP fast charging, with a maximum supported power of 15V/3A.
- **Charging Time:** 80% in 23 mins (15V 3A)*
*Tested in 77°F (25°C) lab environment, camera powered off with a PD3.0 PPS certified 45W USB-C charger. Charging time may vary under different conditions.
- **Status Checking:**
 - **Standby State:** The indicator light stays solid green. With the touchscreen remote attached, you can view the main gimbal's battery level via the icon in the upper-right corner of the shooting interface. Tap the icon to view the battery levels of the main gimbal and touchscreen remote separately.
 - **Powered-Off State:** When the charging cable is plugged in, the screen will display the charging progress for both the camera body and the detachable touchscreen remote. If the screen is off, tap once to display the charging progress.



Storage

When the camera is not in use, it can be stored directly into the standard protective cover after powering off. Proper storage effectively protects the gimbal lens and the screen.

Steps:

1. Power off the device and wait for the gimbal to fully rotate and retract into place. Avoid forcing the gimbal to prevent motor overload or damage.
2. Press the buckle to unlock and open the lens protective cover.
3. Place the camera into the protective cover with the screen facing inward toward the cover. As the button area protrudes slightly, please pay attention during insertion to avoid collision between the screen edges and the structure of the protective cover.
4. Fasten and lock the lens protective cover back in place.

Notes:

- Do not squeeze the gimbal during storage to avoid mechanical damage.
- If you have the wide-angle lens attached, refer to the lens's instructions for guidance on camera storage.
- If you want to start the camera and shoot more quickly, you can use the sliding protective case (sold separately).

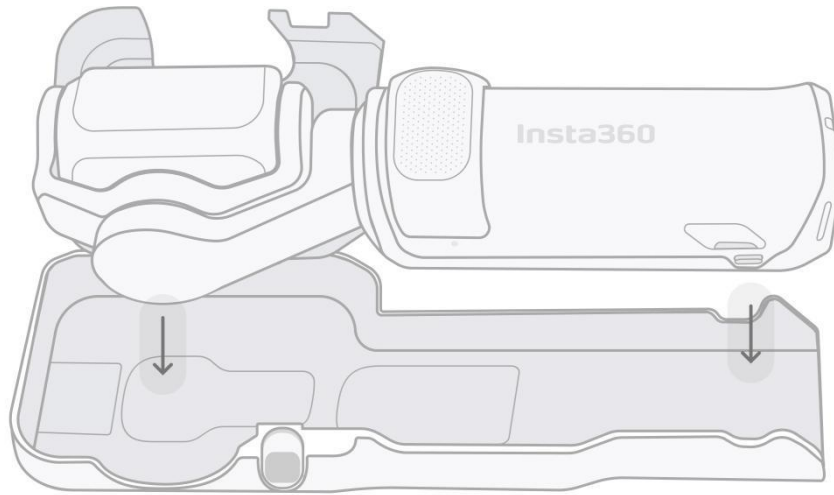

3. Basic Use

Buttons

Button	Operation	Function
Shutter Button	Short press	Take a photo and start/stop recording video.
	Long press	When powered off: Quickly power on and enter shooting mode. When powered on: Power off.
Joystick	Toggle up/down or left/right	Control the gimbal movement in the tilt or pan direction.
	Short press	Start/Cancel Auto Tracking.
	Long press	Enable Auto Tracking or Group Tracking depending on how many people are in front of the camera.
	Double click	Recenter the gimbal.
Zoom Slider	Triple click	Flip the gimbal.
	Push and hold	Smoothly zoom in or out of the image. The maximum magnification is 12×.
Custom Button (Left)	Quick push	Switch focal lengths.
	Short press	Flip the gimbal 180° (default.)
	Double	360 Panorama (default.)

	press	
	Long press	Press and rotate the screen to turn on the device, and the gimbal will automatically face the selfie direction.
Custom Button (Right)	Short press	Switch filters (default.)
	Double click	Recenter the gimbal (default.)

Tip: You can customize the Custom Button functions by swiping down to access the Shortcut Menu, swiping right, and selecting "Custom Buttons".

Indicator Light

The indicator light is located on the front of the device, displaying the current status of the device through different colors and blinking frequencies:

Basic

Status	Indicator Status
Standby	Solid green
Powering Off	Flashing red (fast)
Recording	Flashing red (slow)
Countdown Shooting	Flashing green
Firmware Upgrade	Flashing green (slow)

Power and Charging

Status	Camera Indicator Status	Battery Handle Indicator Status
Camera Charging	Solid orange	Solid orange
Camera Charging Completed	Off	Solid green
Handle battery level: High	No indicator	Solid green
Handle battery level: Medium	No indicator	Solid yellow
Handle battery level: Low	No indicator	Solid red
Handle battery depleted	No indicator	Flashing red (fast)

Abnormal Status and Troubleshooting

Device	Issue	Indicator Status
Camera	Storage/USB/Gimbal Abnormality	Solid yellow
	High/low temperature alert/Recording stopped due to insufficient microSD card write speed	Flashing yellow 3 times
	Battery too low/Charging	Flashing yellow 3 times

	abnormality	(repeated intermittently)
Battery Handle	Battery depleted	Flashing red

Touchscreen Operation

The device is equipped with a highly sensitive touchscreen. On the shooting Home Page, you can configure various settings by tapping and swiping.

Shooting Interface

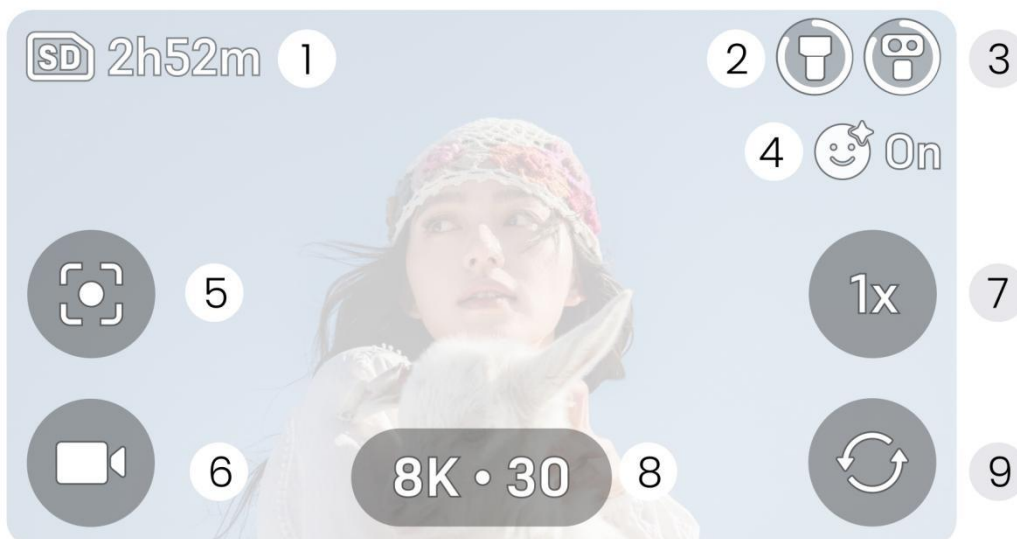

1. Storage: Shows the remaining recording time and photo capacity for current storage device.
2. Touchscreen remote battery status (displays only when the remote is detached).
3. Gimbal camera battery status.
4. Image settings.
5. Auto Tracking.
6. Shooting mode: Tap to change.

7. Focal lengths: Tap to change or press and hold for continuous zoom.
8. Shooting specifications.
9. Flip gimbal 180°.

Home Page Interactivity

- **Tap the screen:** Select a focus point or tap a feature icon.
- **Double-tap the screen:** Enable the "Auto Tracking" feature; the device will automatically lock onto and track the selected target. Tap anywhere on the screen to cancel.
- **Swipe in the center area of the screen:** Change shooting modes.
- **Rotate the screen:** Switch between landscape or portrait shooting (requires Adaptive Portrait/Landscape to be enabled in settings.)
- **Swipe from the edges of the screen:** Enter the corresponding interface depending on the swipe direction.

Swipe Down from the Top: Shortcut Menu

- **Storage Management (Swipe to the left):** Select internal storage or an external microSD card as the storage location, or format the storage space.
- **Screen Brightness:** Manually adjust the display brightness, or enable auto adjustment.
- **Prompt Sound:** Manually adjust the volume of prompt sounds or select mute.
- **Shooting Orientation:** Select Landscape, Portrait, or Adaptive Portrait/Landscape.
- **Settings:** View the serial number, configure Gesture Control, Wi-Fi settings, app connection, video bitrate, gimbal calibration, zoom speed, etc.
- **Gimbal Mode:** Select the appropriate gimbal mode for different scenarios to provide stable camera movement and a locked field of

view. For detailed descriptions, please refer to the "Gimbal Modes" section.

- **Audio Settings:** Select the audio recording device (choose between built-in microphone or an external audio device), enable/disable built-in audio sync, and configure sound effects.
- **Quick Capture:** Configure the wake-up action for quick capture when the camera is powered off. Options include "Rotate the screen" and "Slide down the case" (requires the sliding protective case). Once enabled, users can quickly power on and shoot using the last used mode.
- **Wireless Mic:** Add external audio recording devices such as the Insta360 Mic Pro and configure audio settings. It supports connecting up to two wireless microphones to the camera simultaneously.
- **Custom Button Settings:** Configure the custom buttons.
- **Accessories:** Connect and configure Bluetooth accessories.

Swipe Up from the Bottom: Shooting Specifications

Swipe to adjust the aspect ratio, clarity, and smoothness of the current shoot.

- **Shooting Orientation:** Select Landscape, Portrait, or Adaptive Portrait/Landscape.
- **Aspect Ratio:** Adjust the frame aspect ratio to suit different compositions or playback devices.
- **Landscape (When screen is horizontal):** Default is 16:9, switchable to 2.35:1 or 1:1. (Portrait ratios cannot be selected in this state.)
- **Portrait (When screen is vertical):** Default is 9:16, switchable to 1:1.
- **Resolution:** Adjust image quality. Higher resolutions provide richer details, while lower resolutions can extend recording time and save storage space.
- **Frame Rate:** Adjust the number of frames per second. High frame rates deliver smoother footage, making them ideal for post-producing slow-motion (overcranked) videos, while low frame rates save storage

space.

Swipe to adjust the shooting orientation, aspect ratio, clarity, and smoothness of the current shoot.

Swipe Right from the Left Edge: Album

Browse recorded videos and photos, with support for deleting, adding to favorites, and sending to your phone.

Swipe Left from the Right Edge: Image Settings

The camera provides two adjustment modes—Basic and Pro—to suit different usage needs:

- **Basic Mode:** Ideal for getting started quickly with simple operations. It mainly provides frequently used adjustments such as Beauty Mode effects, Filters, and Exposure, making it convenient for quick everyday shooting.
- **Pro Mode:** Ideal for experienced users, providing more advanced adjustment options. These include Color Modes (Standard, Dolby Vision, 10-bit I-Log), White Balance, Saturation, Sharpness, Contrast, etc., allowing for finer image control and greater post-production flexibility.

Feature	Description
Beauty Mode	Intelligent in-camera face recognition with adjustable tone and smoothing levels, so you can fine-tune your look.
Filters	Select different color profiles and filters, and adjust their intensity (Leica color profiles do not support intensity adjustment.)
Color Modes	Select between Standard, Dolby Vision, and 10-bit I-Log (provides wider color-grading space for captured footage, requiring post-production color grading.)

Exposure	<p>In Basic Mode: Adjust the exposure.</p> <p>In Pro Mode: Adjust the exposure, ISO, and shutter speed to handle overexposed or underexposed scenes. Additionally, some parameters can be set to auto while others are manual for highly efficient adjustments.</p>
White Balance	<p>Resolves color reproduction and color tone processing issues. Choose between a fixed color temperature or Auto White Balance (AWB).</p>
Metering Mode	<p>Face Priority prioritizes the face for brightness. Matrix ensures accurate exposure of the whole image.</p>
Focus Mode	<p>Select the camera's focus mechanism to suit different scenarios. Options include AF-C, AF-S, and Product Showcase.</p>
Breathing Compensation	<p>Minimizes changes in image magnification when focusing at different distances, delivering smoother and more natural focus transitions.</p>

Adjustable parameters vary depending on the shooting mode.

4. Using Luna Ultra

Selecting a Shooting Mode

Selecting a Mode

1. Tap the shooting mode button in the bottom left corner of the shooting page to enter the shooting mode switching page. You can also swipe left or right in the center of the screen to enter the switching page.
2. On the mode selection page, swipe left or right, or use the two custom buttons below the screen to change modes.
3. After selecting a shooting mode, tap the corresponding icon on the screen or wait a few seconds to complete the selection and return to the shooting page.

Shooting Modes

Shooting Mode	Description
Video	Standard video.
PureVideo	Ideal for low-light and nighttime shooting, delivering cleaner image quality with reduced noise.
Slow Motion	Shoot Slow Motion video with a high frame rate.
Timelapse	When camera is stationary, capture stunning time-lapse videos of sunrises, sunsets, and cityscapes.
TimeShift	When you're on the move, create dynamic hyperlapse videos of walks, drives, and other fast-paced journeys.
Panorama	Capture multiple photos and stitch them together to create either a 360 Panorama, or a 200MP Scenic Panorama.

Photo	Take a single photo. You can choose to capture 3-second Live Photos (Live Photos do not support UltraPhoto).
-------	--

Gimbal Modes

The device is equipped with a 3-axis mechanical gimbal that offers various gimbal modes to suit different shooting needs. Switching modes allows you to quickly adapt to handheld walking, sports tracking, or creative angles.

Available Gimbal Modes

- **Roll Lock:** Keeps the frame level. Ideal for daily vlogs.
- **Roll & Tilt Lock:** Keeps the frame level and tilt fixed. Ideal for dolly and pan shots.
- **FPV:** Follows handle movement in all directions. Ideal for creative shots.
- **FPV-V:** Follows handle movement in all directions. When recentered, the camera stays perpendicular to the handle.

Switching Modes

Swipe down from the top edge of the touchscreen to enter the shortcut menu, then tap Gimbal Mode to switch modes. After switching to a different mode, the gimbal will automatically center itself.

Speed Settings

Tap the icon in the top right corner of the Gimbal Mode page to configure the gimbal follow speed (only effective during recording) and joystick speed. Three options are available: Slow, Medium, and Fast.

- **Slow:** Best for shooting slow-moving landscapes or stationary subjects, delivering stable and smooth footage.
- **Medium:** Best for casual walking, travel vlogs, or everyday shooting.
- **Fast:** Best for capturing sports events, running pets, or quick transitions, and other action scenes.

Auto Tracking and Smart Framing

Auto Tracking

In modes that support tracking, you can enable tracking using any of the following methods:

- **Method 1:** Via Joystick. On the shooting page, push in the joystick. The system will automatically identify and lock onto the best subject in the frame to start tracking. Long press the joystick to enable Auto Tracking or Group Tracking depending on how many people are in front of the camera.
- **Method 2:** Via Touchscreen Double-Tap. Double-tap the subject you want to track on the screen to start tracking directly.
- **Method 3:** Via Feature Icon. Tap the tracking icon on the left side of the screen to perform the following actions:
 - **Single-Tap Selection:** Directly tap a pre-detected subject in the frame.
 - **Manual Selection:** Press and drag on the screen to draw a box around one or more subjects. (This method supports free tracking for any object that has not been pre-detected.)
 - **Auto-Tracking:** Once enabled, the camera detects trackable human subjects in the frame in real time. When the shutter button is pressed or tracking is triggered, the system automatically selects the largest subject closest to the center of the frame as the tracking target and begins auto-tracking. This is ideal for scenarios such as outdoor solo selfies. It is recommended to avoid overly crowded environments while shooting to ensure accurate tracking.

Adjusting Framing: While tracking, move the joystick to reposition the target within the frame.

Notes on Canceling and Losing Tracking Subjects

- **Manual Exit:** When tracking, single-tap anywhere on the screen to cancel.

- **Subject Lost:** If the subject is obstructed or leaves the frame, the box will turn yellow as the system attempts to reacquire it. In this state, the system applies different auto-cancel strategies based on the type of tracked subject:
 - For human subjects: The system will continue searching for the subject and will never automatically cancel tracking.
 - For pet subjects: If the subject is not reacquired within 10 seconds, the box will disappear and tracking will automatically cancel.
 - For other subjects: If the subject is not reacquired within 5 seconds, the box will disappear and tracking will automatically cancel.

Smart Framing

Tap the icon to preset your framing position using a 3×3 grid.

Customize Framing

While tracking, tap the Smart Framing button on the left side of the screen. You can then tap the screen or toggle the joystick to select a composition point, ensuring the tracked subject always remains positioned at that specific point.

Tips:

- Tracking performance may be limited in environments with rapid movement, obstructed subjects, or extremely low light.

QR Color Share

The device supports generating a unique QR code from your shooting parameters to share with others. By scanning the QR code, users can quickly apply the same parameters. This includes not only the basic filters but also detailed shooting parameters such as Beauty Mode effects, Filters, Color Mode, White Balance, etc.

Using QR Color Share

You can generate a QR code from the shooting parameters of your captured media and send it to your phone to create posters or share with

friends.

1. **Select Media:** Swipe right from the left edge of the camera screen to enter the Album page, then select the photo or video you want to share.
2. **Initiate Sharing:** Tap the More Options (...) icon on the screen and select Color Share.
3. **Share to Phone:** Tap Share to Phone on the detailed information page.
 - Turn on NFC on your phone and tap it below the camera screen to connect, or directly open the app to connect.
 - Keep the devices close to each other and wait for the transfer to complete.

Saving a QR Color Share Poster

Using the Insta360 app, you can transform your shooting parameters into a shareable poster.

1. **Receive Notification:** Once the transfer is complete, a notification will pop up in the app; tap it to enter.
2. **Save:** Tap Save Poster. The poster will include a QR code containing the shooting parameters of that photo or video.

Scanning a QR Code

You can scan a QR code from a poster shared by others to apply their shooting parameters to your camera with a single tap.

1. Swipe left from the right edge of the camera preview interface to enter the Image settings page.
2. Tap Profile in the top left corner, and then tap the Add (+) icon.
3. The camera will activate automatically. Scan the QR code on the poster, and the system will automatically import and apply the shooting parameters to your camera.

Shot Lab

The Shot Lab is the camera's built-in center for camera movement

inspiration. Through the Shot Lab, you can quickly apply preset shooting templates and explore inspirational examples of different shooting styles.

Operation Method

1. In the shooting mode switching page, tap the Shot Lab icon in the top right corner.
2. Select the camera movement you want to use. Options include Barrel Roll and Slow-Mo Live.
3. In Barrel Roll mode, the lenses rotate automatically after recording starts. In Slow-Mo Live mode, press the shutter button to capture a live photo that transitions from normal speed to slow motion.

Using the Touchscreen Remote

The device includes a detachable touchscreen remote that can also function as a standalone remote controller and microphone. This allows for long-distance previewing, parameter adjustment, and shooting control, making it ideal for scenes where you need to be away from the camera. It supports HD image transmission up to 20m*. Before use, ensure the remote has sufficient battery and is within the effective connection range of the camera.

Detaching/Attaching the Touchscreen Remote

1. Press and hold the release buttons on both sides of the touchscreen remote, and gently pull it outward to detach it.
2. Once detached, the remote maintains communication with the camera via a wireless connection, providing a real-time live preview.
3. Use the touchscreen or physical buttons on the remote to operate the camera (such as switching modes, adjusting exposure, or starting/stopping recording).
4. After shooting, reattach the remote to the camera body.

**Image transmission distance was tested over Wi-Fi in an open, unobstructed environment with no interference and the touchscreen remote detached. Actual performance may vary depending on device*

orientation, shooting settings, and other factors.

Using as a Wireless Microphone

The remote features a built-in microphone at the top and can also be used as a wireless microphone.



Connecting an External Microphone

For more professional audio recording, you can connect a wireless microphone (such as Insta360 Mic Pro). A wireless microphone can significantly improve vocal clarity and ambient audio quality, making it ideal for scenarios like interviews and vlogging. The device supports up to two wireless microphones. The following instructions use Mic Pro as an example.

Connecting the Receiver via an Adapter

1. Attach a USB-C adapter to the Mic Pro receiver and insert it into the USB-C port at the bottom of the camera.
2. The camera will automatically detect and switch to the external microphone input. Under Audio Settings, the recording device will

update to External Microphone.

Connecting the Transmitter via Bluetooth

1. Swipe down to enter the shortcut menu.
2. You can pair the wireless microphone through either of the two entry points: **Accessories** or **Wireless Mic**.
3. Triple-press the power button on the transmitter to enter pairing mode and complete the pairing process.

For more detailed instructions on using Mic Pro, please refer to the Mic Pro User Manual.

Transferring Media Files

After shooting, you can transfer files from the camera to your phone or computer in various ways for easy editing and sharing.

Transferring to a Phone

Via the Insta360 App

1. Open the Insta360 app and connect the camera (ensure Wi-Fi and Bluetooth are turned on).
2. Go to the **Album** page in the app and select the files you want to transfer.
3. Tap export or download to save them to your phone's system album or the app's media gallery.

Tap & Transfer

1. Turn on NFC on your phone. (Note: The NFC detection area varies by device; please check your phone before use.)
2. Place your phone's NFC detection area close to the camera's NFC area below the screen.
3. Tap the pop-up notification to open the Insta360 app.

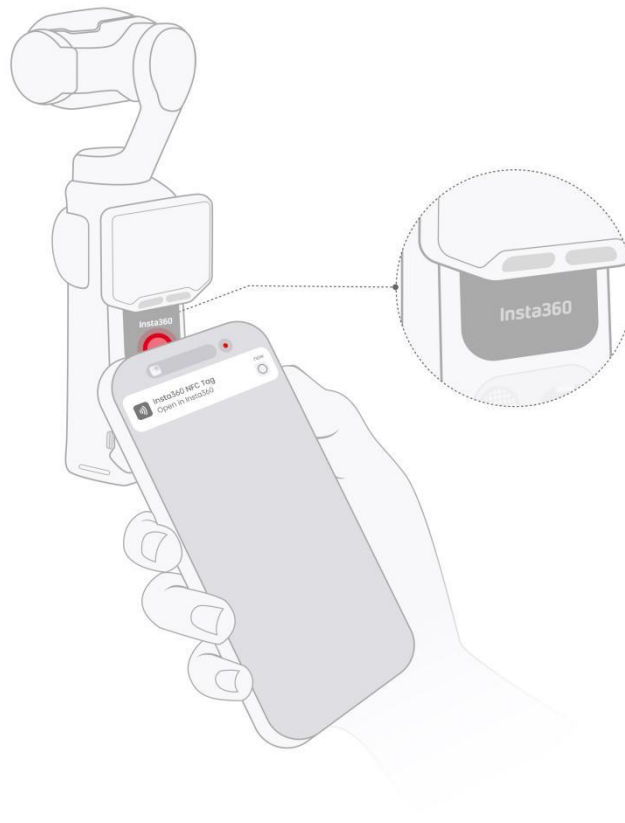

Note: Feature compatibility and the location of the phone's NFC area vary depending on the phone model.

Via USB-C Cable

1. Connect the camera to your phone using a USB-C cable.
2. A connection mode menu will pop up on the camera screen; select File Transfer.
3. Locate the camera storage in your phone's file manager, then copy the desired files to your phone.

Note: For iPhone, this feature only supports iPhone 15 and later models equipped with a USB-C port.

Transferring to a Computer

Via USB-C Cable

1. Connect the camera directly to your computer using a USB-C cable.
2. A mode selection menu will automatically pop up on the camera screen; select File Transfer.

3. The computer will recognize the camera as a removable storage device.
4. Open the camera folder and copy the desired photo and video files to your computer's local hard drive.

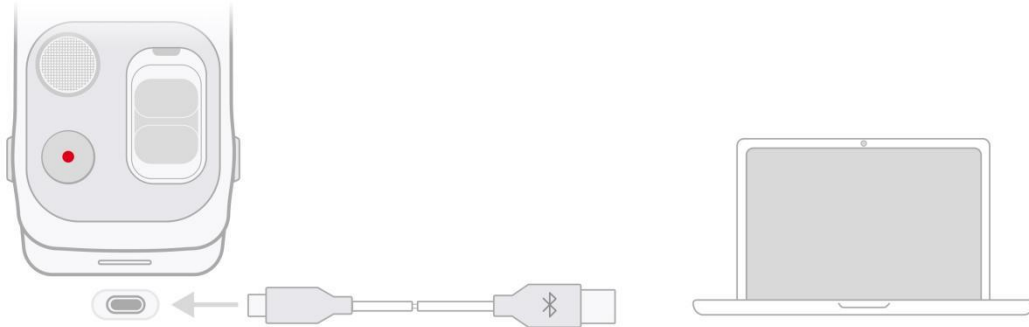

Via microSD Card

1. If a microSD card is used for storage, power off the camera and remove the microSD card.
2. Insert the microSD card into your computer (a card reader may be required depending on your computer's ports).
3. Copy the files directly to your computer.

Tips:

- It is recommended to power off the camera before removing the microSD card to prevent file corruption.
- Ensure the memory card is safely ejected from the computer before physical removal.

5. Accessory Ecosystem

Standard Accessories

This section introduces accessories that may be included in the standard bundle and their primary functions. Please refer to your purchased bundle to confirm included items.

Protection & Portability

- **Protective Cover:** Combines quick access with comprehensive protection. It fits the camera body snugly, providing targeted protection for core components. The internal space is designed to store the Insta360 Mic Pro (with back clip attached), Wide-Angle Lens, and Black Mist Filter, making it easy to carry everything on the go.

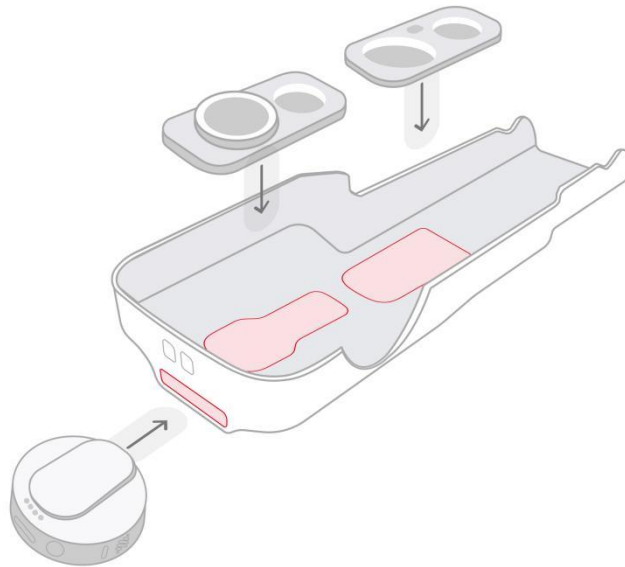

- **Wrist Strap:** Lightweight and comfortable to wear, it helps prevent accidental drops and reduces hand fatigue.
- **Carry Bag** (Creator Bundle exclusive): Water-resistant bag designed to hold your camera and essential accessories for on-the-go shooting. Includes adjustable dividers for customizable storage.

Handle Extension & Batteries

- **Battery Handle** (Creator Bundle exclusive): Featuring 1000mAh built-in

battery for charging cameras and mobile devices, and a built-in tripod for rapid deployment and stable capture. Features a standard 1/4" thread on the bottom for easy integration with other accessories.

Press and hold the release button to detach the Battery Handle. After detaching, press the release button once to check the battery level using the indicator lights.

Handle Status	Indicator Light Status
Charging	Solid orange
Fully charged	Solid green
Updating firmware	Flashing green
Press the release button once to check the battery level	
Battery 50–100%	Solid green for 3 seconds, then off
Battery 20–49%	Solid yellow for 3 seconds, then off
Battery 1–19%	Solid red for 3 seconds, then off
Battery 0%	Flashes red five times, then off
After the handle is attached to the camera, the camera enters tracking mode	
Tracking	Solid green
Tracking target lost	Solid yellow
Tracking stopped	Off

- **1/4" Thread Handle:** Multi-functional handle for Luna Series with built-in

tripod for rapid deployment and stable capture. Features a standard 1/4" thread on the bottom for easy integration with other accessories.

Lenses

- **Wide-Angle Lens** (Creator Bundle exclusive): Features a magnetic design for quick snap-on attachment. Once attached, it expands the field of view (FOV) to 108°, enabling a significantly wider angles.

Optional Accessories

Beyond the standard accessories included in the bundle, the following optional accessories can be purchased to expand creative possibilities and enhance shooting performance and image quality.

Creative POVs & Tracking

- **Neck Mount:** Features a secure closed-loop wearable design for hands-free shooting, allowing easy capture of first-person (POV) street photography or daily vlogs.
- **Magnetic Mount:** Attaches to the camera via the 1/4" Thread Handle. It folds for compact storage and expands into a selfie stick or tripod when needed.
- **POV Head Tracker:** A must-have hands-free shooting accessory that lets your Luna Ultra follow your gaze for effortless, high-quality first-person footage.

Imaging Optimization & Assistance

- **ND Filter Set:** Handles bright lighting with ND filters that reduce glare and enhance cinematic motion blur. Includes ND4, ND16, and ND64 filters to suit different lighting conditions and creative needs.
- **Black Mist Filter:** Softens highlights and reduces sharpness, creating a dreamlike, cinematic look. Magnetic design enables easy attachment.
- **Mini Fill Light:** Lightweight design for minimal added weight. Clips securely onto the camera body and supports quick magnetic attachment for effective low-light illumination.

Device Protection

- **Sliding Protective Case:** Easily slide up or down to switch between shooting and storage. Ideal for on-the-go use. When the device is off, it fully covers and protects the gimbal for added peace of mind during storage.
- **Crossbody Strap:** Features an adjustable length and anti-slip design for convenient carrying, whether used alone or with the protective case.

6. Using the Insta360 App

Download

Scan QR Code on Device

When powering on the device for the first time, you can scan the QR code on the camera screen to download the app (if the QR code does not appear in your current language, please visit the official website to download it).

Downloading from the Website

Go to the official Insta360 website. Click Downloads to download the app.

Connecting the Device

1. Power on the device.
2. Turn on Wi-Fi and Bluetooth on your phone.
3. Open the Insta360 app, tap the camera icon on the homepage to connect the device, and follow the on-screen prompts.

*For the first-time connection, you need to tap on the camera screen to confirm authorization.

Can't connect the camera to the Insta360 app? Try the following troubleshooting steps:

1. Ensure both the camera firmware and the app are updated to the latest versions, and that the Insta360 app has been granted the following permissions: network, Bluetooth, and local network.
2. Go to your phone's system settings to check if the Wi-Fi is connected.
 - If not connected, enter the Wi-Fi password, then restart both the camera and your phone before trying again.
 - If the connection still fails, go to the Wi-Fi settings page on your phone, find the camera's Wi-Fi network, forget this network and try connecting again.

3. Confirm that GPS and Bluetooth permissions have been enabled for the Insta360 app in your phone settings.
 - For Android users: Ensure that options like WLAN+ or Auto-Switch Wi-Fi are turned off (if available in your settings).
 - For iOS users: Go to your phone's system settings, locate Insta360, and check if Local Network permission is enabled.
4. Place the device close to your phone.

Auto Edit

Import your media, and the AI will automatically select templates, music, and transitions to generate a creative masterpiece with a single tap.

Operation Instructions

1. Power on the device, open the Insta360 app, and connect the device.
2. Tap the Edit page and select Auto Edit.
3. Select three or more media clips.
4. Wait for the app to analyze the video scenes and generate the video.
5. You can manually choose other templates or adjust the duration.
6. Export the video.

7. Maintenance

Finding Your Serial Number

Product Packaging

You can find the serial numbers of the camera and touchscreen remote on the back of the original product packaging.

Camera Settings

1. Power on your camera.
2. Swipe down from the top edge to enter the shortcut menu, then navigate to Settings > Camera Info to view the serial numbers of the camera and touchscreen remote.

Insta360 App

1. Connect your camera to the Insta360 app;
2. Enter Settings > Device Information to view the serial number.

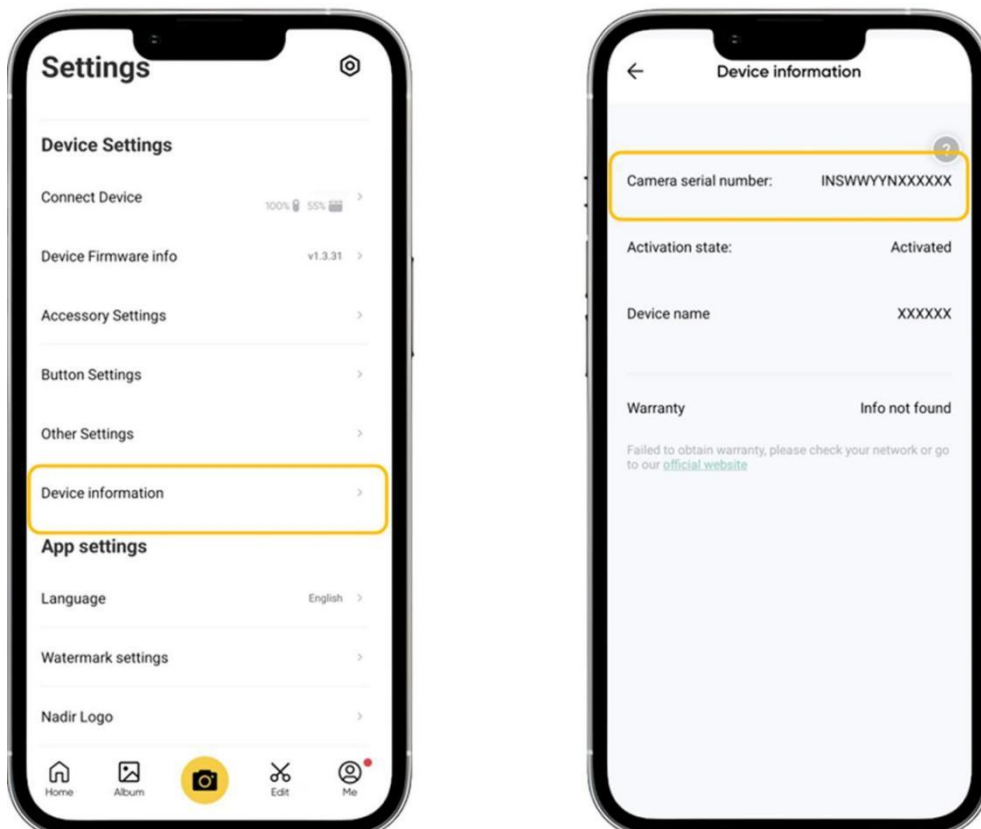

Firmware Update

Firmware updates will be released regularly to improve device performance and stability. Please update to the latest version for optimal results.

Before updating, ensure the device has at least 20% battery remaining. Do not power off the device or remove the touchscreen remote during the update process.

Update via Insta360 App

Connect the device to the Insta360 app. The app will notify you when a new firmware version is available. Follow the on-screen instructions to complete the update.

If the firmware update fails, check the following and try again:

1. Ensure the device is close to your phone.
2. Keep the Insta360 app running; do not exit or minimize it.
3. Ensure your phone has a stable network connection.

Once confirmed, restart the device and try updating again. If the issue persists, update using a computer.

Update via Computer

1. Ensure the device is powered on.
2. Connect the device to a computer using a USB-C cable, then select File Transfer in USB mode.
3. Download the latest firmware from the official website, then copy the update file to the root directory of the device storage. Do not rename the file.
4. Disconnect the device from the computer. The device will automatically detect the firmware file and begin updating. The indicator light will flash green slowly during the process.
5. Once the update is complete, the device will restart automatically.

Storage and Maintenance

1. Fully charge the product before use to help maintain battery health. If the product will not be used for 10 days or more, discharge it to around 50% to extend battery life. It is recommended to perform a full discharge and recharge cycle every three months.
2. Keep the product away from sand, dust, and other particulates. After use, store it in the Protective Cover to prevent damage and surface scratches. Avoid storing it with sharp objects such as keys.
3. Store the product in a dry environment to prevent condensation from forming inside the device.
4. Do not store the product near magnetic objects, as magnetic interference may cause unintended activation.
5. Ensure the USB-C port and metal contact points are clean and undamaged. Do not expose them to perfumes, cosmetics, or other chemicals, as residues may corrode metal surfaces and affect connectivity.
6. Clean the product only with a soft, dry cloth. Do not use liquid cleaning agents.
7. Ensure the Wind Guard on the back of the camera is free from dust or debris, as this may affect noise reduction performance. If necessary, clean it gently with a brush or soft cloth.

8. Safety Information

Disclaimer

By using this product, you acknowledge and agree to this disclaimer. Inspect the product before each use, and do not use it if it is damaged. Except for defects covered under applicable law, you are solely responsible for your actions and any consequences arising from the use of this product. To the extent permitted by law, Insta360 reserves the right to interpret and amend this disclaimer.

Battery Safety

1. The product is not water-resistant. The product should never come into contact with any kind of liquid. If the inside of the product is exposed to water, chemical decomposition may occur, potentially resulting in a battery fire or explosion.
2. The product should only be used in temperatures from 32°F to 104°F (0°C to 40°C). Low or high temperatures may shorten battery life or cause the product to temporarily stop working properly.
3. Do not charge the battery immediately after use, as the temperature may be too high. It is recommended to wait until the battery cools to room temperature before charging.
4. Do not leave the product near heat sources such as a heater, a cooker, or in a vehicle on a hot day.
5. Please charge the product before powering it on to prevent battery damage. Discharge the battery to around 50% if it will not be used for 10 days or more. This can greatly extend the battery life. It is recommended to fully discharge and then fully recharge the battery once every three months to keep it in good condition.
6. Use a power adapter that complies with the charging specifications. Remember to disconnect the camera once it is fully charged.

Operational Safety

1. Avoid dropping or damaging the product, as strong impacts may damage the gimbal.
2. Do not use the camera in extreme weather conditions such as heavy storms.
3. The product is intended for handheld filming. Do not use it during high-intensity activities such as motorcycling, cycling, or skiing.
4. Hold the product steady and ensure the gimbal can rotate freely during power-on to ensure successful startup.
5. Do not manually force the gimbal axis motors while the device is powered off. If an axis lock is accidentally disengaged and the gimbal rotates out of position, power the device on and then off again. The system will automatically return the gimbal to its default position.
6. Ensure the Detachable Touchscreen Remote is securely attached to prevent damage from accidental drops.
7. The Detachable Touchscreen Remote supports preview transmission up to 66ft (20m) in open, interference-free environments.
8. Avoid sudden changes in temperature or humidity, as condensation may form on or inside the product.
9. Keep the product away from sand, dust, and other particulates.
10. After use, store the product in the Protective Cover to help prevent damage and scratches. Avoid storing it with sharp objects such as keys.
11. Store the product in a dry environment to help prevent internal condensation.
12. Do not store the product near magnetic objects, as magnetic interference may cause unintended activation.
13. Ensure the USB-C port and metal contact points on the product are clean and undamaged. Do not expose them to perfumes, cosmetics, or other chemicals. Chemical residue may corrode metal surfaces,

resulting in poor connectivity.

14. Clean the product only with a soft, dry cloth. Do not use liquid cleaning agents.
15. Do not disassemble or attempt to repair the product yourself.
16. Do not drop, strike, or place heavy objects on the product.
17. Keep the Wind Guard away from children to prevent accidental swallowing.
18. Ensure the Wind Guard on the back of the camera is free from dust or debris, as this may affect noise reduction performance. If necessary, clean it gently with a brush or soft cloth.
19. Avoid contact between the camera and dark clothing or cosmetic products such as creams, lotions, and makeup, as discoloration may occur.
20. Surface scratches on the zoom slider after extended use are normal and will not affect functionality.
21. The camera contains magnets. Keep it away from pacemakers and other devices sensitive to magnetic interference.

Arashi Vision Inc.

ADD: 11th Floor, Building 2, Jinlitong Financial Center, Bao'an District, Shenzhen,
Guangdong, China

WEB: www.insta360.com

TEL: 400-833-4360 +1 800 6920 360

EMAIL: service@insta360.com

NOTE: This manual is subject to change without notice. Please visit [Insta360's official website](#) for the latest version.

VI.1