

SHARP®

AQUOS

LC-32LE265M LC-40LE265M

LED BACKLIGHT TV

OPERATION MANUAL



Dear SHARP customer

Thank you for your purchase of the SHARP LCD colour TV product. To ensure safety and many years of trouble-free operation of your product, please read the Important Safety Precautions carefully before using this product.

Important Safety Precautions

- Stand base must be attached to prevent the TV set from falling down and cause injuries.
- Cleaning — Unplug the AC cord from the AC outlet before cleaning the product. Use a soft damp cloth to clean the product. Do not use liquid cleaners, aerosol cleaners or chemical cloth to clean it, as such materials may damage the product.
- Water and moisture — Do not use the product near water, such as bathtub, washbasin, kitchen sink, laundry tub, swimming pool and in a wet basement.
- Do not place vases or any other water-filled containers on this product. The water may spill onto the product causing fire or electric shock.
- Stand — Do not place the product on an unstable cart, stand, tripod or table. Doing so can cause the product to fall, resulting in serious personal injuries as well as damage to the product. Use only a cart, stand, tripod, bracket or table recommended by the manufacturer or sold with the product. When mounting the product on a wall, be sure to follow the manufacturer's instructions. Use only the mounting hardware recommended by the manufacturer.
- When relocating the product placed on a cart, it must be moved with utmost care. Sudden stops, excessive force and uneven floor surface can cause the product to fall from the cart.
- Ventilation — The vents and other openings in the cabinet are designed for ventilation. Do not cover or block these vents and openings since insufficient ventilation can cause overheating and/or shorten the life of the product. Do not place the product on a bed, sofa, rug or other similar surface, since they can block ventilation openings. This product is not designed for built-in installation; do not place the product in an enclosed place such as a bookcase or rack, unless proper ventilation is provided or the manufacturer's instructions are followed.
- The LCD panel used in this product is made of glass. Therefore, it can break when the product is struck forcefully or with a sharp object. If the LCD panel is broken, be careful not to be injured by broken glass.
- Heat sources — Keep the product away from heat sources such as radiators, heaters, stoves and other heat-generating products (including amplifiers).
- To prevent fire, never place any type of candle or naked flames on the top or near the TV set.
- To prevent fire or shock hazard, do not place the AC power cord under the TV set or other heavy items.
- Do not place heavy objects on this product or stand on it. Doing so could cause injury if the product overturns. Take special care near children and pets.
- The LCD panel is a very high technology product with 1,049,088 (only for LC-32LE265M)/2,073,600 (only for LC-40LE265M) pixels, giving you fine picture details. Due to the very large number of pixels, occasionally a few non-active pixels may appear on the screen as a fixed point of blue, green or red. This is within product specifications and does not constitute a fault.
- **Precautions when transporting the TV**
When transporting the TV, never carry it by holding or otherwise putting pressure onto the display. Be sure to always carry the TV by two people holding it with two hands — one hand on each side of the TV.
- Do not display a still picture for a long time, as this could cause an afterimage to remain.
- Install the product on the place where the AC cord can be unplugged easily from the AC outlet.

Supplied accessories

Remote control unit



Operation manual



"AAA" size battery (x 2)

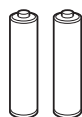

Stand unit

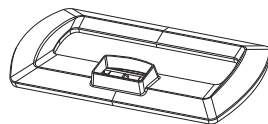

Stand base



Supporting post



Screws (x 8)

Contents

	Page		Page
Supplied accessories	1	Programme setup	7
Dear SHARP customer	2	Picture menu	8
Important Safety Precautions	2	Audio menu	9
Trademarks	2	ECO menu	10
Attaching the stand	3	Setup menu	10
Antenna connection	3	Option menu	11
Connecting external devices	4	ECO mode	11
Remote control unit	5	Colour adjustment and still image ...	12
Part names	6	Timer.....	12
Turning the TV on/off	6	Using a Smartphone with the TV	12
Initial auto installation	7	USB Media Player	13
Selecting a preset AV mode	7	Appendix	15
Menu operation	7	Specifications	16

Trademarks

- The terms HDMI and HDMI High-Definition Multimedia Interface, and the HDMI Logo are trademarks or registered trademarks of HDMI Licensing LLC in the United States and other countries.
- MHL, the MHL Logo, and Mobile High-Definition Link are trademarks or registered trademarks of MHL, LLC in the United States and other countries.

Attaching the stand

- Before attaching (or detaching) the stand, unplug the AC cord from the AC outlet.
- Before performing work spread cushioning over the base area to lay the TV on. This will prevent it from being damaged.

1 Confirm the screws supplied with the TV.

Screws (x 8)



- 2 Fix the supporting post into the holes on the rear of the TV. (1)
Insert and tighten the four screws into the holes. (2)
- 3 Insert the stand base to the stand post on the bottom of the TV. (3)
- 4 Insert and tighten the screws into the holes on the rear of the TV. (4)

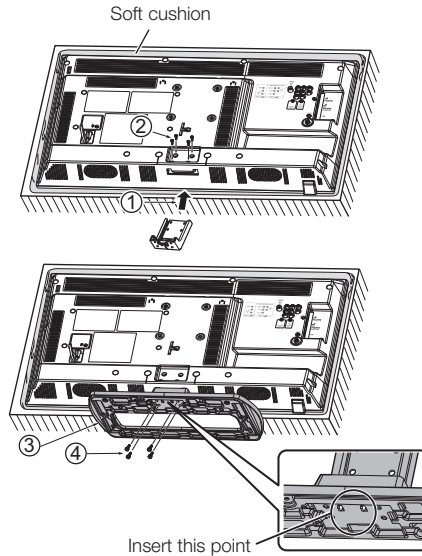

NOTE

- To detach the stand, perform the steps in reverse order.

CAUTION

- Do not attach or detach the stand without holding it. Doing so can cause the stand to fall, resulting in serious personal injuries as well as damage to the stand.

Antenna connection

Connect antenna cable to the antenna terminal

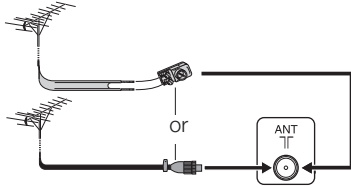

If your outdoor antenna uses a 75-ohm coaxial cable with a standard DIN45325 plug (IEC 169-2), plug it into the antenna jack at the rear of the set.

If your outdoor antenna uses a 300-ohm twin-lead flat feeder, connect a 300-ohm to 75-ohm impedance converter and plug it into the antenna jack at the rear of the set.

CAUTION

- TO PREVENT RISK OF ELECTRIC SHOCK, DO NOT TOUCH UN-INSULATED PARTS OF ANY CABLES WITH THE AC CORD CONNECTED.

NOTE

- Place the TV close to the AC outlet, and keep the power plug within reach.

• The illustrations used throughout this manual are based on LC-32LE265M.

Connecting external devices

You can connect many types of external equipment to your TV, like a VCR, game console, camcorder, DVD player, Digital TV STB (Set Top Box) and PC. To view external source images, select the input source from **INPUT** on the remote control unit or **INPUT** on the TV.

CAUTION

- To protect all equipment, always turn off the TV before connecting to a VCR, game console, camcorder, DVD player, Digital TV STB (Set Top Box), PC or other external equipment.
- Refer to the relevant operation manual (VCR, DVD player, etc.) carefully before making connections.

Connecting a VCR, game console or camcorder

A VCR, game console, camcorder and some other audiovisual equipment can be conveniently connected using the INPUT 3 or INPUT 4 terminals.

When using component cable (commercially available)

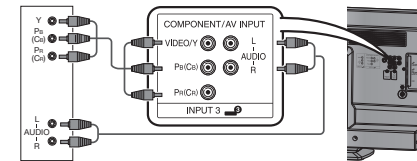

VCR/Game console/Camcorder

When using composite cable (commercially available)

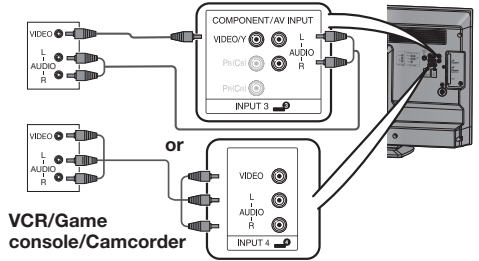

VCR/Game console/Camcorder

Connecting a DVD player/Digital TV STB (Set Top Box)

You can use the INPUT 1 (HDMI)/INPUT 2 (HDMI/MHL) or INPUT 3 terminals when connecting to a DVD player/Digital TV STB (Set Top Box) and other audiovisual equipment.

When using HDMI-certified cable (commercially available)

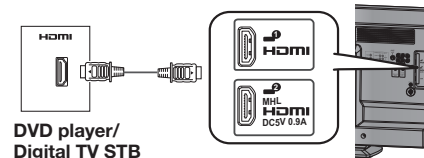

DVD player/Digital TV STB (Set Top Box)

When using component cable (commercially available)

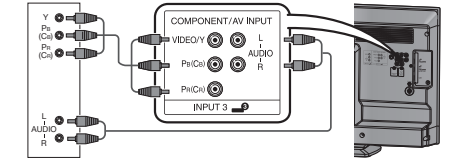

DVD player/Digital TV STB (Set Top Box)

Connecting a PC

You can use the INPUT 1 (HDMI)/INPUT 2 (HDMI/MHL) terminal when connecting to a PC.

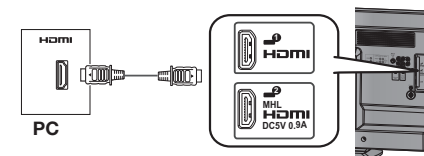

PC

Connecting a USB device

Connect a USB device to the TV.

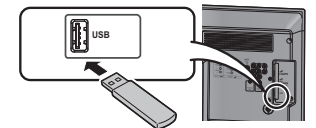

CAUTION

- Do not disconnect a USB device from the TV while transferring files, when a screen is in "USB" mode.

• The illustrations used throughout this manual are based on LC-32LE265M.

Remote control unit

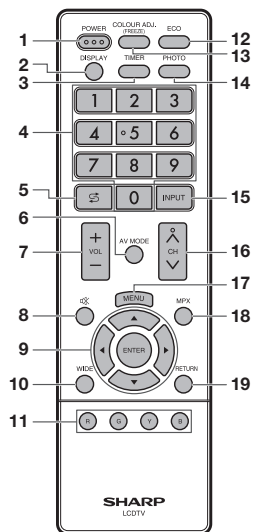

- 1 POWER (STANDBY/ON)**
To switch the power on and off. (See page 6.)
- 2 DISPLAY**
Display the channel or input information.
- 3 TIMER**
Set the Sleep Timer and Reminder. (See page 12.)
- 4 0 - 9**
Set the channel.
- 5 ⏮ (Flashback)**
Press ⏮ to return to the previous selected channel or external input mode.
- 6 AV MODE**
Select an audio and video setting. (See page 7.)
- 7 VOL + /VOL -**
Set the volume.
(VOL +) Increase the volume.
(VOL -) Decrease the volume.
- 8 ⏸ (Mute)**
Press ⏸ → Mutes sound.
Press ⏸ again → Restores sound.
Mute will be cancelled after 30 minutes. However, the TV will not suddenly output loud sound as the volume level will be set to 0 automatically. Increase the volume level by pressing VOL +.
- 9 ▲/▼/◀/▶ (Cursor)**
Select a desired item on the setting screen.
- 10 WIDE**
Change the wide image mode. (See page 9.)
- 11 Colour (Red/Green/Yellow/Blue)**
The coloured buttons are correspondingly used to select the coloured items on the screen.
- 12 ECO**
Reduce overall power consumption based on user preferences. (See page 12.)
- 13 COLOUR ADJ. (FREEZE)**
Freeze a motion picture on the screen and adjust the colour tone of the still image. (See page 12.)
- 14 PHOTO**
Display your pictures directly on the TV screen. (See page 13.)
- 15 INPUT (INPUT SOURCE)**
Select an input source.
- 16 CH ▲/CH ▼**
TV input mode: Select the channel.
(CH ▲) Increase the channel number.
(CH ▼) Decrease the channel number.
- 17 MENU**
Display the menu screen.
- 18 MPX**
Select the sound multiplex mode.
- 19 RETURN**
MENU mode: Return to the previous menu screen.

Inserting the batteries

Before using the TV for the first time, insert two “AAA” size batteries (supplied). When the batteries become depleted and the remote control fails to operate, replace the batteries with new “AAA” size batteries.

- 1** Open the battery cover.
- 2** Insert the two supplied “AAA” size batteries.
- 3** Close the battery cover.

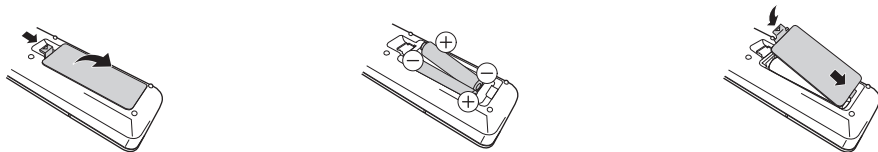

- Place batteries with their terminals corresponding to the (+) and (-) indications in the battery compartment.



- Batteries (battery pack or batteries installed) shall not be exposed to excessive heat such as sunshine, fire or the like.

Part names

TV (Front)

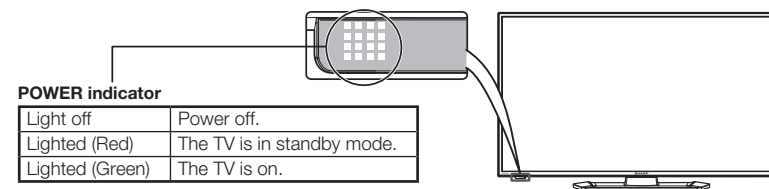

TV (Rear)

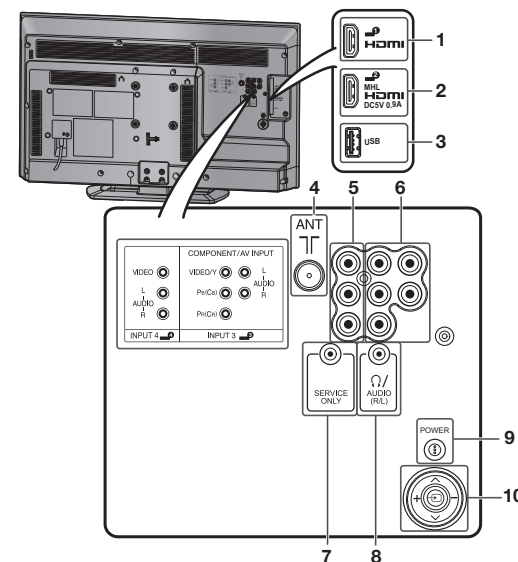

- 1** INPUT 1 (HDMI) terminal
- 2** INPUT 2 (HDMI/MHL) terminal
- 3** USB terminal*
- 4** Antenna input terminal
- 5** INPUT 4 terminals
- 6** INPUT 3 (COMPONENT/AV INPUT) terminals
- 7** SERVICE ONLY terminal**
- 8** Ⓜ/AUDIO output (R/L) terminal
- 9** POWER (On/Off) button
- 10** Keypad control

JOG-KEY	BASIC FUNCTION	FUNCTION DURING MENU
▲	CH UP	▲
▼	CH DOWN	▼
+	VOL UP	+
-	VOL DOWN	-
↶ (BELOW 1 SEC)	INPUT	SELECT/ENTER
↶ (1 SEC AND OVER)	MENU	RETURN/MENU EXIT

* Repeat keys

* USB terminal use for USB Media Player. (See page 13.)

** Usually do not connect anything to this terminal as it is reserved only for service personnel.

- The illustrations in this operation manual are for explanation purposes and may vary slightly from the actual operations.
- The illustrations used throughout this manual are based on LC-32LE265M.

Turning the TV on/off

Turning on/off the power

- To turn on the power**
Press **POWER** on the TV. (After a few seconds, an image appears with sound.)
- To turn off the power**
Switch it off by pressing **POWER** on the TV.

NOTE

- If you are not going to use this TV for a long period of time, be sure to remove the AC cord from the AC outlet.
- Minor power is consumed when the unit is in standby mode.

Standby mode

- To standby mode**
If the TV is switched on, you can switch it to standby by pressing **POWER** on the remote control.
- Switching on from standby**
From standby, press **POWER** on the remote control.

Initial auto installation

When the TV powers on for the first time after purchase, the initial auto installation wizard appears. Follow the menus and make the necessary settings one after another.

- 1 Press **POWER** on the TV.
 - The initial auto installation wizard appears.
- 2 Press **▲/▼** to select the desired language, and then press **ENTER**.
- 3 Press **▲/▼** to select "HOME" or "STORE", and then press **ENTER**.
 - Auto installation will be executed.
 - You do not need to do anything during the auto search.

NOTE

- HOME mode: Settings are optimised for normal home viewing and energy efficiency.
- STORE mode: Settings are designed for maximum impact in retail store displays.
- To change the STORE mode to HOME mode, please refer to page 10 to reset the unit.

Selecting a preset AV mode

"AV mode" gives you several viewing options to choose from to best match the system environment, which can vary due to factors like room-brightness, type of programme watched or the type of image input from external equipment.

- 1 Press **AV MODE**.
- 2 Each time you press **AV MODE**, the mode changes.
 - You can also switch the mode in the "AV mode" menu on the "Picture" and "Audio" menu screen.

Selected item	Description
STANDARD	For a highly defined image in a normally bright room.
MOVIE	For a movie.
GAME	For game play.
USER	Allows the user to customise settings as desired. You can set the mode for each input source.
DYNAMIC	For a clear-cut image emphasising high contrast for sports viewing.
DYNAMIC (FIXED)	Changes the image and sound settings to the factory preset values. No adjustments are allowed.

NOTE

- You can select a different AV mode item for each input mode. (For example, select STANDARD for TV input and DYNAMIC for VIDEO input.)

Menu operation

- 1 Press **MENU** and the MENU screen displays.
- 2 Press **◀▶** to select the desired menu. (Programme setup, Picture, Audio, ECO, Setup, Option)
- 3 Press **▲/▼** to select the desired menu item. Press **ENTER** to proceed if necessary.
- 4 Press **▲/▼** or **◀▶** to select the desired item or adjust the item to the desired level. Press **ENTER** if necessary.
- 5 Press **RETURN** as necessary to return to the previous MENU. Press **MENU** to exit the MENU.

Programme setup

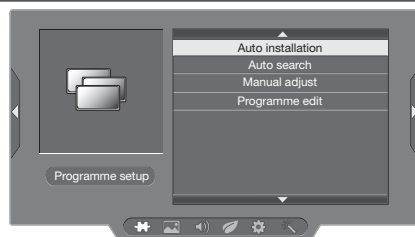

Auto installation

You can run auto installation again, even after setting up the preset channels.

- 1 Press **MENU** and the MENU screen displays.
- 2 Press **◀▶** to select "Auto installation", and then press **ENTER**.
- 3 Press **▲/▼** to select "Auto installation", and then press **ENTER**.
 - If you have already set the password, enter it here.
 - See page 10 for setting a password.
- 4 Press **▲/▼** to select the desired language listed on the screen, and then press **ENTER**.
 - You do not need to do anything during the auto search. Press **MENU** to exit.

TV channel settings

You can reconfigure the TV channel settings automatically or manually using **Auto search**, **Manual adjust** or **Programme edit**.

Auto search

Use this menu to add new services automatically after "Auto installation" has been completed. Auto search will memorise channels available at that time.

- 1 Repeat steps 1 and 2 in **Auto installation**.
- 2 Press **▲/▼** to select "Auto search", and then press **ENTER**.
 - If you have already set the password, enter it here.
 - See page 10 for setting a password.
 - You do not need to do anything during the auto search. Press **MENU** to exit.

Programme setup (Continued)

Manual adjust

You can set some channel items manually.

- 1 Repeat steps 1 and 2 in **Auto installation**.
- 2 Press **▲/▼** to select "Manual adjust", and then press **ENTER**.
 - If you have already set the password, enter it here.
 - See page 10 for setting a password.
- 3 Press **▲/▼** to select your desired item, and then press **◀▶** to adjust the settings.

Item	Description
Storage to [1~99]	Save programme to your desired channel number. Press R to save.
Sound system	Select the optimum sound system (Broadcasting system) to receive. (B/G, I, D/K, M)
Colour system	Select the optimum colour system to receive. (PAL, NTSC, SECAM)
Current CH	Select the channel you want to edit. <ul style="list-style-type: none"> • Selected channel will be automatically reflected in the background.
Search	Start searching from current channel. <ul style="list-style-type: none"> • Instead of pressing ◀▶ to adjust the frequency, you can set by directly entering the frequency number of the channel with 0 - 9. Press R to save.
Fine-tune	Tune the frequency of the stored channel to your desired position. <ul style="list-style-type: none"> • Adjust while checking the background picture as a reference. Press R to save.

NOTE

- The frequency shown below the On-Screen Display shows the real-time frequency of the displayed channel.

Programme edit

Use this menu to set up a channel individually.

- 1 Repeat steps 1 and 2 in **Auto installation**.
 - 2 Press **▲/▼** to select "Programme edit", and then press **ENTER**.
 - 3 Press **▲/▼** to select the channel you want to edit, and then press **1 to 5** on the remote control if necessary or press **RETURN** to exit.
 - As you toggle down the channels, each channel is immediately reflected in the background when you press **ENTER**.
- 1 [X] (Erase programme)**
Channels can be erased individually. Press **1** to erase the selected channel.

2 [Label] (Label)

When a TV channel sends its network name, the "Auto installation" detects the information and assigns a name to it. However, you can change channel names individually.

Maximum 5 alphanumeric characters can be input. Press **2** to start labelling.

Press **▲/▼/◀▶** to select a character, and then press **2** again or **ENTER** to save.

3 [Sort] (Sort)

Channel positions can be sorted freely.

Press **3** to select the channel you want to move.

Press **▲/▼** to move it to the desired position, and then press **3** again or **ENTER** to save.

4 [Skip] (Skip)

Channels with "Skip" set to "On" are passed over when using **CH▲/▼** even if selected while watching the image from the TV.

Press **4** to skip the selected channel.

Press **4** again to cancel the skip.

5 [Lock] (Lock)

You can block the viewing of any selected channel. Password must be set first to allow "**[Lock]**" to function.

- See page 10 for setting a password.

Press **5** to lock the selected channel.

Press **5** again to unlock the locked channel.

Picture menu

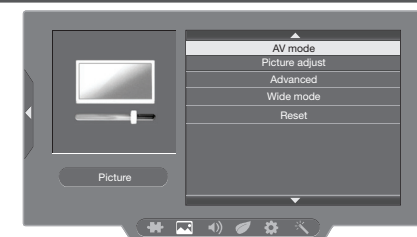

Picture adjust

Adjusts the picture to your preference with the following picture settings.

Selected item	◀ button	▶ button
Backlight	The screen dims	The screen brightens
Contrast	For less contrast	For more contrast
Brightness	For less brightness	For more brightness
Colour	For less colour intensity	For more colour intensity
Tint	Skin tones become reddish	Skin tones become greenish
Sharpness	For less sharpness	For more sharpness

Picture menu (Continued)

NOTE

- “Picture adjust” cannot be changed during “DYNAMIC (FIXED)” mode.
- For resetting all “Picture adjust” items to factory preset values, press ▲/▼ to select “Reset”, press **ENTER**, press ▲/▼ to select “Yes”, and then press **ENTER**.

Advanced

This TV provides various advanced functions for optimising the picture quality.

Active contrast

Automatically adjusts the contrast of an image according to the scene. (On, Off)

DNR (Digital Noise Reduction)

Reduces noise on screen and produces a clearer video image. (Off, High, Low, Auto)

Eagle View*

“Eagle View” technology produces a sharp picture from the original moving picture. (“On”, “Off”)

AquoMotion Lite*

“AquoMotion Lite” technology provides superior solutions for display picture quality removing motion blur. (“Advanced”, “High”, “Off”)

* NOTE

- This effect is greater on fast moving images.
- This function will have no effect in the following cases.
 - 1) The type of signal received is a PC signal.
 - 2) An OSD is being displayed.
 - 3) Teletext is activated.
- If images appear blurred or flickering, set to “Off”.

Wide mode

You can manually select the size of a picture appeared on your screen.

Selectable picture size varies with the type of signal received.

Press ▲/▼ while the wide mode menu displays on the screen.

- As you toggle down the options, each mode is immediately reflected on the TV.

Selected item	Description
Normal	For 4:3 “standard” pictures. A side bar appears on each side.
Zoom 14:9	For 14:9 letterbox pictures. A thin side bar appears on each side, and you may also see bars on the top and bottom with some programmes.
Panorama	In this mode the picture is progressively stretched toward each side of the screen.
Full	For 16:9 squeeze pictures.
Cinema 16:9	For 16:9 letterbox pictures. Bars may appear on the top and bottom with some programmes.

Selected item	Description
Cinema 14:9	For 14:9 letterbox pictures. Bars may appear on the top and bottom with some programmes.
Dot by Dot	Displays an image with the same number of pixels on the screen (only when receiving a 1080i/1080p signal for LC-40LE265M).
Underscan	Display with an Underscan image only when receiving a 720p/1080p/1080i signal (only for LC-32LE265M)/a 720p signal (only for LC-40LE265M). Display with the High-Definition image adjusted optimally. Noise may appear on the edge of the screen with some programmes.
Auto	Keeps the original aspect ratio and enlarges the picture as much as possible.
Original	Keeps the original aspect ratio and size.

NOTE

- You can also select an item by pressing **WIDE** on the remote control unit.
- Some picture sizes may not be displayable depending on the input signal.
- “Auto” and “Original” can be selected only during video playback in “Movie mode” of USB Media Player.

Audio menu



Sound adjust

Selected item	◀ button	▶ button
Treble	For weaker treble	For stronger treble
Bass	For weaker bass	For stronger bass
Balance	Decrease audio from the right speaker	Decrease audio from the left speaker

Surround

When you set to “On”, you can enjoy surround sound, the same as if you were in a movie theatre. (On, Off)

NOTE

- For resetting all “Sound adjust” items to the factory preset values, press ▲/▼ to select “Reset”, press **ENTER**, press ▲/▼ to select “Yes”, and then press **ENTER**.

ECO menu



No signal off

You can set the TV to automatically power off in about 15 minutes after the TV goes into a state of receiving no programme signals. (Enable, Disable)

- Five minutes before the power shuts down, the remaining time displays every minute.

NOTE

- When a TV programme finishes, and the TV receives signal input, this function may not operate.

No operation off

You can set the TV to automatically power off when no TV operation is performed for more than 3 hours. (30 min., 3 hr., Disable)

- Five minutes before the power shuts down, the remaining time displays every minute.

Setup menu



Child lock (TV input mode only)

Allows you to use a password to protect certain settings from being accidentally changed.

Setting a password

- 1 Repeat steps 1 and 2 in **Menu operation**.
- 2 Press ▲/▼ to select “Child lock”, and then press **ENTER**.
- 3 If you have already set the password, enter it here.
- 4 Press ▲/▼ to select “Change password”, and then press **ENTER**.
- 5 Enter the 4-digit number as a password using **0 – 9**.
- 6 Enter the same 4-digit number as in step 5 to confirm.

NOTE

- To view a locked channel, you must enter a password. When you select a locked channel, “Child lock has been activated” is displayed.
- Press **ENTER** to display the password input window.

Clearing the password

Allows you to clear your password.

- 1 Repeat steps 1 to 3 in **Setting a password**.
- 2 Press ▲/▼ to select “Clear password”, and then press **ENTER**.
- 3 Press ◀/▶ to select “Yes”, and then press **ENTER**.

Input label

You can assign each input source a label as you prefer.

- 1 Press **MENU** and the MENU screen displays.
- 2 Press ◀/▶ to select “Setup”.
- 3 Press ▲/▼ to select “Input label”, and then press **ENTER**.
- 4 Press ▲/▼ to select an input, and then press ▲/▼ to select a desired alphanumeric. Maximum 6 alphanumerics can be input.

→ [] ← ! ← ... → @ ←
 [] ← ... → a ← Z ← ... → A ←

Press ◀/▶ to move to the desired alphanumeric position.

To exit, press **ENTER**.

If the wrong alphanumeric is entered, select [] to clear.

NOTE

- You cannot change Input label for TV input mode.

HDMI auto view (HDMI input mode only)

Selected item	Description
Enable/Disable	Set whether or not to use the Auto Selection of WIDE MODE based on signal recognition received from the HDMI signal.

Language

Select from among 10 languages: English, Simplified Chinese, Arabic, French, Portuguese, Russian, Persian, Thai, Vietnamese and Indonesian.

Identification

You can check the current version of the software on the screen.

Reset

If complex adjustments are made and the settings cannot be restored to normal, you can reset the settings to the factory preset values.

NOTE

- If you execute “Reset”, all the settings such as “Picture”, “Audio” and “Programme setup” will be reset to the factory preset values.

Option menu

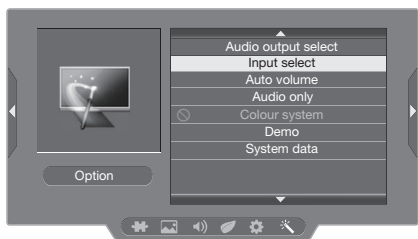

Audio output select

You can select which device is used for outputting audio.

Option	Description
Headphone	Output audio through headphones.
Audio out	Output audio through an A/V receiver or surround audio controller.

NOTE

- If you select "Headphone" when a cable is inserted in the AUDIO output terminal, the TV speakers are muted and all Audio menu items cannot be adjusted.
- If you select "Audio out", sound via the AUDIO output terminal is not adjustable and constantly outputs.

Regarding the headphone jack

- Use headphones with a stereo mini plug (ϕ 3.5 mm).
- Be sure to unplug headphones from the jack when they are not in use.

Volume display when headphones are plugged in



CAUTION

- AUDIO output terminal is also used for headphones. Reduce the volume before using headphones. Overwhelming sound may damage your hearing.

Input select

For setting the signal type of external equipment.

Input source	Selectable item
INPUT3	Component, Video

Auto volume

Different sound sources, fairly often do not have the same volume level, for example the changing from movie to the advertisements. Auto volume solves this problem and equalises the volume levels. (On, Off)

Audio only

When listening to music from a music programme, you can set the display off and enjoy audio only.

Selected item	Description
On	Audio is output without screen image.
Off	Both screen images and audio are output.

NOTE

- When you make operations that change the picture on the TV such as by changing the input source, the Audio only function is set to "Off".

Colour system

You can change the colour system to one that is compatible with the image on the screen. (Auto, PAL, SECAM, NTSC 3.58, NTSC 4.43, PAL-60)

NOTE

- If "Auto" is selected, colour system for each channel is automatically set. If an image does not display clearly, select another colour system (e.g. PAL, NTSC 4.43).
- "Colour system" is selectable only when inputting a composite signal.

Demo

When "Demo" is set to "On", after all the settings are completed, the Demo screen is displayed if there is no operation for several minutes. (On, Off)

System data

This function allows you to update the TV to the latest software using a USB device. You must update the software through the USB terminal.

ECO mode

This function enables you to reduce the backlight brightness in order to decrease the power consumption and increase the backlight life span as shown in the following table.

Selected item	Description
ECO 1	Reduces the backlight brightness.
ECO 2	Reduces the backlight brightness more than "ECO 1".
ECO off	Normal setting of backlight brightness.

ECO status will be displayed on the channel information window.

Colour adjustment and still image

Allows you to adjust the colour tone of a still image.

- 1 Press **COLOUR ADJ. (FREEZE)**, the moving image will be captured and colour adjustment screen displays.
- 2 Press **▲/▼/◀/▶** to adjust the colour to your desired setting.

Button	Description
▲	White with greenish tone.
▼	White with reddish tone.
◀	White with bluish tone.
▶	White with yellowish tone.
R	Reveal/hide the setting screen.
G	Set adjustment to last user setting.
B	Close the setting screen and unfreeze image.
ENTER	Save/exit setting.

NOTE

- The colour adjustment screen and still image will automatically goes out after 30 minutes.
- Freeze/Colour adjustment function does not work in USB Photo/Movie playback. It works for HDMI and composite/component.

Timer

Press **TIMER** to set the Sleep Timer or a Reminder for an activity.

Sleep Timer

This function is conveniently used when, for instance, going to bed while watching TV.
(Off, 0 hr. 30 min.,, 2hr. 30 min.)

⌚ (Reminder)

This function is to set a reminder for an activity. Press **▲/▼** or **ENTER** to set.

NOTE

- If you turn off the TV, the counter will be reset.
- Timer function does not work in USB mode.

Using a Smartphone with the TV

This function enables you to connect the TV to a smartphone that supports Mobile High-Definition Link (MHL) using an MHL-compatible cable. To connect the TV to your MHL-compatible smartphone, be sure to use an MHL-compatible cable (commercially available).

- You can view pictures and video on a large screen.
- You can play back music files.

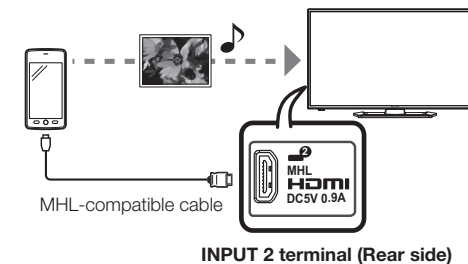

NOTE

- An MHL-compatible portable device is required to use this function. Connect the device to the INPUT 2 terminal.
- This production incorporates MHL 2.

Auto power on

When an MHL-compatible device is connected to the TV, the TV turns on automatically.

Auto input selection

When an MHL-compatible device is connected while the TV is on, the input mode is selected automatically.

Operation using the remote control

The remote control of the TV can be used to operate a portable device.

- **▲/▼/◀/▶**, **ENTER**, **0 - 9**, etc.
- The operations vary depending on the connected equipment and content being viewed.
- **Colour (Red/Green/Yellow/Blue)** may be available to control play/pause/fast forward/back forward function.

USB Media Player

Selecting modes

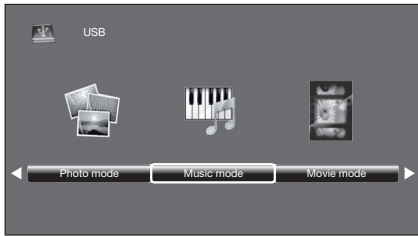

- 1 Press **INPUT** to select the "USB" mode or the TV will automatically switch to the USB mode when a USB device is connected to the TV.
- 2 Press **◀▶** to select "Photo mode", "Music mode" or "Movie mode", and then press **ENTER**.
- 3 Press **◀▶** to select your USB directory, and then press **ENTER**.
- 4 Press **▲▼/◀▶** to select the desired folder, and then press **ENTER**.

NOTE

- "Wide mode" is fixed during "Photo mode" and "Music mode".
- Depending on the USB device, the TV may not be able to recognise the contained data.
- Use only alphanumeric characters for naming files.
- A file name with more than 10 characters may not be displayed all (depending on the character set).
- Files in USB 1.1 devices may not be played properly.
- Operation using USB hubs is not guaranteed.
- The compatibility of USB HDDs may not be guaranteed.
- Multi drive USB is not supported.

PHOTO slideshow



When you press **PHOTO**, the TV screen will automatically play the photo slideshow.

- If there is no USB drive, the TV will switch to **Selecting modes** screen.
- Photo slideshows will autoplay only for the photos located on the top layer of USB drive. To enable autoplay for photos located in a subfolder, you need to manually select the subfolder, and then press **PHOTO**.

You can select the duration for each photo to display, and also the duration for the slideshow to play.

Duration for photos to display
 → 3 seconds → 5 seconds → 10 seconds → 1 minute

Duration for slideshow to play
 → 1 hour → 3 hour → Continuous

- The TV will automatically power off after the selected playtime ends.

NOTE

- Background music will autoplay during a slideshow only if the music file is located in the same folder with the photo files.
- If you want to stop the photo slideshows, press **RETURN** to exit.

List of files compatible with USB mode

USB device/ File system	USB Memory / FAT/FAT32
Photo file format	JPEG (.jpg) (DCF2.0 compliant). Progressive format of jpeg files are not supported.
Music file format (Files may not be playable depending on the bitrate)	MP3 (.mp3) Bitrate: 32 k, 40 k, 48 k, 56 k, 64 k, 80 k, 96 k, 112 k, 128 k, 160 k, 192 k, 224 k, 256 k, 320 kbps Sampling frequency: 32 k, 44.1 k, 48 kHz

Video file format		
File extension	Container	Video
*.avi	AVI	XviD H.264 MPEG2
*.mkv	MKV	H.264 MPEG2 MPEG1
*.mp4	MP4	XviD H.264
*.vob	VOB	MPEG2
.mpg/.mpeg	PS	MPEG2 MPEG1
.rm/.rmvb	RM	RM codec
.ts/.trp/*.tp	TS	H.264 MPEG2
*.dat	DAT	MPEG2 MPEG1

USB Media Player (Continued)

Control panel for photo/music/movie mode operations

- Press **B** to display the control panel below.

Button/menu	Description	Photo	Music	Movie
ENTER	When selecting a folder icon: Enter this directory. When selecting a thumbnail: Play the selected file.	✓	✓	✓
▶/⏸	Play/Pause.	✓	✓	✓
◀◀	Rewind. Each time you press rewind, the speed will change (2x, 4x, 8x, 16x).	-	✓	✓
▶▶	Fast-forward. Each time you press fast-forward, the speed will change (2x, 4x, 8x, 16x).	-	✓	✓
◀	Play the previous file.	✓	✓	✓
▶	Play the next file.	✓	✓	✓
G / □	Stop playback and return to the list of files.	✓	✓	✓
↺	Loop. Each time you press ENTER , the mode will switch between Repeat ↔ No repeat.	✓	✓	✓
🎵	Play/cancel the background music.	✓	-	-
🔊	Mute. Press ENTER to toggle between mute and unmute.	-	✓	-
🔄	Two loop. Press ENTER to set the current playback time starting point. Press ENTER to set the loop end of the current playing time and start loop playback. Press ENTER button to cancel the loop.	-	-	✓
📄	Show playlists. Select a file from the playlists to start playback.	✓	✓	✓
ⓘ	Display information about the file.	✓	✓	✓
▶▶▶	Slow-forward. Each time you press slow-forward, the speed will change.	-	-	✓
▶▶▶▶	Single frame-forward. Each time you press ENTER , the picture will change to the next still picture.	-	-	✓
⌚	Set time for music/movie playback.	-	✓	✓
🕒	Rotate clockwise 90°.	✓	-	-
🕒	Rotate counterclockwise 90°.	✓	-	-
🔍	Zoom in an image. Select to display larger image size.	✓	-	-
🔍	Zoom out an image. Select to display smaller image size.	✓	-	-
📏	Pan image up, down, left or right after you zoom in. Press ENTER to exit.	✓	-	-
🕒	Select playback length of a slideshow.	✓	-	-
🕒	Select photo display interval.	✓	-	-

NOTE

- Files in folder which are not related to a selected mode cannot be accessed.
- "Unsupported file" alert will pop up for a selected file of invalid format.

Appendix

Troubleshooting

The problems described below are not always caused by malfunctions. Check the TV again before having the TV serviced.

Problem	Possible Solution
• No power.	<ul style="list-style-type: none"> Check if you pressed POWER on the remote control unit. (See page 6.) If the indicator on the TV lights up red, press POWER. Is the AC cord disconnected? Has the power been turned on? (See page 6.)
• Unit cannot be operated.	<ul style="list-style-type: none"> External influences such as lightning, static electricity, etc., may cause improper operation. In this case, operate the unit after first turning the power off the TV or unplugging the AC cord and re-plugging it in after 1 or 2 minutes.
• Remote control unit does not operate.	<ul style="list-style-type: none"> Is battery inserted with polarity (+, -) aligned? (See page 5.) Is battery worn out? (Replace with new battery.) Are you using it under strong or fluorescent lighting? Is a fluorescent light shining on the remote control sensor?
• Picture is cut off.	<ul style="list-style-type: none"> Are screen mode adjustments such as picture size made correctly? (See pages 8 to 9.)
• Strange colour, light colour, or dark, or colour misalignment.	<ul style="list-style-type: none"> Adjust the picture tone. (See pages 8 to 9.) Is the room too bright? The picture may look dark in a room that is too bright. Check the colour system setting. (See pages 8, 11.) Check the HDMI auto view setting. (See page 10.)
• Power is suddenly turned off.	<ul style="list-style-type: none"> The unit's internal temperature has increased. Remove any objects blocking the vent or clean. Check the ECO setting. (See page 10.) Is the sleep timer set? (See page 12.)
• No picture.	<ul style="list-style-type: none"> Is the connection to external equipment correct? (See page 4.) Is the "Picture adjust" correct? (See page 8.) Is the antenna connected properly? (See page 3.) Is "On" selected in "Audio only"? (See page 11.)
• No sound.	<ul style="list-style-type: none"> Is the volume too low? (See page 5.)
• The TV sometimes makes a cracking sound.	<ul style="list-style-type: none"> This is not a malfunction. This happens when the cabinet slightly expands and contracts according to changes in temperature. This does not affect the TV's performance.

Cautions regarding use in high and low temperature environments

- When the unit is used in a low temperature space (e.g. room, office), the picture may leave trails or appear slightly delayed. This is not a malfunction, and the unit will recover when the temperature returns to normal.
- Do not leave the unit in a hot or cold location. Also, do not leave the unit in a location exposed to direct sunlight or near a heater, as this may cause the cabinet to deform and the LCD panel to malfunction.
Storage temperature: -20°C to +60°C.

Clearing the password

- Repeat steps 1 to 2 in **Setting a password**. (See page 10.)
- The password input screen displays.
- If you enter "3001" using **0 - 9**, the "Child lock" setting menu will be displayed.
- Enter the 4-digit number as a password using **0 - 9**. The new password is now set.

Specifications

Item		Model	LC-32LE265M	LC-40LE265M
Screen size			80 cm	100 cm
Resolution			1,049,088 pixels (1366 × 768)	2,073,600 pixels (1920 × 1080)
Video Colour System			PAL/SECAM/NTSC 3.58/NTSC 4.43/PAL 60	
TV Function	TV-Standard		PAL: B/G, D/K, I SECAM: B/G, D/K, K/K; NTSC: M	
	Receiving Channel	VHF/UHF	43.25—863.25 MHz	
		CATV	S1—S41 ch (including Hyperband)	
	TV-Tuning System		Auto Preset 99 ch	
STEREO/BILINGUAL			NICAM: B/G, I, D/K A2 stereo: B/G	
Viewing angles			H : 176° V : 176°	
Audio amplifier/Speakers			5 W × 2 / 4 × 7 cm 2pcs	7.5 W × 2 / 5 × 9 cm 2pcs
Terminals	Antenna input		UHF/VHF 75 Ω DIN type	
	INPUT 1		HDMI (HDMI input), PC input	
	INPUT 2		HDMI (HDMI input), MHL	
	INPUT 3		VIDEO in, AUDIO in, COMPONENT in	
	INPUT 4		VIDEO in, AUDIO in	
	OUTPUT		AUDIO out, Headphone (φ 3.5 mm stereo)	
USB			USB	
OSD language			English/Simplified Chinese/Arabic/French/Portuguese/Russian/Persian/Thai/Vietnamese/Indonesian	
Power Requirement			AC 110—240 V, 50/60 Hz	
Power Consumption			46 W (1.1 W Stand by)	73 W (1.1 W Stand by)
Dimensions	without stand		739 (W) × 440 (H) × 93 (D) mm	910 (W) × 525 (H) × 92 (D) mm
	with stand		739 (W) × 482 (H) × 174 (D) mm	910 (W) × 571 (H) × 206 (D) mm
Weight			5.7 kg (without stand) / 6.5 kg (with stand)	8.3 kg (without stand) / 9.8 kg (with stand)
Operating Temperature			0°C — 40°C	

- As a part of policy of continuous improvement, SHARP reserves the right to make design and specification changes for product improvement without prior notice. The performance specification figures indicated are nominal values of production units. There may be some deviations from these values in individual units.

CAUTION

- Installing the Liquid Crystal Television requires special skill that should only be performed by qualified service personnel. Customers should not attempt to do the work themselves. SHARP bears no responsibility for improper mounting or mounting that results in accident or injury.
- Carefully read the instructions that come with the bracket before beginning work.

SHARP
SHARP CORPORATION