



CFC Series

Cable Replacement Kit

for CFP Series Carbon Fiber Boom Poles

Owner's Manual

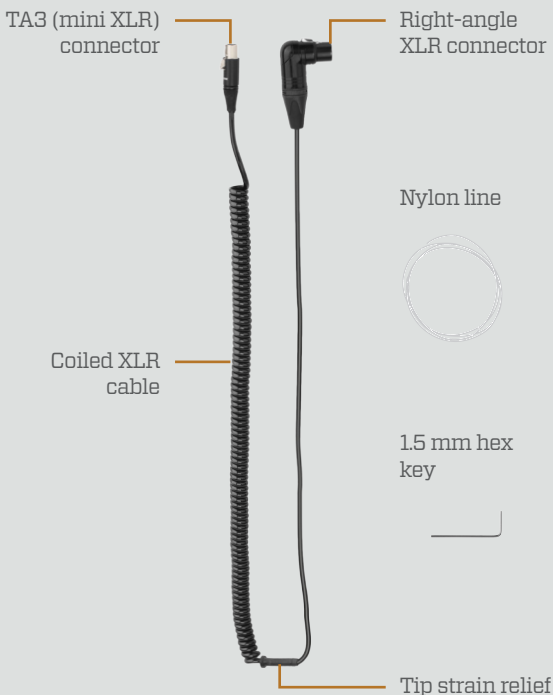

Introduction

Thank you for choosing Auray.

The Auray CFC replacement kit provides a replacement cable for the Auray CFP carbon fiber boom pole. Auray's solderless design provides a fast and easy solution for cable replacement.

The high-quality coiled cable features a right-angle XLR connector manufactured by Neutrik®, and a TA3 (mini XLR) connector manufactured by Rean® (a registered trademark of Neutrik®) for secure locking connections and flawless signal transfer. This cable also features Auray's unique strain relief system that absorbs tension and protects the cable from damage at the edge of the tip exit and at the T3 connector. The included hex key and a small slotted screwdriver (not included) are the only tools needed for this cable replacement procedure that will assure long-lasting and trouble-free operation of your CFP boom pole.

Instructions

Replacing the Cable – Boom Pole with Bottom Exit XLR

Remove the old cable

1. Use the hex key to loosen the set screw on the tip. **1**
2. Remove the tip by unscrewing it. **2**
3. Lift the cable and strain relief out of the tip exit slot. **3**
Tip: Before proceeding, push a small length of cable into the tube from the tip of the pole. This will give you enough slack to complete the following steps.
4. Unscrew the bottom housing from the base of the boom pole. **4**
5. Unscrew the plastic TA3 strain relief. **5**
6. Disconnect the TA3 connector by pressing on the locking tab and gently removing the connector from the mount.
Note: The TA3 connector should easily disconnect. Do not force or pull on the cable to disconnect it. Doing so could damage the housing or the connector.
7. Use a small slotted screwdriver to reach inside the strain relief and depress the locking tab of the TA3 connector. **6** With the locking tab depressed, you can slide the strain relief over the TA3 connector and off of the cable. Set the strain relief piece aside.

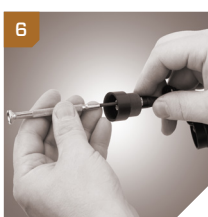
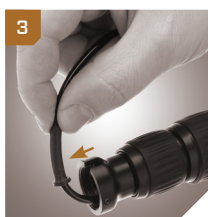

Alternative: Use a wire cutter to snip the cable at the base of the TA3 connector. Remove the strain relief, and set it aside.

Important: Once you have performed this step, the cable will be unusable. If you plan on using the cable again at a later point, don't proceed with this alternative step.

8. Remove the cable by pulling it out from the top of the pole.

Install the replacement cable

1. Holding the boom pole upright, insert the replacement cable into the top of the boom pole, **1** and snake it through the tubing until the TA3 connector is exposed at the bottom of the pole. **2**

Note: If the cable does not move smoothly through the tubing, use the included nylon line: tie the line to the TA3 connector and drop it through the tubing from the top. **3** Pull the string from the bottom of the boom pole to snake the cable through the tubing. Make sure to remove the line before continuing.

2. Fit the narrow side of the strain relief over the TA3 connector, and push it past the TA3 connector's locking tab. **4**
3. Plug the TA3 connector to the bottom housing by inserting it into the TA3 mount and pushing in until it clicks.

Note: When properly aligned, the TA3 connector will easily slide into place. Do not try to force the connector into the mount. Doing so could damage the connector or the mount.

4. Screw the threaded end of the strain relief onto the threaded fitting on the bottom housing. **5**
5. Screw the bottom housing onto the end of the boom pole. **6**
6. Place the strain relief of the cable into the tip exit slot.
7. Replace the tip by screwing it on, and secure it by tightening the set screw with the hex key.



Replacing the Cable - Boom Pole with Side Exit XLR

Remove the old cable

1. Use the hex key to loosen the set screw on the tip. **1**
2. Remove the tip by unscrewing it. **2**
3. Lift the cable and strain relief out of the tip exit slot. **3**

Tip: Before proceeding, push a small length of cable into the tube from the tip of the pole. This will give you enough slack to complete the following steps.

4. Unscrew the side exit housing, **4** and move the plastic strain relief cap so that the TA3 connector inside the housing is exposed.
5. Disconnect the TA3 connector by pressing on the locking tab and gently remove the connector from the mount. **5**

Note: The TA3 connector should easily disconnect. Do not force or pull on the cable to disconnect it. Doing so could damage the housing or the connector.

6. Use a small slotted screwdriver to reach inside the strain relief and depress the locking tab of the TA3 connector. With the locking tab depressed, you can slide the strain relief over the TA3 connector and off of the cable. **6** Set the strain relief piece aside.

Alternative: Use a wire cutter to snip the cable at the base of the TA3 connector. Remove the strain relief, and set it aside.

Important: Once you have performed this step, the cable will be unusable. If you plan on using the cable again at a later point, don't proceed with this alternative step.

7. Remove the cable by pulling it out from the top of the pole.



Install the replacement cable

1. Holding the boom pole upright, insert the replacement cable into the top of the boom pole, **1** and snake it through the tubing until the TA3 connector is exposed at the bottom of the pole. **2**

Note: If the cable does not move smoothly through the tubing, use the included nylon line. Tie the string to the TA3 connector, **3** and drop it through the tubing from the top. Pull the line from the bottom of the boom pole to snake the cable through the tubing. Make sure to remove the line before continuing.

2. Fit the narrow side of the strain relief over the TA3 connector, and push it past the TA3 connector's locking tab. **4**
3. Plug the TA3 connector into the side-exit XLR housing by inserting it into the TA3 mount and pushing in until it clicks.

Note: When properly aligned, the TA3 connector will easily slide into place. Do not try to force the connector into the mount. Doing so could damage the connector or the mount.

4. Push the strain relief all the way into the side exit housing so it sits over the TA3 connector. **5**
5. Screw the side exit housing onto the end of the boom pole. **6**
6. Place the strain relief of the cable into the tip exit slot.
7. Replace the tip by screwing it in, and secure it by tightening the set screw with the hex key.



Warnings

- Please read and follow these instructions, and keep this manual in a safe place.
- Handle the product with care.
- Use only parts provided by the manufacturer.
- Make sure the item is intact and that there are no missing parts.
- Do not attempt to disassemble or repair the equipment—doing so will void the warranty, and Auray will not be responsible for any damage.
- All photos are for illustrative purposes.

One-Year Limited Warranty

This Auray product is warranted to the original purchaser to be free from defects in materials and workmanship under normal consumer use for a period of one (1) year from the original purchase date or thirty (30) days after replacement, whichever occurs later. The warranty provider's responsibility with respect to this limited warranty shall be limited solely to repair or replacement, at the provider's discretion, of any product that fails during normal use of this product in its intended manner and in its intended environment. Inoperability of the product or part(s) shall be determined by the warranty provider. If the product has been discontinued, the warranty provider reserves the right to replace it with a model of equivalent quality and function.

This warranty does not cover damage or defect caused by misuse, neglect, accident, alteration, abuse, improper installation or maintenance. EXCEPT AS PROVIDED HEREIN, THE WARRANTY PROVIDER MAKES NEITHER ANY EXPRESS WARRANTIES NOR ANY IMPLIED WARRANTIES, INCLUDING BUT NOT LIMITED TO ANY IMPLIED WARRANTY OF MERCHANTABILITY OR FITNESS FOR A PARTICULAR PURPOSE. This warranty provides you with specific legal rights, and you may also have additional rights that vary from state to state.

To obtain warranty coverage, contact the Auray Customer Service Department to obtain a return merchandise authorization ("RMA") number, and return the defective product to Auray along with the RMA number and proof of purchase. Shipment of the defective product is at the purchaser's own risk and expense.

For more information or to arrange service, visit www.aurayaudio.com or call Customer Service at 212-594-2353.

Product warranty provided by the Gradus Group.
www.gradusgroup.com

Auray is a registered trademark of the Gradus Group. © 2016 Gradus Group LLC. All Rights Reserved.

