

VRS-MULTI-W



Wireless
Video Remote
for Sony Cameras and Camcorders

REVO[®]

Precautions

- Please read and follow the instructions, and keep this manual in a safe place.
- Handle the unit with care.
- Keep this unit away from water and any flammable gases or liquids.
- Clean the unit with only a soft, dry cloth.
- Make sure the item is intact and that there are no missing parts.
- Do not attempt to disassemble or repair the equipment—doing so will void the warranty, and Revo will not be responsible for any damage.
- All images are for illustrative purposes only.

Thank you for choosing Revo.

The Revo VRS-MULTI-W is a wireless remote for Sony camcorders and point-and-shoot and mirrorless cameras when using a power-zoom lens. Enjoy smooth, hands-free video operation with electronic control between wide and telephoto angles. Cycle through available grid-lines or put the camera into sleep mode. Trigger single or continuous shots or lock the shutter for bulb shooting—at the touch of a button and up to 328 feet away from your camera.

Specifications

Radio Frequency: 2.4 GHz

Operating Distance: 328 ft. (100 m)

Power: 4 × AAA batteries

Dimensions (H × W × D):

Transmitter: 0.67 × 1.4 × 4.9 in.
(17 × 35 × 124 mm)

Receiver: 1.06 × 1.5 × 2.76 in.
(27 × 39 × 70 mm)

Weight: Transmitter: 1.06 oz. (30 g)

Receiver: 0.95 oz. (27 g)

Overview

Transmitter Remote

- 1 Activity indicator
- 2 Wrist strap mount
- 3 On/off switch
- 4 1/4-20 mount
- 5 Battery compartment (2 × AAA batteries)

Receiver

- 6 On/off switch
- 7 Activity indicator
- 8 Mounting foot
- 9 1/4-20 socket
- 10 Locking wheel
- 11 USB Mini-B port
- 12 Tether mount
- 13 Battery compartment (2 × AAA batteries)

Also Included:

S2 remote cable (Multi Terminal)

Transmitter wrist strap

Receiver tether

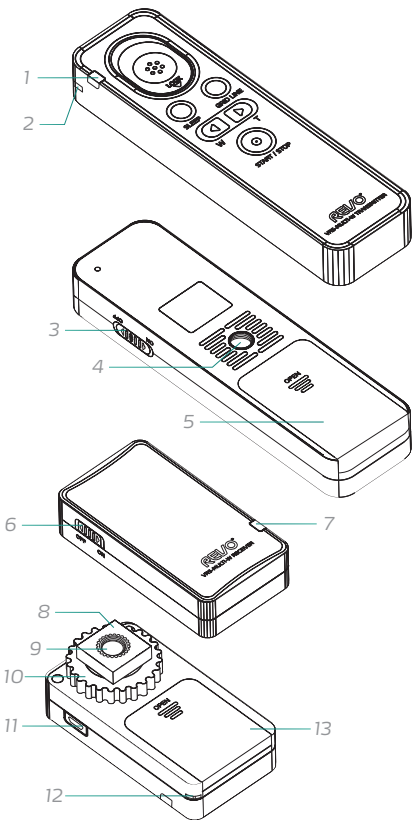

VRS-MULTI-W Functions

Locking shutter release: Press halfway to focus, and press fully to release the shutter. Slide the lock in place to keep the shutter button pressed for bulb or continuous shooting. When the camera is set to bulb, the shutter remains open with the lock engaged. When your camera's drive is set to continuous, the shutter releases continuously (speeds vary depending on camera).

Sleep: Put your camera to sleep to conserve battery power, or wake your camera from sleep mode. The activity indicator will be green when in use, and turn off when in sleep mode.

Grid line: Cycles through your camera's available grid-line configurations.





Zoom rocker: Electronic zoom control between wide and telephoto of select Sony cameras with compatible power zoom lenses attached. The rocker switch is pressure sensitive, and the zoom speed will vary depending how hard the button is pressed.

Start/stop: Start and stop video recording.

Pairing the Transmitter and Receiver

1. Turn on the transmitter's power.
2. Hold the record button on the transmitter until the indicator light blinks red and green.
3. Turn on the receiver's power. The receiver's indicator light will blink green when the pairing is successfully completed.
4. Release the transmitter's record button.

Activity Indicator Status

Indicator Light	Status
 (steady)	Standby and ready.
 (blinking)	A button has been pressed and is active.
 (steady)	Connection issue. Check that all wires are connected to the device and your camera.
 (steady)	Video is recording or the shutter is locked.
 (blinking)	Low battery.

One-Year Limited Warranty

This Revo product is warranted to the original purchaser to be free from defects in materials and workmanship under normal consumer use for a period of one (1) year from the original purchase date or thirty (30) days after replacement, whichever occurs later. The warranty provider's responsibility with respect to this limited warranty shall be limited solely to repair or replacement, at the provider's discretion, of any product that fails during normal use of this product in its intended manner and in its intended environment. Inoperability of the product or part(s) shall be determined by the warranty provider. If the product has been discontinued, the warranty provider reserves the right to replace it with a model of equivalent quality and function.

This warranty does not cover damage or defect caused by misuse, neglect, accident, alteration, abuse, improper installation or maintenance. EXCEPT AS PROVIDED HEREIN, THE WARRANTY PROVIDER MAKES NEITHER ANY EXPRESS WARRANTIES NOR ANY IMPLIED WARRANTIES, INCLUDING BUT NOT LIMITED TO ANY IMPLIED WARRANTY OF MERCHANTABILITY OR FITNESS FOR A PARTICULAR PURPOSE. This warranty provides you with specific legal rights, and you may also have additional rights that vary from state to state.

To obtain warranty coverage, contact the Revo Customer Service Department to obtain a return merchandise authorization ("RMA") number, and return the defective product to Revo along with the RMA number and proof of purchase. Shipment of the defective product is at the purchaser's own risk and expense. Revo is a registered trademark of the Gradus Group. Product warranty provided by the Gradus Group.

For more information or to arrange service, visit revocinegear.com or call Customer Service at 212-594-2353.