



Oben[®]

CTM-2400/2500

CTM/ATM-2600

Monopod



You're on steady ground[™]

Thank you for choosing Oben.

Oben monopods are versatile and durable supports. Both carbon fiber and aluminum models are constructed to provide rigidity and strength to support for your camera. The leg features secure twist locks for swift height adjustment. And leg sections, designed with anti-twist alignment, are extremely easy to operate when opening and collapsing the monopod.

The monopods include a wrist strap to help secure the monopod and keep it stable during shooting, and a leg warmer for comfortable handling in cold weather.

Please read this entire manual before using your Oben monopod.



Warnings:

Do not exceed the monopod's maximum load capacity.

Ensure that all appropriate locks are engaged when necessary.

The monopod should be used only in temperatures between -22°F and 140°F. Do not use it in salt water. Dry the monopod if it gets wet.

Remove the camera from the monopod during transport.

Keep out of reach of children.

Images are for illustrative purposes only.

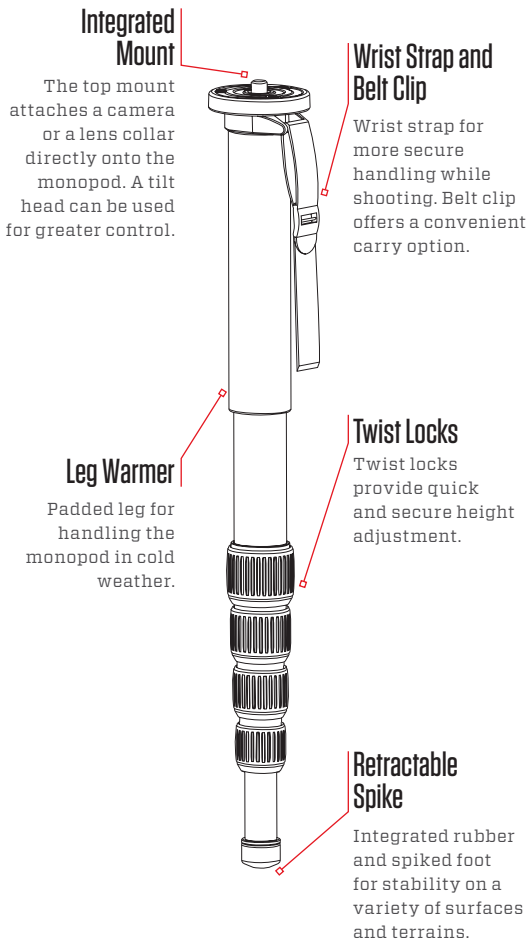

1. Height Adjustment

Twist the lock clockwise (a), and reposition the leg (b). Then twist the lock counterclockwise until secure.

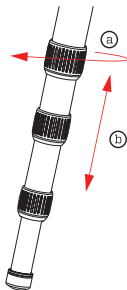

2. Mounting Screw

The monopod comes with a reversible 3/8-16 and 1/4-20 mounting screw that allows you to mount any tripod head or camera. To switch between the two sizes, loosen the set screw with the included hex key. Then unscrew the plate and reverse the screw. Screw the plate back onto the tripod until it's secure, and retighten the set screw.

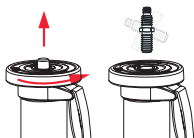

3. Mounting a Head

Align the head's socket with the monopod's mounting screw (a), and twist it clockwise until fully secured. Be sure that the bottom of the head is flush with the plate.

For compatible heads, tighten the three integrated set screws with the included hex key (b).

Important!

Do not overtighten the head or the set screws. Overtightening may damage the monopod or head.

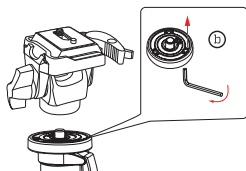
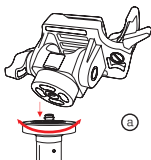

4. Wrist Strap

For a more stable monopod when shooting, secure the wrist strap around your wrist while also gripping the pad, as shown. To ensure stability, make sure there's enough tension on the strap and your wrist.

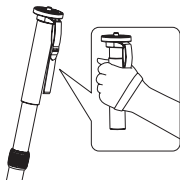

5. Belt Clip

The monopod's wrist strap includes an integrated belt clip. Slide the clip onto your belt for hands-free transport.

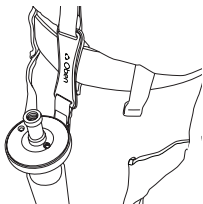

6. Retractable Spike

A spike is built into the monopod's rubber foot. Use the rubber foot for indoor or flat surfaces. Use the spike for soft ground, grass, and sand.

To extend the spike, rotate the rubber foot counterclockwise. Turn the foot clockwise to retract the spike.

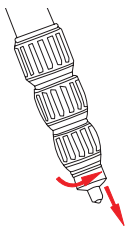

	CTM-2400	CTM-2500	CTM-2600	ATM-2600
Camera Mounting Screw	1/4-20 male, 3/8-16 male	1/4-20 male, 3/8-16 male	1/4-20 male, 3/8-16 male	1/4-20 male, 3/8-16 male
Leg Lock Type	Twist lock	Twist lock	Twist lock	Twist lock
Leg Sections	4	5	6	6
Load Capacity	22 lb. (10 kg)	26 lb. (11.8 kg)	26 lb. (11.8 kg)	26 lb. (11.8 kg)
Maximum Working Height	59.2 in. (150.4 cm)	64.5 in. (164 cm)	64.7 in. (164.3 cm)	64.7 in. (164.3 cm)
Folded Length	18.3 in. (46.5 cm)	17.3 in. (43.9 cm)	16.7 in. (42.4 cm)	16.7 in. (42.4 cm)
Materials	Carbon fiber	Carbon fiber	Carbon fiber	Aluminum
Weight	0.85 lb. (36 g)	1 lb. (454 g)	1.1 lb. (499 g)	1.32 lb. (599 g)



www.obensupports.com

© 2019 Gradus Group LLC. All Rights Reserved.
Oben is a registered trademark of the Gradus Group.