

IN1100 (SERIES)

Quick Start Guide

Guide de Démarrage Rapide

Schnellstart-Anleitung

Guía de Inicio Rápido

Guida di Consultazione Rapida

Snelstartgids

Guia de Início Rápido

Snabbstarthandbok

Краткое руководство

빠른 시작 안내서

快速入门指南

Panduan Ringkas

Regulatory models IN1110 and IN1112



P/N 36.8KN01G001-A

DISPERINDAG No. 0287/1.824.51/09.03

InFocus

Bright Ideas Made Brilliant

 Please read the safety instructions booklet before setting up the projector.

1

Unpack the box

Here's what's included:

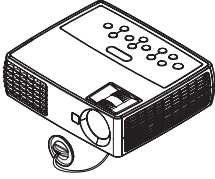

Projector with Lens Cap

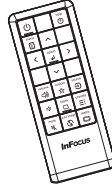

Remote



Carrying case



USB Cable

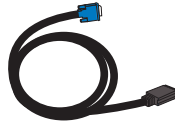

Computer Cable

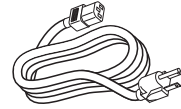

Power Cable

Save the box and packing materials.

2

Put batteries in the remote

The remote uses 2 AA batteries.

1

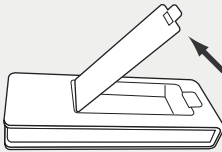

2

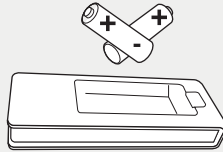

3

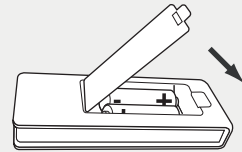

Please dispose of batteries in an environmentally proper manner.

Buy a Full-Featured Remote and Other Custom Accessories

www.infocus.com/store

Status Indicator Panel

The top of your projector includes a convenient indicator panel with symbols that light up to show important status.

For details, see Troubleshooting.

Power/Standby



High Temperature

Service Required



Replace Lamp

3

Connect source

Color-coded connections make it easy.
You can connect more than one source if needed.

Connect to: Computer (using VGA)

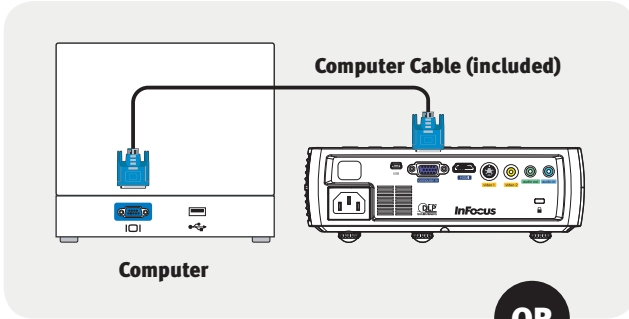

Got an Apple computer?

You may need an adapter. For more information, see How-To Guides at www.infocus.com/support/howto

OR

Connect to: DVD, VCR

1 Connect video using a S-Video or a Composite Video Cable

www.infocus.com/store part no. SP-SVIDEO-10M or SP-CPSTVID-5M

2 Connect video using a HDMI Cable

www.infocus.com/store part no. SP-HDMI-10M-R

3 Connect audio using a Mini-Plug to RCA Audio Y-Cable

Available from A/V dealer or retailer

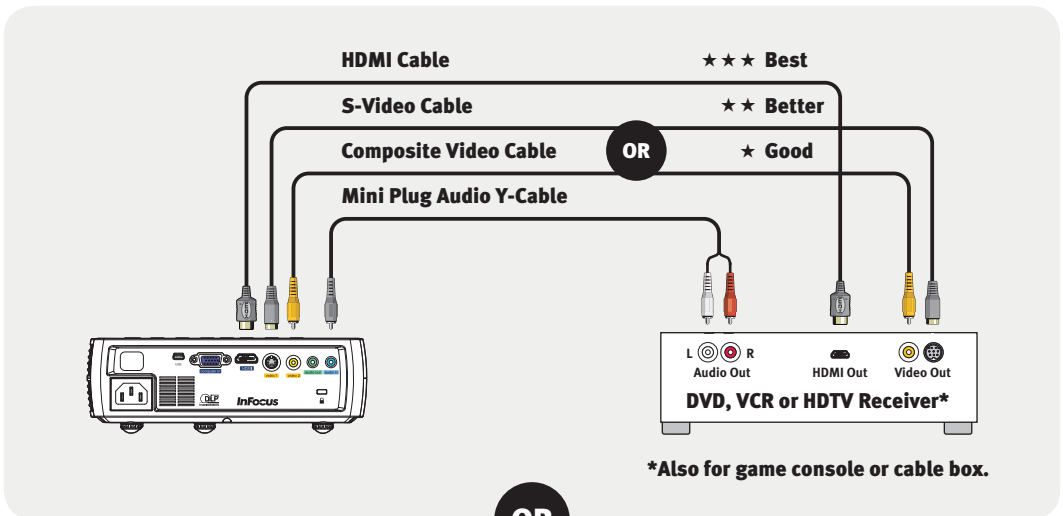

*Also for game console or cable box.

OR

Connect to: Other kinds of sources

How-To Guides are available at www.infocus.com/support/howto

4

Turn on projector and source

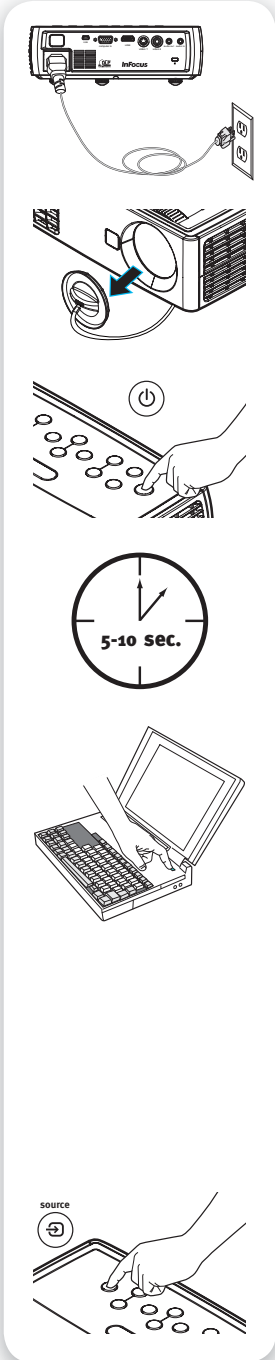

1 Connect the power cord to the projector and to an electrical outlet

The power light  on the projector will light amber.

2 Remove the lens cap

3 Turn on the projector

Touch the power light (or press power on the remote).
The power light will start blinking green.

4 Wait for the lamp to warm up

After a few seconds, the power light will stop blinking, and the other buttons on the keypad will light up. It can take a minute for the lamp to reach full brightness.



WARNING: Do not look directly into the lens when the projector is turned on.

5 Turn on computer or other source

You may need to press a specific key combination to activate your laptop's external video port. On most laptops, hold down the FN key while pressing a key labeled CRT/LCD, LCD/VGA, a monitor icon , or similar. Key combos for popular models:

Apple F7

HP/Compaq Fn+F4 or Fn+F6

Sony Fn+F7

Dell Fn+F8

IBM ThinkPad Fn+F7

Toshiba Fn+F5

Fujitsu Fn+F10

Complete laptop activation chart at www.infocus.com/support



IMPORTANT: If there is still no video, restart your computer (first make sure it's connected to the projector and the projector is turned on).

6 Change source if needed

If needed, press source (on the projector or remote) to view the source. You may have to press it more than once.

5

Adjust the picture

1 Height

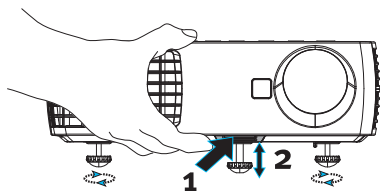

- 1 Hold down the release button under the front of the projector.
- 2 Lift the front of the projector to the desired height.
- 3 Release the button.

2 Keystone

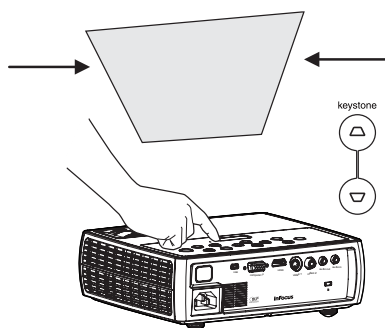

Press the keystone buttons to make the picture square.

3 Zoom and focus

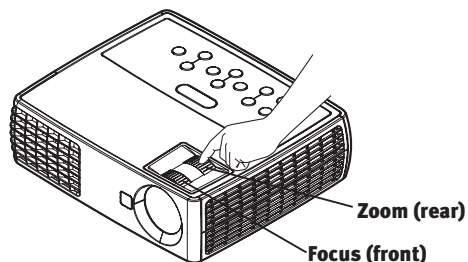

Adjust zoom first, then focus the center of the image.

Projector Location

As distance increases, the image gets larger and moves upwards.

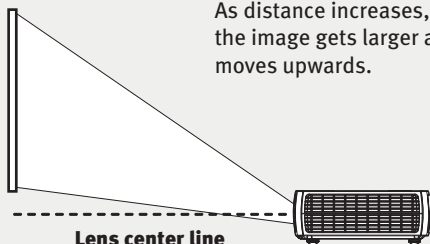

Diagonal Screen Size	Distance to Screen	
	Minimum	Maximum
IN1110		
60"/1.5m	7'10"/2.4m	8'7"/2.6m
80"/2.0m	10'5"/3.2m	11'6"/3.5m
90"/2.3m	11'8"/3.6m	12'11"/3.9m
150"/3.8m	19'6"/5.9m	21'6"/6.6m
IN1112		
60"/1.5m	6'7"/2.0m	7'2"/2.2m
80"/2.0m	8'9"/2.7m	9'7"/2.9m
90"/2.3m	9'10"/3.0m	10'10"/3.3m
150"/3.8m	16'5"/5.0m	18'0"/5.5m

Buy a Screen and Other Custom Accessories

www.infocus.com/store

Interactive Screen Size and Distance Calculator

www.infocus.com/calculator

Ceiling mount?

To flip the image, turn on the Ceiling Mount setting in the Advanced > Setup > Image setup menu

6

Using the menus

- 1 Press MENU, then press ∇ or \blacktriangle to review the menu options.
- 2 To enter a submenu, highlight the desired submenu and press SELECT.
- 3 To adjust a menu setting, highlight the desired menu option and press SELECT or \blacktriangleright . Then press \blacktriangleleft or \blacktriangleright to scroll through the available adjustments. To save your adjustments, press SELECT.
- 4 Press the MENU button to exit the menu system.

Note: Most picture settings are disabled (gray) unless a source is being displayed.

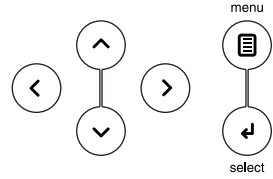

7

Turn off the projector

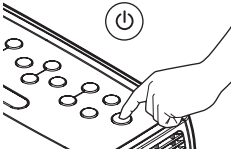

Press the power button

The power light on the projector will blink while the fan cools the lamp. If you need to unplug the projector, wait until the fan stops and the power light stops blinking and stays on.

Note: While the power light is blinking, button presses on the projector and remote are ignored.

8

Register your product

Activate your warranty to ensure eligibility for service and support. Get special offers and notifications about free product updates.

1 Write down your projector's serial number

It's printed on the label on the back of the projector. You'll need it to register (and if you ever need to contact support).

Serial number: _____

2 Go to www.infocus.com/register

(READ THE REFERENCE GUIDE)

Download it at www.infocus.com/support

The Reference Guide is available in multiple languages. It covers advanced setup and operation, including lamp replacement instructions.

(TROUBLESHOOTING)

If there is no picture or the picture is blank



If the power light is off, make sure the power cord is connected and plugged into a live electrical outlet. If the power light is amber and not blinking, touch the power light (or press power on the remote).

Check video source and cables. Make sure the video source (computer, DVD player, VCR, etc.) is turned on and cables are securely connected between the source and the projector.



Press the Source button. You may need to press it several times to view the correct source.



Press the Auto Image button.

If "Signal out of range" is shown, or the picture looks bad



Press the Auto Image button. If that doesn't help (and the source is a computer), reduce your computer's display resolution or vertical refresh rate.

If the replace lamp light is on



Turn the projector off and wait at least one minute, then turn it on again. If the Replace Lamp light turns on again, the lamp needs to be replaced. For lamp replacement instructions, see the Reference Guide, which can be downloaded at

www.infocus.com/support

Only InFocus genuine lamps are tested for use in this projector.

If the high temperature light is on



Turn the projector off and remove anything that may be blocking the air vents on its side. Leave the projector off for at least one minute to let it cool before turning it on again.

IMPORTANT: Continuous operation at high temperature may reduce the lifetime of the lamp and/or projector.

If the service required light is on



Turn the projector off and wait at least one minute, then turn it on again. If the Service Required light turns on again, the projector needs to be serviced. See below for service contact information.

More troubleshooting options are in the Reference Guide

Download it at www.infocus.com/support



WARNING: In the unlikely event of a lamp rupture, particles may be ejected from the projector. Keep out of the area under and around the projector while the projector is in use. See the safety instructions booklet for more details.

Questions? We're here to help!

Visit us at: www.infocus.com/support

We're here to support you with your new purchase. We can help you with...

- Determining screen sizes
- Documentation in other languages
- Connecting your sources (TV, DVD, Cable/Satellite, Game, etc.)
- Selecting optional accessories
- Product warranty protection plans

USA, Canada, Latin America

Customer Support Telephone
+1 (503) 207-4700
TOLL FREE: 877-388-8360
Mon-Fri, 6 am - 5 pm Pacific

Asia Pacific

Customer Support Telephone
Australia: 1300-290-922
Mon – Fri, 9 a.m. – 5 p.m. EDT
Australia Direct Sales: 61430-223-138
China: 800-888-9288
Singapore: 65-6603-9871
New Zealand: 008000-4636287
Mon – Fri, 9 a.m. – 5 p.m. SGT
ap.support@infocus.com

Europe, Middle East, Africa

Customer Support Telephone
France: 0800 905-993
Germany: 0800 181-3649
Italy: 0800 877-238
Spain: 900 993-163
UK: 0800 028-6470
Other: 008000 463-6287
Mon-Fri, 08:00 - 17:00 CET
emea.support@infocus.com

Hg - Lamp contains mercury. Manage in accordance with local disposal laws.

See www.lamprecycle.org

Declaration of Conformity

Manufacturer: InFocus Corporation, 13190 SW 68th Parkway, Portland, Oregon 97223-8368 USA

We declare under our sole responsibility that this projector conforms to the following directives and norms: EMC Directive 2004/108/EC, EMC: EN 55022, EN 55024, EN 61000-3-2, EN 61000-3-3, Low Voltage Directive 2006/95/EC, Safety: IEC 60950-1: 2005.

Trademarks

Apple, Macintosh, and PowerBook are trademarks or registered trademarks of Apple Computer, Inc. IBM is a trademark or registered trademark of International Business Machines, Inc. Microsoft, PowerPoint, and Windows are trademarks or registered trademarks of Microsoft Corporation. Adobe and Acrobat are trademarks or registered trademarks of Adobe Systems Incorporated. DLP® and the DLP logo are registered trademarks of Texas Instruments and BrilliantColor™ is a trademark of Texas Instruments. InFocus, In Focus, and INFOCUS (stylized) are either registered trademarks or trademarks of InFocus Corporation in the United States and other countries.

FCC Warning

This device complies with part 15 of the FCC Rules. Operation is subject to the following two conditions: (1) This device may not cause harmful interference, and (2) this device must accept any interference received, including interference that may cause undesired operation.

This equipment has been tested and found to comply with the limits for a Class B digital device, pursuant to part 15 of the FCC Rules. These limits are designed to provide reasonable protection against harmful interference in a residential installation. This equipment generates, uses and can radiate radio frequency energy and, if not installed and used in accordance with the instruction, may cause harmful interference to radio communications.

However, there is no guarantee that interference will not occur in a particular installation. If this equipment does cause harmful interference to radio or television reception, which can be determined by turning the equipment off and on, the user is encouraged to try to correct the interference by one or more of the following measures:

- Reorient or relocate the receiving antenna.
- Increase the separation between the equipment and receiver.
- Connect the equipment into an outlet on a circuit different from that to which the receiver is connected.
- Consult the dealer or an experienced radio/TV technician for help.

Changes or modifications not expressly approved by InFocus Corporation may void authority to operate the equipment.

EN 55022 Warning

This is a Class B product. In a domestic environment it may cause radio interference, in which case the user may be required to take adequate measures. The typical use is in a conference room, meeting room or auditorium.

Canada

This Class B digital apparatus complies with Canadian ICES-003.
Cet appareil numérique de la classe B est conforme à la norme NMB-003 du Canada.

Agency Approvals

UL, cUL. Other specific Country Approvals may apply. Please see product certification label.

Input ratings: 100-240Vac, 2.3-0.9A, 50-60Hz

InFocus reserves the right to alter product offerings and specifications at any time without notice.