

SoundBLASTER®

AE-9



使用产品前请阅读使用说明

EN. You need to provide this serial number if you require technical support for this product.

FR. Vous devez fournir ce numéro de série si vous avez besoin d'assistance technique pour ce produit.

DE. Diese Seriennummer wird im Bedarfsfall vom technischen Kundendienst für das Produkt abgefragt.

ES. Si necesita asistencia técnica para este producto, tendrá que proporcionar este número de serie.

PL. W razie korzystania z pomocy technicznej odnośnie tego produktu, muszą Państwo podać ten numer.

CZ. Toto výrobní číslo musíte uvést, budete-li požadovat k výrobku technickou podporu.

SK. V prípade potreby získať technickú podporu ohľadne tohto výrobku budete toto sériové číslo potrebovať.

RU. Если вам потребуется техническая поддержка по изделию, необходимо будет указать серийный номер.

JP. テクニカルサポートを受ける際に、シリアル番号が必要となりますので、シリアル番号ラベルを上部のシリアル番号欄に貼り付け（貼り付けた状態で出荷されている場合もあります）、本書を大切に保管してください。

KR. 제품의 기술 지원이 필요할 경우 이 일련 번호를 제공해야 합니다.

CS. 今后若需要技术支持服务,您还需提供此序列号。

CT. 今後若需要技術支持服務,您還需提供此序列號。

販売店印欄
Dealer Chop

お客様へ商品をお渡しする際に販売日を明記した貴店印をご捺印下さい。
Please put your dealer chop on this space for the customer.

Serial No / Numéro de série / Seriennummer / Número de serie / Numer seryjny / Výrobní číslo / Sériové číslo / Серийный номер / シリアル番号 / 일련 번호 / 序列号 / 序列號

A) Audio Control Module (ACM)

B) Sound Card

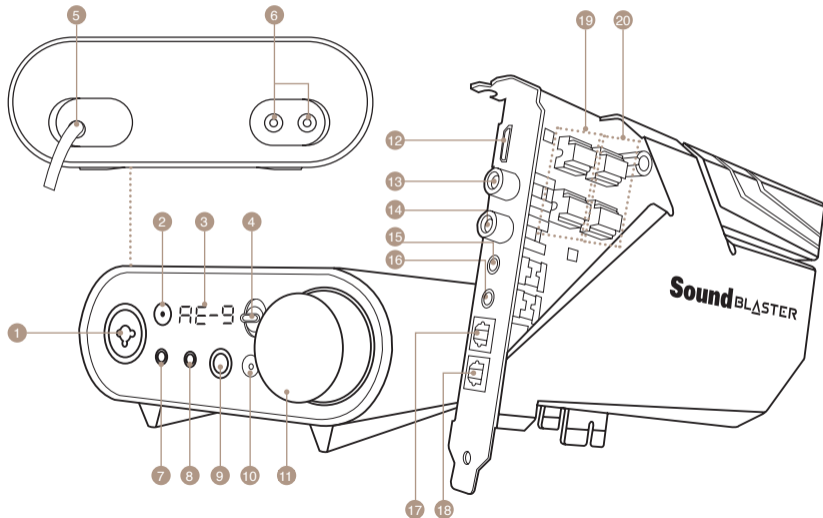

A) Audio Control Module (ACM)

1. XLR/6.3mm Microphone In
2. +48V Phantom Power Button
3. Volume/Status Display
4. Headphone Impedance Selector Switch
5. ACM Link Cable
6. AUX In (Left/Right)
7. 3.5mm Microphone In (Mono)
8. 3.5mm Headset/Headphone In
9. 6.3mm Headphone Jack
10. SBX Button
11. Volume Control Knob / Headphone / Speaker Switch

B) Sound Card

12. ACM Link Port
13. Front Left
14. Front Right
15. Rear
16. Center / Subwoofer
17. Optical Out
18. Optical In
19. Op-Amp Pair 1 (Single DIP)
20. Op-Amp Pair 2 (Dual DIP)

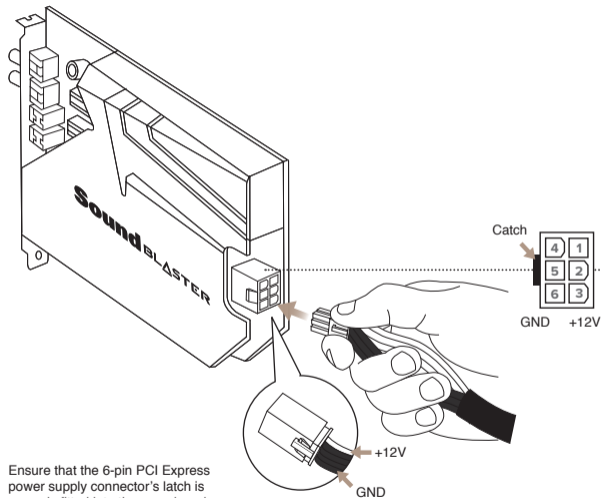

Ensure that the 6-pin PCI Express power supply connector's latch is properly fitted into the sound card connector's catch.

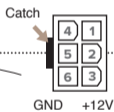

Sound Card Connector

Pin	Definition
1	+12 VDC
2	+12 VDC
3	+12 VDC
4	Ground (G)
5	Ground (G)
6	Ground (G)

PC Power Supply Unit ^

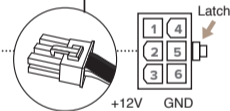
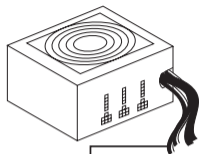

Power Supply PCI Express Connector

Pin	Definition
1	+12 VDC (Yellow)
2	+12 VDC (Yellow)
3	+12 VDC (Yellow)
4	Ground (G) (Black)
5	Ground (G) (Black)
6	Ground (G) (Black)

Note:

- Only the use of PCI Express 6-Pin Connector is permitted.
- The PCIe connector must be connected to the sound card in a Pin-to-Pin matching configuration.
- DO NOT forcefully link the connectors if they do not fit.
- DO NOT connect ATX 4Pin/P4/EPS Connectors to the Sound Card's PCI Express Connector. Doing so will cause damage to the Sound Card and / or PC / Power supply.

^ Power supply unit must be 80 PLUS Bronze certified with a minimum of 500 watts power output and a 2 x 6 PCIe connector.

Installing The Sound Card

A

- 1 Unplug the computer's power cable

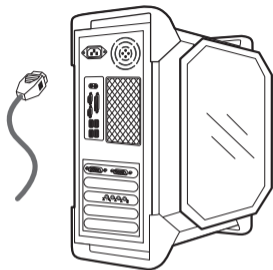

- 2 Remove the computer's case

B

- 1 Remove the existing sound card

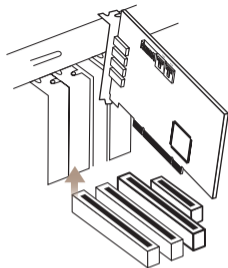

- 2 Remove the PCIe slot's metal enclosure

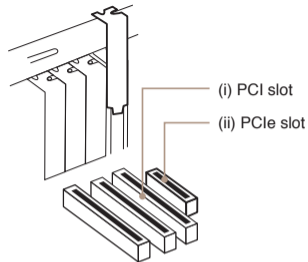

C

Gently but firmly slot the Sound Blaster AE-9 sound card into the PCIe slot

- 2 Plug the power cable back into the computer

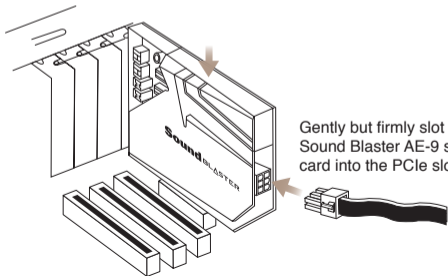

D

- 1 Replace the computer's case

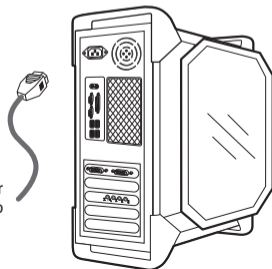

Connecting Devices To The Sound Card

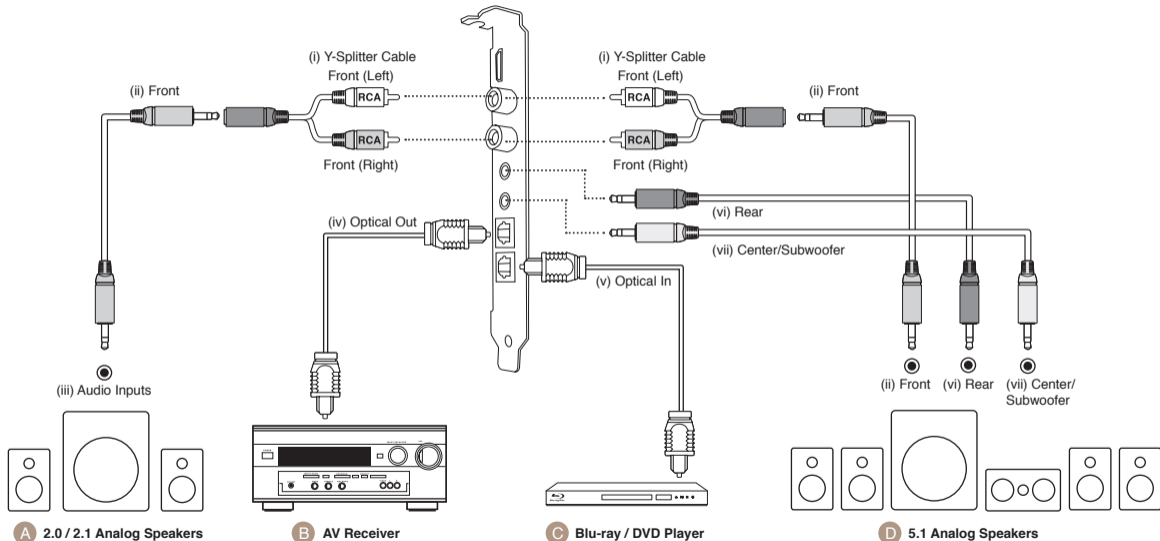

Connecting Devices to The Audio Controlle Module (ACM)

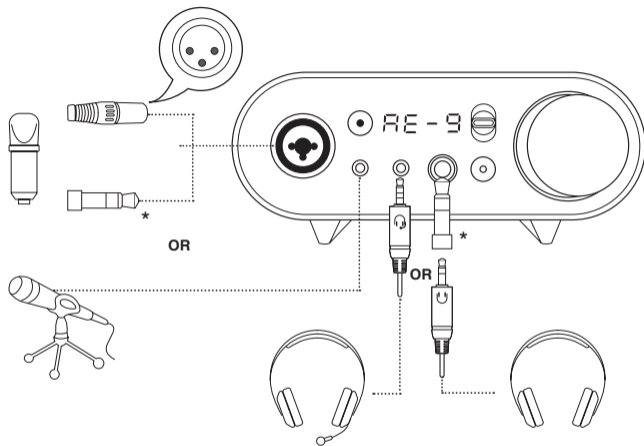

*1/8" to 1/4" adapter not included / Adaptateur de 1,8" à ¼" non inclus / Adapter von 1,8" bis ¼" nicht enthalten / adaptador 1.8" a ¼" no incluida / *1.8" to ¼" adapter ikke inkluderet / *1.8" > ¼" -adapteri ei tule mukana / *1.8" til ¼" adapter er ikke inkludert / *1.8" to ¼" adapter ej inkluderat / Adapter 1,8" do ¼" niedołączony do zestawu / Redukce z 1,8" na ¼" není součástí balení / Adaptér 1.8" na ¼" nie je súčasťou balenia / 3.5mm-6.3mm変換アダプターは含まれません / 1.8" to 1/4" 어댑터는 포함되어 있지 않습니다 / 不包含1/8"转¼"适配器 / Адаптер 1.8" к ¼" не включен

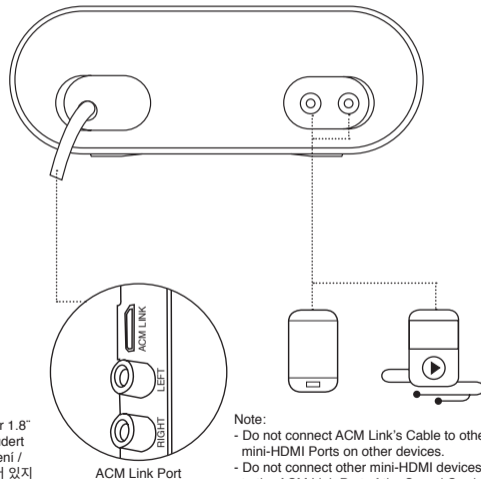

Note:

- Do not connect ACM Link's Cable to other mini-HDMI Ports on other devices.
- Do not connect other mini-HDMI devices to the ACM Link Port of the Sound Card.

Display & Control Interface

(A) +48V Button



ON: Enable +48V Phantom power to XLR mic



OFF: Disable +48V Phantom power to XLR mic

+48V Phantom power is available on XLR connector only.

(B) Volume Display

-90.0 dB Min.

0.0 dB Max.

(C) Headphone Impedance Selector Switch



IEM: 16 - 31Ω in-ear monitor

Normal(N): 32 - 149 Ω in-ear / headphones

High: 150 - 600 Ω headphones

(D) Volume Knob

Press and hold for 2 secs

Switch between the headphone and speaker output

-HP-

Headphone Mode

-SP-

Speaker Mode

Press and hold for 4 secs

Turn off volume LED

Turn on volume LED

(E) SBX Button



ON: SBX Acoustic Engine is switched ON



OFF: SBX Acoustic Engine is switched OFF

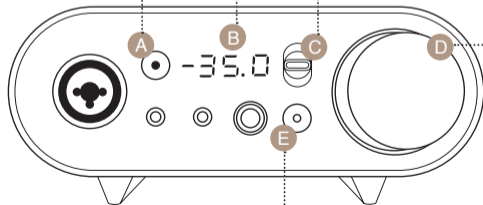

Download

Unlock your Sound Blaster AE-9 with the Sound Blaster Command software.
Download at creative.com/support/SBAE-9



With Sound Blaster Command, you can:

- Experience professionally-tuned audio presets for gaming, movies and music
- Personalize audio effects with Sound Blaster Acoustic Engine
- Setup speakers and headphones configuration
- Adjust playback and recording settings

Product Registration

Registering your product ensures you receive the most appropriate service and product support available. You can register your product during installation or at www.creative.com/register.

Please note that your warranty rights are not dependent on registration.

Technical & Customer Support Services

Visit creative.com/support/SBAE-9 to resolve and troubleshoot technical queries at Creative's 24-hour self-help Knowledge Base. You can also find customer support services and other helpful information here.

Other Information

Supplementary documentation for this product including DoC and safety and regulatory information can be downloaded from creative.com/support/SBAE-9.

Warranty

Warranty information is supplied with your product in a separate document.

Please keep your Proof of Purchase for the duration of the Warranty period.

Keep this document for future reference.