



Oben[®]

VH-A30

Tilt Head for Monopods



You're on steady ground[®]

Thank you for choosing Oben

The Oben VH-A30 Tilt Head is a sturdy, all-aluminum tilt head designed for monopods. It provides 180° vertical tilt for a camera and lens weighing up to 33 pounds, and its durable construction will stand up to the most demanding indoor and outdoor use. The head is equipped with Oben's Arca-style compatible QR-20 quick-release plate that's perfect for quickly mounting and swapping cameras. An integrated bubble level helps you align your camera with the horizon.

Overview	4-5
Operation	6-9
Mounting the Head to a Monopod	6
Mounting the Quick-Release Plate	6
Mounting the Camera/Lens	7
Tilt Lock Knob	8
Quick-Release Knob	8
Repositioning the Clamp	9
Specifications	10
Warnings	11

OVERVIEW

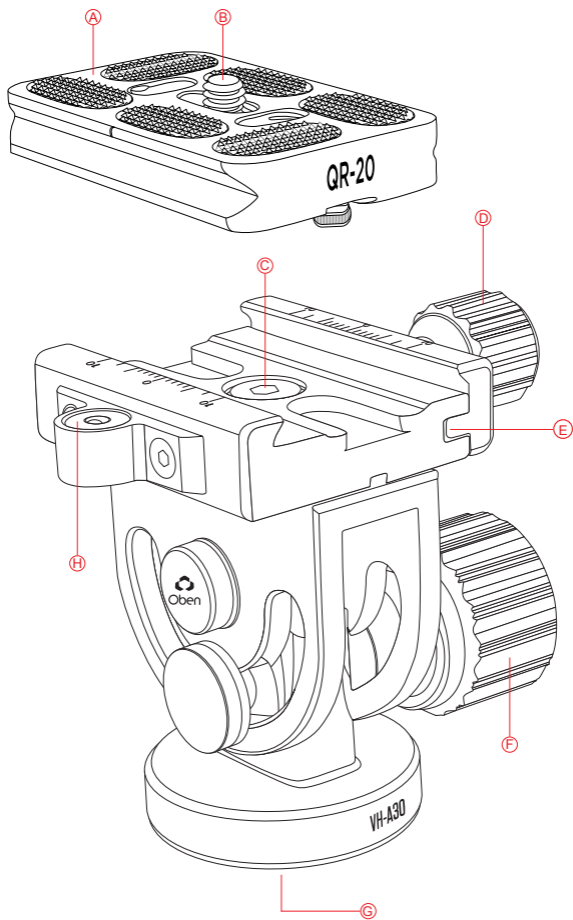

- Ⓐ Quick-release plate
- Ⓑ 1/4-20 mounting screw
- Ⓒ Clamp attachment screw
- Ⓓ Quick-release knob
- Ⓔ Quick-release clamp
- Ⓕ Tilt lock knob
- Ⓖ 3/8-16 mounting socket
- Ⓗ Bubble level

Mounting the Head to a Monopod

1. Screw the head onto your monopod.
2. Once attached, make sure the head's base is flush against the monopod's top mount.
3. If your monopod has a set screw, tighten it until secure.

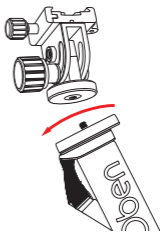

Mounting the Quick-Release Plate

The plate's 1/4-20 screw will fit most cameras and lenses.

1. Mount the quick-release plate to the threaded socket of your camera or lens base.
2. Tighten the screw with a coin or a hex key, and make sure the camera or lens base is flush against the plate.
3. Fold the thumbscrew flat against the bottom of the plate before mounting it into the clamp.



Mounting the Camera/Lens

1. Before mounting the camera or lens to the head, make sure the tilt lock knob is fully tightened.
2. Place the quick-release plate and camera/lens into the clamp.
3. Adjust the plate's position for optimum balance. Tighten the quick-release knob until secure.

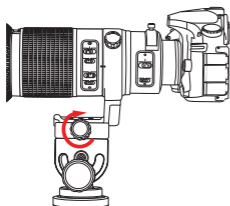

Tilt Lock Knob

1. Turn the tilt lock knob counterclockwise to unlock the head.
2. Position the angle of the head, and turn the knob clockwise to tighten it.

Important: Always use one hand to hold onto your camera while adjusting the head. Be sure the tilt lock is fully tightened before letting the camera go.

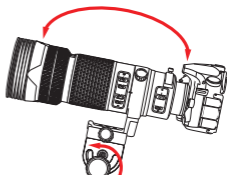

Quick-Release Knob

1. Turn the quick release knob counterclockwise to loosen the plate and reposition or rebalance your camera.
2. Continue to loosen the clamp to remove the plate from the clamp.
3. Turn the knob clockwise to lock the plate into position.

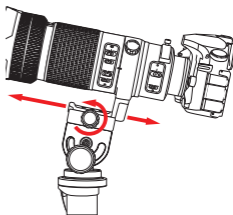

Repositioning the Clamp

For convenience, the clamp's position can be repositioned, so the quick-release knob and the tilt-lock knob are on opposite sides of the head.

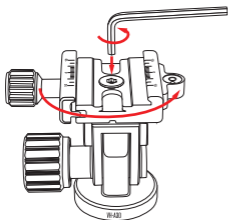

1. Remove the quick-release plate.
2. Use the hex key to remove the clamp attachment screw.

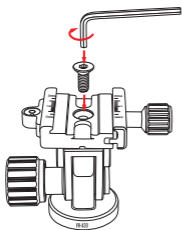

3. Reposition the clamp so the quick-release knob and the tilt-lock knob are on opposite sides of the head.
4. Replace the screw, and tighten it with the hex key until secure.

SPECIFICATIONS

Head Type	Tilt
Base Mount	3/8-16
Camera Mounting Screw	1/4-20
Quick-Release Plate	QR-20
Load Capacity	33 lb. (15 kg)
Number of Bubble Levels	1
Material	Aluminum
Vertical Tilt	+90° to -90°
Dimensions (H × W × D)	3.5 × 3.6 × 2.4 in. (8.9 × 9.1 × 6.1 cm)
Weight	12.4 oz. (351.5 g)



- *Do not exceed the head's maximum load capacity of 33 lb (15 kg).*
- *Ensure that all appropriate locks are engaged when necessary.*
- *The VH-A30 head should be used only in temperatures ranging between -4°F and 158°F (-20°C and 70°C).*
- *Do not operate in salt water. Dry the head if it becomes wet.*
- *Remove the camera from the head during setup or transport.*
- *Avoid long-term exposure to sunlight.*
- *Keep out of reach of children.*
- *All images are for illustrative purposes only.*

Visit our website at **[ObenSupports.com](https://www.ObenSupports.com)**
for more Oben products.



Oben is a registered trademark of the Gradus Group.
© 2020 Gradus Group LLC. All Rights Reserved.