



raya[®]

CS-CSX3

3 IN. LOCKING CASTERS

FOR C-STANDS

(SET OF 3)

USER MANUAL

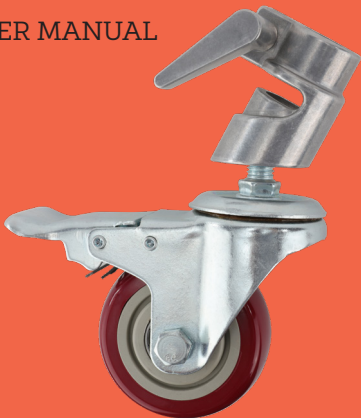

PRECAUTIONS

- Please read and follow these instructions, and keep this manual in a safe place.
- Make sure everything is secure before proceeding.
- Make sure this product is intact and that there are no missing parts.
- All images are for illustrative purposes only.

SPECIFICATIONS

Connector Size	24–25 mm
Wheel Diameter	3 in. (7.6 cm)
Locking Wheels	Yes
Material	Metal ABS plastic
Weight (set of 3)	4.7 lb. (2.13 kg)

ATTACHMENT INSTRUCTIONS

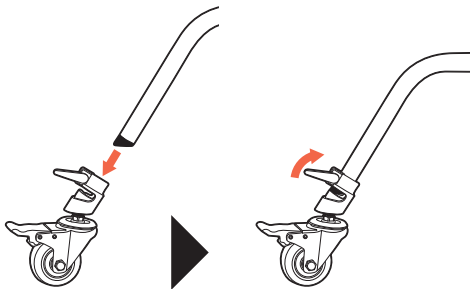

1. Align the angle of the receiver with the C-stand leg. Make sure the split in the casting faces the outside of the leg.
2. Fit the castor onto the leg, and tighten the locking knob until secure.

LOCKING AND UNLOCKING

THE WHEELS

To lock

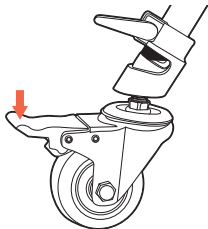

To unlock

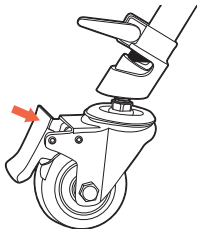

ONE-YEAR LIMITED WARRANTY

This Raya product is warranted to the original purchaser to be free from defects in materials and workmanship under normal consumer use for a period of one (1) year from the original purchase date or thirty (30) days after replacement, whichever occurs later. The warranty provider's responsibility with respect to this limited warranty shall be limited solely to repair or replacement, at the provider's discretion, of any product that fails during normal use of this product in its intended manner and in its intended environment. Inoperability of the product or part(s) shall be determined by the warranty provider. If the product has been discontinued, the warranty provider reserves the right to replace it with a model of equivalent quality and function.

This warranty does not cover damage or defect caused by misuse, neglect, accident, alteration, abuse, improper installation or maintenance. EXCEPT AS PROVIDED HEREIN, THE WARRANTY PROVIDER MAKES NEITHER ANY EXPRESS WARRANTIES NOR ANY IMPLIED WARRANTIES, INCLUDING BUT NOT LIMITED TO ANY IMPLIED WARRANTY OF MERCHANTABILITY OR FITNESS FOR A PARTICULAR PURPOSE. This warranty provides you with specific legal rights, and you may also have additional rights that vary from state to state.

To obtain warranty coverage, contact the Raya Customer Service Department to obtain a return merchandise authorization ("RMA") number, and return the defective product to Raya along with the RMA number and proof of purchase. Shipment of the defective product is at the purchaser's own risk and expense.

For more information or to arrange service, visit www.rayalighting.com or call Customer Service at 212-594-2353.

Product warranty provided by the Gradus Group.

www.gradusgroup.com

Raya is a registered trademark of the Gradus Group.

© 2022 Gradus Group LLC. All Rights Reserved.



