

USB-EC-2 GIGABIT

USB-C TO ETHERNET ADAPTER

User Manual



Thank you for choosing Xcellon.

The Xcellon USB to Ethernet adapter adds a wired Ethernet connection to a USB port on your computer or mobile device. It provides secure and reliable internet access with Ethernet speeds up to 1000 Mbps.

This bus-powered adapter requires no external power source and offers plug-and-play use with your computer and mobile electronics. Download large files, livestream, and conduct important video calls with a connection that's faster and more reliable than Wi-Fi.

Precautions

- » Please read and follow the instructions in this manual for proper use of this device.
- » Keep this product away from water and flammable gases or liquids.
- » Use a soft, slightly moistened cloth when cleaning. Do not use solvents or abrasive substances.
- » This product has no serviceable parts.
- » Do not open this device for maintenance.
- » All images are for illustrative purposes only.

Overview

Front

- 1 USB-C™ connector

Bottom

- 2 Ethernet connector (RJ45)

LED Indicators

- 3 Connection: Green
- 4 Power: White
- 5 Activity: Yellow (flashing)

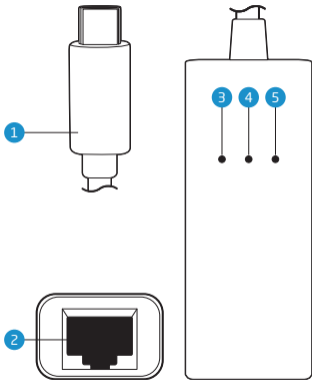

Specifications

Port	Gigabit Ethernet (RJ45)
PC Connection	USB-C
Construction	Aluminum
System Requirements	MacOS / Windows 7 or later / Linux / iPadOS / Chrome OS / Android
USB Compatibility	4, 3.2, 3.1, 3.0, 2.0, 1.1
Speed	USB: USB 3.2 5 Gbps / Ethernet: 10/100/1000 Mbps
Supported Ethernet Standards	IEEE 802.3, 802.3u, 802.3x, 802.3ab, 802.3az, 802.1Q VLAN, 802.1P
Cable Length	5.9 in. (15 cm)
Dimensions (D × W × H)	2.38 × 0.94 × 0.65 in. (6.05 × 2.4 × 1.65 cm)
Weight	0.88 oz. (25 g)

One-Year Limited Warranty

This Xcellon product is warranted to the original purchaser to be free from defects in materials and workmanship under normal consumer use for a period of one (1) year from the original purchase date or thirty (30) days after replacement, whichever occurs later. The warranty provider's responsibility with respect to this limited warranty shall be limited solely to repair or replacement, at the provider's discretion, of any product that fails during normal use of this product in its intended manner and in its intended environment. Inoperability of the product or part(s) shall be determined by the warranty provider. If the product has been discontinued, the warranty provider reserves the right to replace it with a model of equivalent quality and function.

This warranty does not cover damage or defect caused by misuse, neglect, accident, alteration, abuse, improper installation or maintenance. EXCEPT AS PROVIDED HEREIN, THE WARRANTY PROVIDER MAKES NEITHER ANY EXPRESS WARRANTIES NOR ANY IMPLIED WARRANTIES, INCLUDING BUT NOT LIMITED TO ANY IMPLIED WARRANTY OF MERCHANTABILITY OR FITNESS FOR A PARTICULAR PURPOSE. This warranty provides you with specific legal rights, and you may also have additional rights that vary from state to state.

To obtain warranty coverage, contact the Xcellon Customer Service Department to obtain a return merchandise authorization ("RMA") number, and return the defective product to Xcellon along with the RMA number and proof of purchase. Shipment of the defective product is at the purchaser's own risk and expense.

For more information or to arrange service, visit www.xcellongear.com or call Customer Service at 212-594-2353.

Product warranty provided by the Gradus Group.

www.gradusgroup.com

Xcellon is a registered trademark of the Gradus Group.

© 2023 Gradus Group LLC. All Rights Reserved.

